

Dexter DDAD30 (10/2008) Rear View

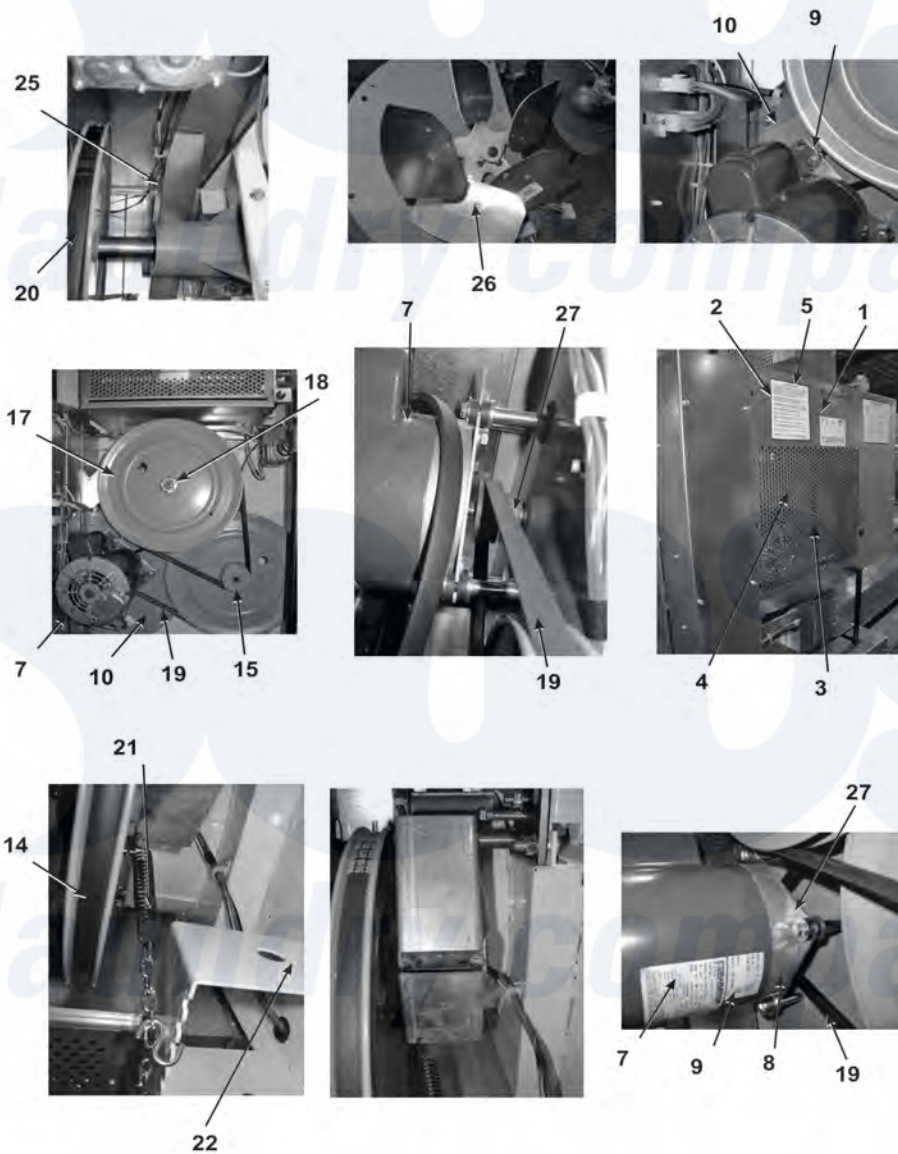

[Dexter Commercial Dexter DDAD30 \(10/2008\) Dryer Parts](#) Parts Diagram Rear View

[Click on the part number to view part](#)

Item	Original Part Number	Replaced By	Status	Part Description
*	9627-861-001			Wire Harness Overtemperature Switch
"	9801-095-001	9801-095-001P		Airflow Assy.
1	9539-461-009			Switch, Air Flow
2	9029-174-001			Bracket, Switch- Air Flow
3	9008-007-001			Actuator, Switch
4	9451-169-002			Pin, Cotter
5	9545-020-001			Screw, Switch Mtg
*	8640-401-001			Nut, Special Twin
"	9550-169-003			Shield, Switch
"	9545-008-001			Screw 10-32 x 1/4
7	9376-309-003			Motor, Drive

8	9452-740-001		Plate, Motor Mtg
*	9545-029-008		Bolt 3/8" - 16 x 3/4"
"	8641-582-003		Lockwasher
9	9545-018-019		Screw, Motor Plate to Hsg Back
"	8641-582-007		Lockwasher 1/4"
"	9538-163-006		Spacer
"	8641-581-017		Flat Washer
"	9209-086-002		Rubber Grommet
*	9538-166-006		Grommet Spacers
27	9453-157-001		Pulley, Motor
*	9545-028-013		Screw, Set
10	9962-017-002	9962-017-002P	Blower Back
26	9278-039-001		Impeller, W/Set Screws
11	9991-053-001		Support Assy, Intermed Pulley
12	9545-029-010		Bolt, Rd Hd 3/8-16 x 1 1/4"
13	9545-029-003		Bolt, 3/8-16 x 1 1/2"
12	8640-415-004		Nut
"	8641-581-035		Washer, Flat
14	9861-022-001		Arm Assy-Tension, Complete
*	8641-581-035		Washer, Flat
15	9487-200-003		Ring-Retaining
16	9908-039-004		Pulley Assy, Intermediate
*	9036-145-002		Bearing Assy (included in above)
17	9908-040-001		Pulley Driven
*	9538-164-001		Spacer, Shaft
"	9306-006-000		Key, Tumbler Shaft
18	8640-222-000		Nut, Hex
"	86A1-582-015	Not Available	Washer, Lock
19	9040-077-001		Belt, Drive- Motor
20	9040-073-009		Belt, Drive- Tumbler
21	9534-319-002		Spring, Tension
22	9099-012-002		Chain, Tension
23	9248-022-002		Hook, Tension
*	9125-005-001	Not Available	Damper Inside Duct Exhaust
24	9451-146-001		Pin, Damper
*	8520-141-000		Nut, Spring
"	9545-008-026		Screw, Vault Mtg
25	9825-059-001		Cover Duct Upper
*	9074-314-001		Cover Duct Lower
"	9545-008-024		Screw HX Head Tapping (Mounts bracket housing to dryer)
25	9973-030-001	Not Available	Heat Recirculation Assembly Duct
27	9453-157-001		Pulley, Motor
*	9029-173-001		Bracket for Wire Harness Under Burner Housing