

Dexter DDAD50KC Rear View

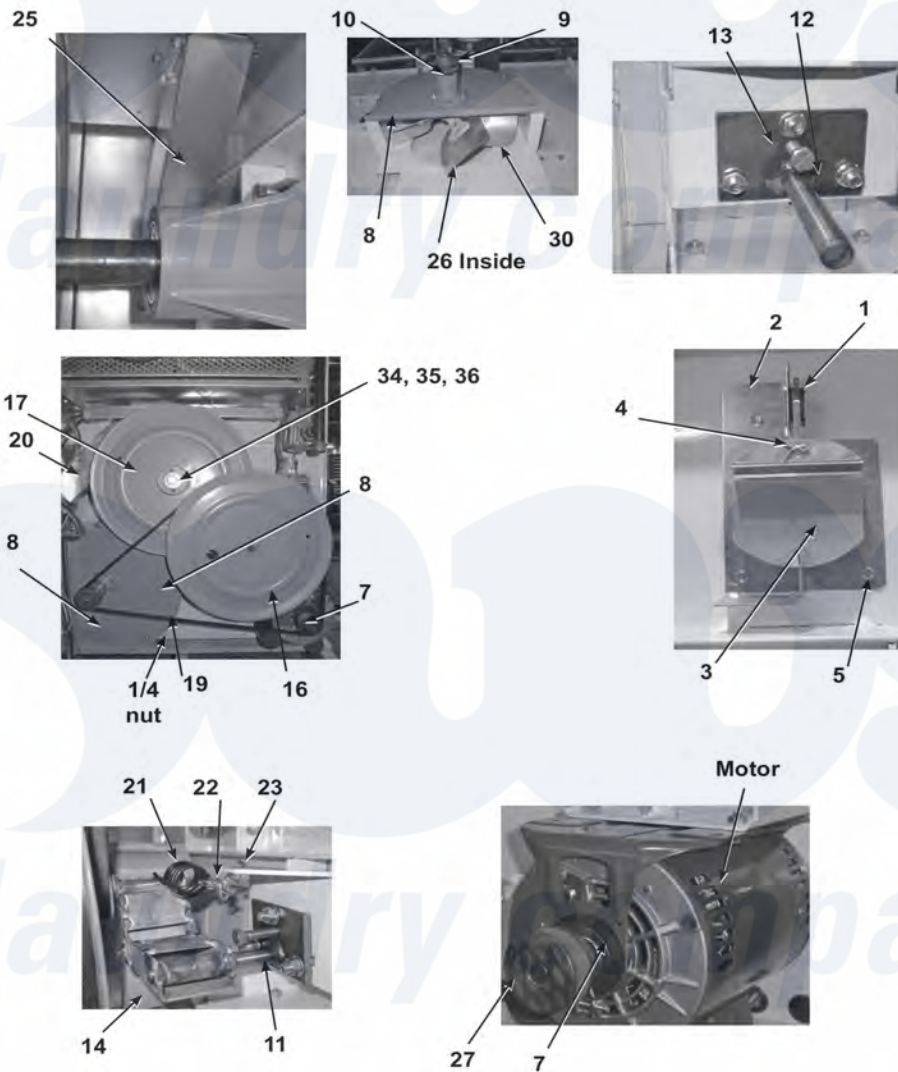

Dexter Commercial Dexter DDAD50KC Dryer Parts Parts Diagram Rear View

Click on the part number to view part

Item	Original Part Number	Replaced By	Status	Part Description
*	9627-875-001		Not Available	Wire Harness Overtemperature Switch/Air Switch
"	9801-095-001	9801-095-001P		Airflow Assy.
1	9539-461-009			Switch, Air Flow
2	9029-174-001			Bracket, Switch- Air Flow
3	9008-007-001			Actuator, Switch
4	9451-169-002			Pin, Cotter
5	9545-020-001			Screw, Switch Mtg
7	9376-313-001			Motor, Drive
8	9962-745-002		Not Available	Plate, Impeller Mtg
9	9537-204-001	9803-214-001		Fan Hsg. w/shaft
10	9803-204-001	9803-214-001		Fan Hsg. w/shaft

"	9453-157-001		Pulley, Motor
11	9991-053-001		Support Assy, Intermed Pulley
12	9545-029-010		Bolt, Rd Hd 3/8-16 x 1 1/4
"	8640-415-004		Nut
"	8641-581-035		Washer, Flat
13	9545-029-003		Bolt, 3/8-16 x 1 1/2
14	9861-022-001		Arm Assy-Tension, Complete
*	9487-200-003		Ring-Retaining
16	9908-046-003		Pulley Assy, Intermediate with bronze β ange bearing
17	9908-040-003		Pulley Driven Tumbler
19	9040-076-004		Belt, Drive Motor
20	9040-073-010		Belt, Driven Intermediate to Tumbler
21	9534-151-000		Spring, Belt Tension
22	9099-012-005	Not Available	Chain, Tension
23	9248-022-002		Hook, Tension
*	9451-146-001		Pin, Damper
"	9825-322-001	Not Available	Cover Duct Upper
25	9973-030-001	Not Available	Heat Recirculation Assembly Duct
26	9919-018-011	Not Available	Impeller Assembly Complete w/ Bearings, Shaft, Plate
27	9453-157-001		Pulley, Motor
28	9545-028-013		Screw, Set
29	9241-191-002	Not Available	Bearing Housing Only Impeller
30	9278-038-004		Impeller, w/set screws
*	9036-159-010		Ball Bearing for Above Impeller Shaft
"	9487-200-007		Ring-Retaining External for Impeller Bearing Housing
"	9545-018-009	Not Available	Screw, 1/4-20 x 1 Impeller Bearing Housing
34	8641-581-026		Washer, Flat
35	9545-017-009		Screw, Hx Cap
36	8641-582-016		Lockwasher
*	8641-401-001	Not Available	Nut, Special Twin #4-40
"	9550-169-003		Shield, Switch
"	9545-008-001		Screw 10-32 x 1/4
"	9545-014-004		Bolt, Motor Mtg
"	8640-400-003		Nut, Hex
"	9036-145-002		Bearing Assy (included in above)
"	9538-164-001		Spacer, Shaft
"	9487-234-005		Ring Tolerance
"	9125-006-001		Damper Inside Duct Exhaust
"	8520-141-000		Nut, Spring
"	9545-008-026		Screw, Vault Mtg
"	9074-323-001		Cover Duct Lower
"	9545-008-024		Screw HX Head Tapping (Mounts bracket housing to dryer)
"	9029-173-001		Bracket for Wire Harness Under Burner Housing

WWS
the laundry company[®]

WWS
the laundry company[®]

WWS
the laundry company[®]