

Dexter DDBD50 (Spring 2011) Rear View

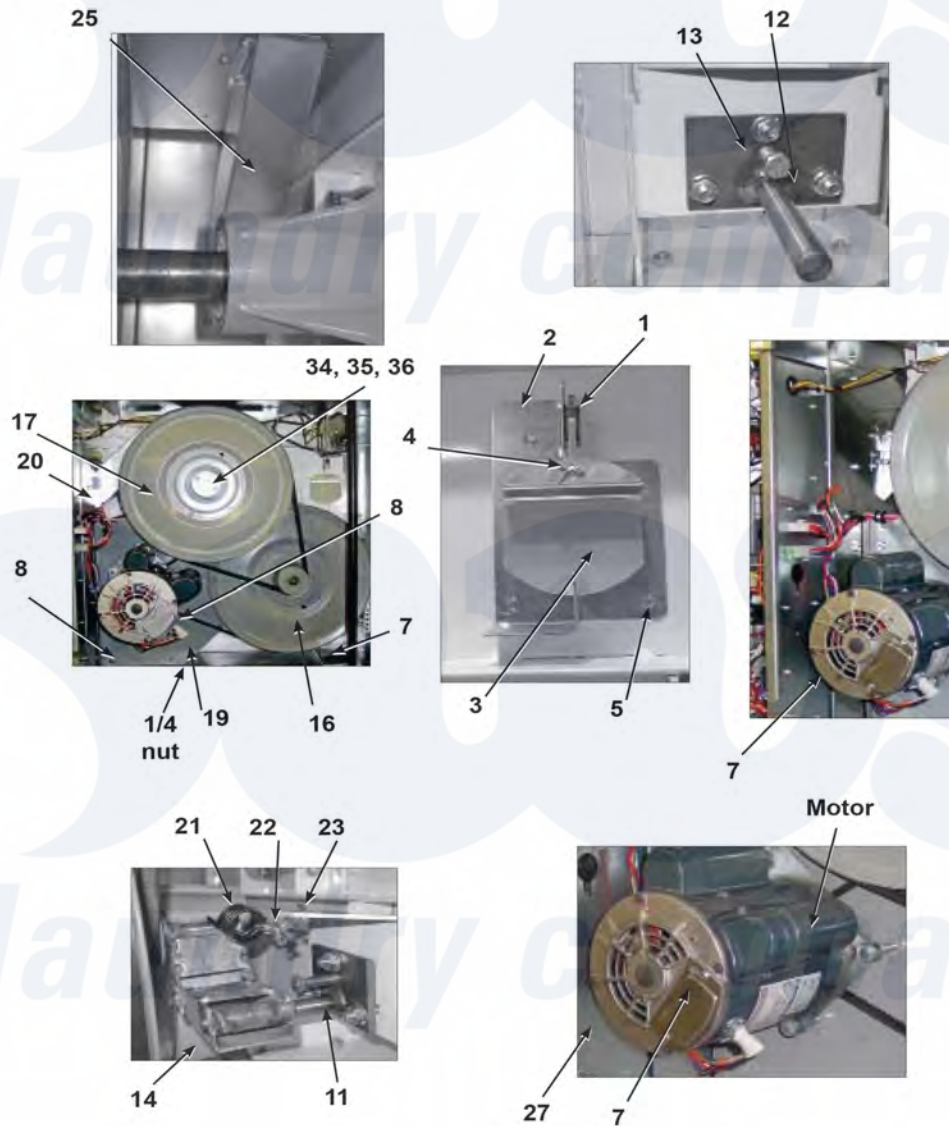

Dexter Commercial Dexter DDBD50 (Spring 2011) Dryer Parts Parts Diagram Rear View
 Click on the part number to view part

Item	Original Part Number	Replaced By	Status	Part Description
*	9627-861-001			Wire Harness Overtemperature Switch
"	9801-098-001			Switch Assy, Air Flow
1	9539-461-009			Switch, Air Flow
2	9029-200-001		Not Available	Bracket, Switch- Air Flow
3	9008-007-001			Actuator, Switch
4	9451-169-002			Pin, Cotter
5	9545-020-001			Screw, Switch Mtg
*	8640-401-001			Nut, Special Twin
"	9550-169-003			Shield, Switch
7	9376-322-001			Motor, Drive
*	9452-770-001		Not Available	Plate, Motor Mounting

8	9962-018-002		Plate, Impeller Mtg
11	9991-053-001		Support Assy, Intermed Pulley
12	9545-029-010		Bolt, Rd Hd 3/8-16 x 1 1/4
"	8640-415-004		Nut
"	8641-581-035		Washer, Flat
13	9545-029-003		Bolt, 3/8-16 x 1 1/2
14	9861-022-001		Arm Assy-Tension, Complete
*	9487-200-003		Ring-Retaining
16	9908-048-003		Pulley Assy, Intermediate with bronze flange bearing
*	9036-145-002		Bearing Assy (included in above)
17	9908-047-002		Pulley Driven Tumbler
19	9040-076-009		Belt, Drive Motor
20	9040-073-011		Belt, Driven Intermediate to Tumbler
21	9534-151-000		Spring, Belt Tension
22	9099-012-005	Not Available	Chain, Tension
23	9248-022-002		Hook, Tension
*	9451-146-001		Pin, Damper
"	9074-334-001	Not Available	Cover Duct Upper
25	9973-032-001	Not Available	Heat Recirculation Assembly Duct
27	9453-169-013	Not Available	Motor Pulley - Driver
28	9545-028-013		Screw, Set
30	9278-038-004		Impeller, w/set screws
34	8641-581-026		Washer, Flat
35	9545-017-009		Screw, Hx Cap
36	8641-582-016		Lockwasher
*	9545-008-001		Screw 10-32 x 1/4
"	9545-014-004		Bolt, Motor Mtg
"	8640-400-003		Nut, Hex
"	9538-184-001		Spacer, Shaft
"	9487-234-005		Ring Tolerance
"	9125-007-001		Damper Inside Duct Exhaust
"	9125-007-002		Damper Inside Duct Exhaust
"	8520-141-000		Nut, Spring
"	9074-335-001		Cover Duct Lower
"	9545-008-024		Screw HX Head Tapping (Mounts bracket housing to dryer)
"	9029-173-001		Bracket for Wire Harness Under Burner Housing