

Dexter DDBD50KC Rear View

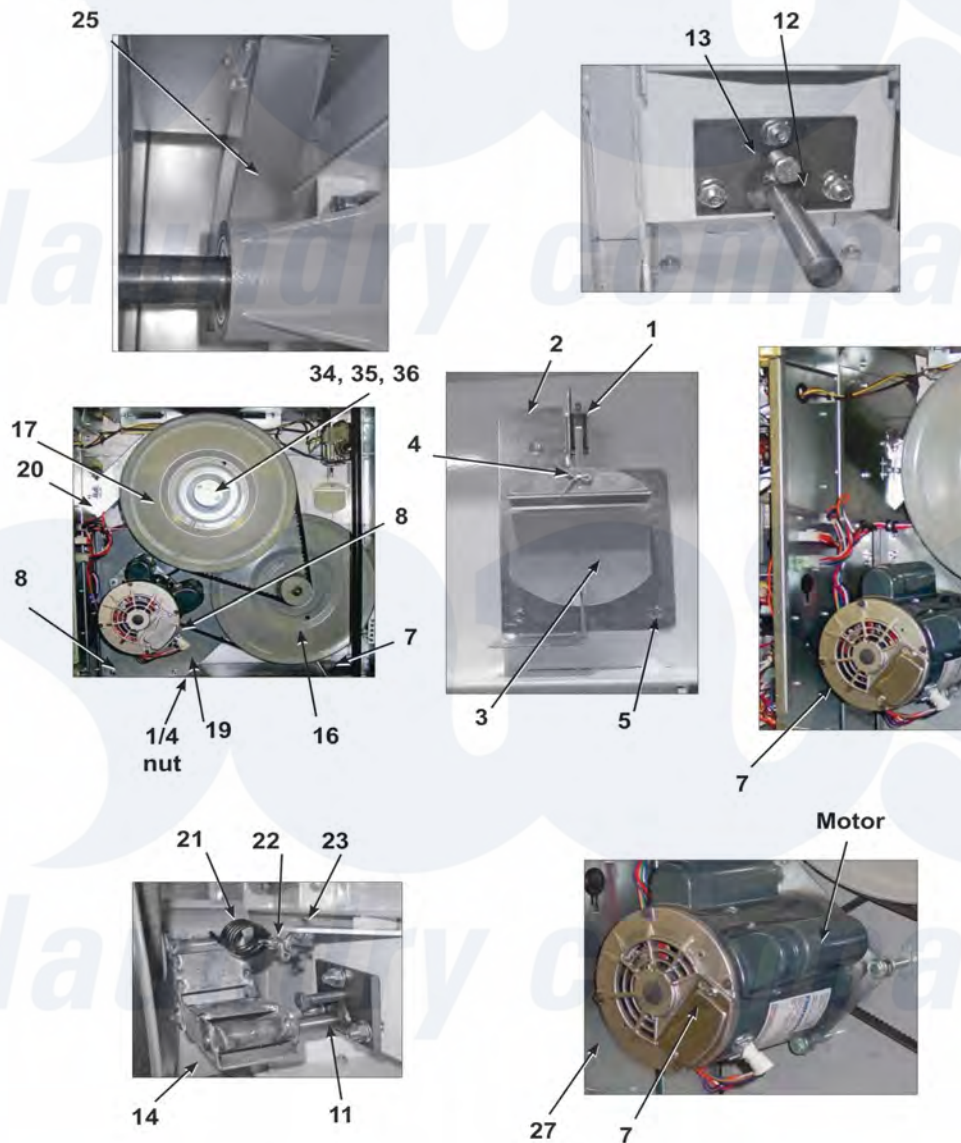

Dexter [Commercial Dexter DDBD50KC Dryer Parts](#) Parts Diagram Rear View

[Click on the part number to view part](#)

Item	Original Part Number	Replaced By	Status	Part Description
*	9627-861-001			Wire Harness Overtemperature Switch
"	9801-098-001			Switch Assy, Air Flow
1	9539-461-009			Switch, Air Flow
2	9029-200-001		Not Available	Bracket, Switch- Air Flow
3	9008-007-001			Actuator, Switch
4	9451-169-002			Pin, Cotter
5	9545-020-001			Screw, Switch Mtg
*	8640-401-001			Nut, Special Twin
"	9550-169-003			Shield, Switch
7	9376-322-001			Motor, Drive
*	9452-770-001		Not Available	Plate, Motor Mounting

8	9962-018-002		Plate, Impeller Mtg
11	9991-053-001		Support Assy, Intermed Pulley
12	9545-029-010		Bolt, Rd Hd 3/8-16 x 1 1/4
"	8640-415-004		Nut
"	8641-581-035		Washer, Flat
13	9545-029-003		Bolt, 3/8-16 x 1 1/2
14	9861-022-001		Arm Assy-Tension, Complete
*	9487-200-003		Ring-Retaining
16	9908-048-003		Pulley Assy, Intermediate with bronze flange bearing
*	9036-145-002		Bearing Assy (included in above)
17	9908-047-002		Pulley Driven Tumbler
19	9040-076-009		Belt, Drive Motor
20	9040-073-011		Belt, Driven Intermediate to Tumbler
21	9534-151-000		Spring, Belt Tension
22	9099-012-005	Not Available	Chain, Tension
23	9248-022-002		Hook, Tension
*	9451-146-001		Pin, Damper
"	9074-334-001	Not Available	Cover Duct Upper
25	9973-032-001	Not Available	Heat Recirculation Assembly Duct
27	9453-169-013	Not Available	Motor Pulley - Driver
28	9545-028-013		Screw, Set
30	9278-038-004		Impeller, w/set screws
34	8641-581-026		Washer, Flat
35	9545-017-009		Screw, Hx Cap
36	8641-582-016		Lockwasher
*	9545-008-001		Screw 10-32 x 1/4
"	9545-014-004		Bolt, Motor Mtg
"	8640-400-003		Nut, Hex
"	9538-184-001		Spacer, Shaft
"	9487-234-005		Ring Tolerance
"	9125-007-001		Damper Inside Duct Exhaust
"	9125-007-002		Damper Inside Duct Exhaust
"	8520-141-000		Nut, Spring
"	9074-335-001		Cover Duct Lower
"	9545-008-024		Screw HX Head Tapping (Mounts bracket housing to dryer)
"	9029-173-001		Bracket for Wire Harness Under Burner Housing