

# Dexter SWD Loading Door Hinge

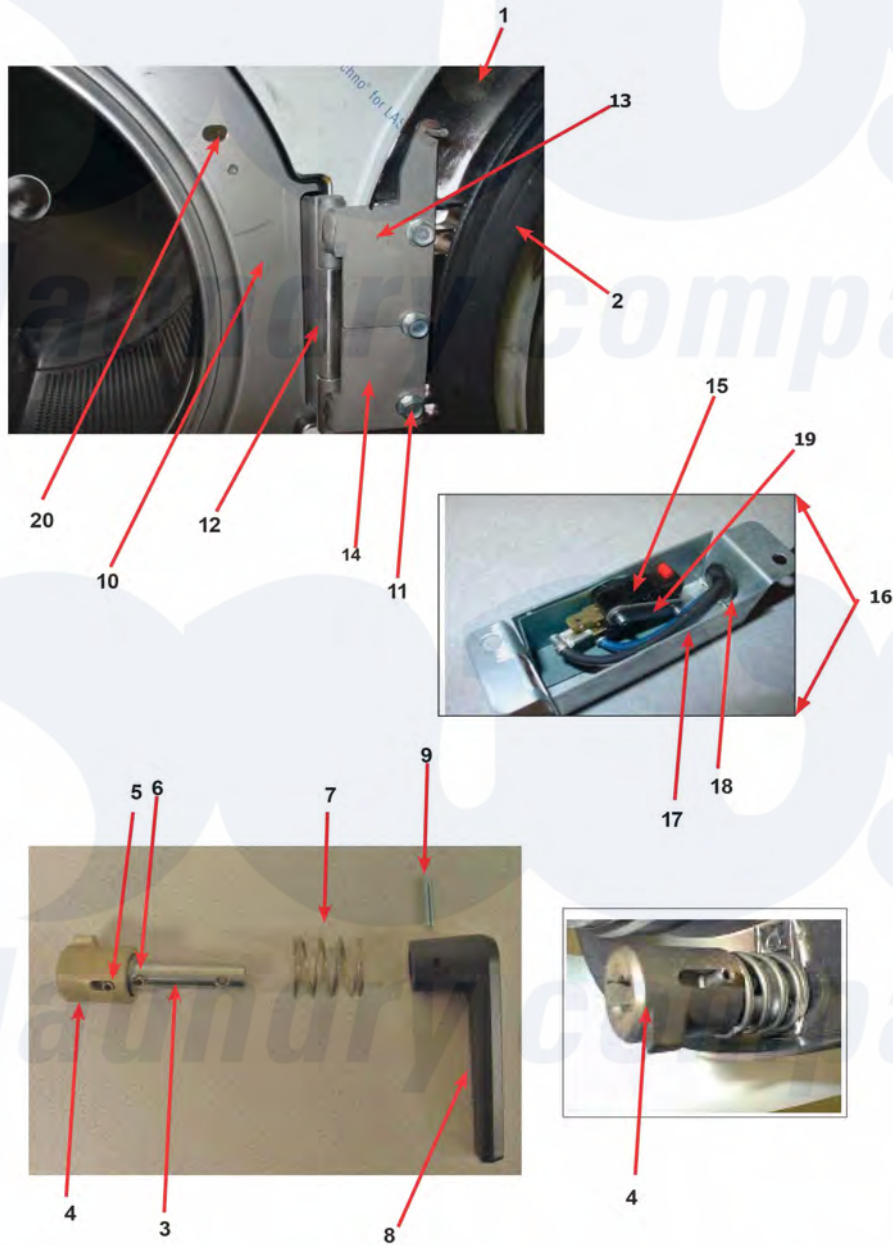

Dexter Commercial Dexter SWD Stacked Washer and Dryer Parts Parts Diagram Loading Door Hinge  
 Click on the part number to view part

Item	Original Part Number	Replaced By	Status	Part Description
*	9960-274-004	<a href="#">9960-274-004P</a>		Door Assy. 180
1	<a href="#">9487-265-002</a>			Loading Door, Ring
2	<a href="#">9206-419-001</a>			Gasket, Loading Door
*	<a href="#">9635-016-001</a>			Window, Loading Door
"	9913-134-003	<a href="#">9913-134-003P</a>		Shaft assy.
3	<a href="#">9537-195-002</a>			Shaft, Door Locking
4	<a href="#">9095-040-002</a>			Cam, Locking
5	<a href="#">9451-181-005</a>			Pin, Groove (1 1/4)
6	<a href="#">9451-181-004</a>			Pin, Dowel
7	<a href="#">9534-360-002</a>			Spring, Lock Cam
8	<a href="#">9244-080-003</a>			Handle, Door

9	<a href="#">9451-181-006</a>		Pin, Door Handle (groove)
12	9950-030-001	Not Available	Door Hinge (mounts to tub)
*	<a href="#">9545-014-009</a>		Screw, Hinge Mtg 5/16" x 3/4"
"	<a href="#">8641-582-009</a>		Lockwasher, Circuit Board
13	<a href="#">9845-005-003</a>		Top, Loading Door Leaf Hinge.with pin
14	<a href="#">9845-005-002</a>		Bottom, Loading Door Leaf Hinge
10	9950-060-002	Not Available	Masking Assembly
16	<a href="#">9801-089-001</a>		Switch Assembly Complete Door Closure
17	9041-087-001	Not Available	Switch Box
18	<a href="#">9053-067-003</a>		Bushing Insulating
15	<a href="#">9539-461-007</a>		Switch-Micro
*	<a href="#">9550-159-001</a>		Shield, Door Switch
19	<a href="#">8640-401-001</a>		Nut, Special Twin
*	<a href="#">9545-020-001</a>		Screw, Switch Mtg
"	<a href="#">8220-062-027</a>		Wires Red
"	<a href="#">8220-062-028</a>		Wires Black
20	<a href="#">9008-004-001</a>		Actuator, Switch- Lower