

Dexter SWD WSAD Loading Door Group

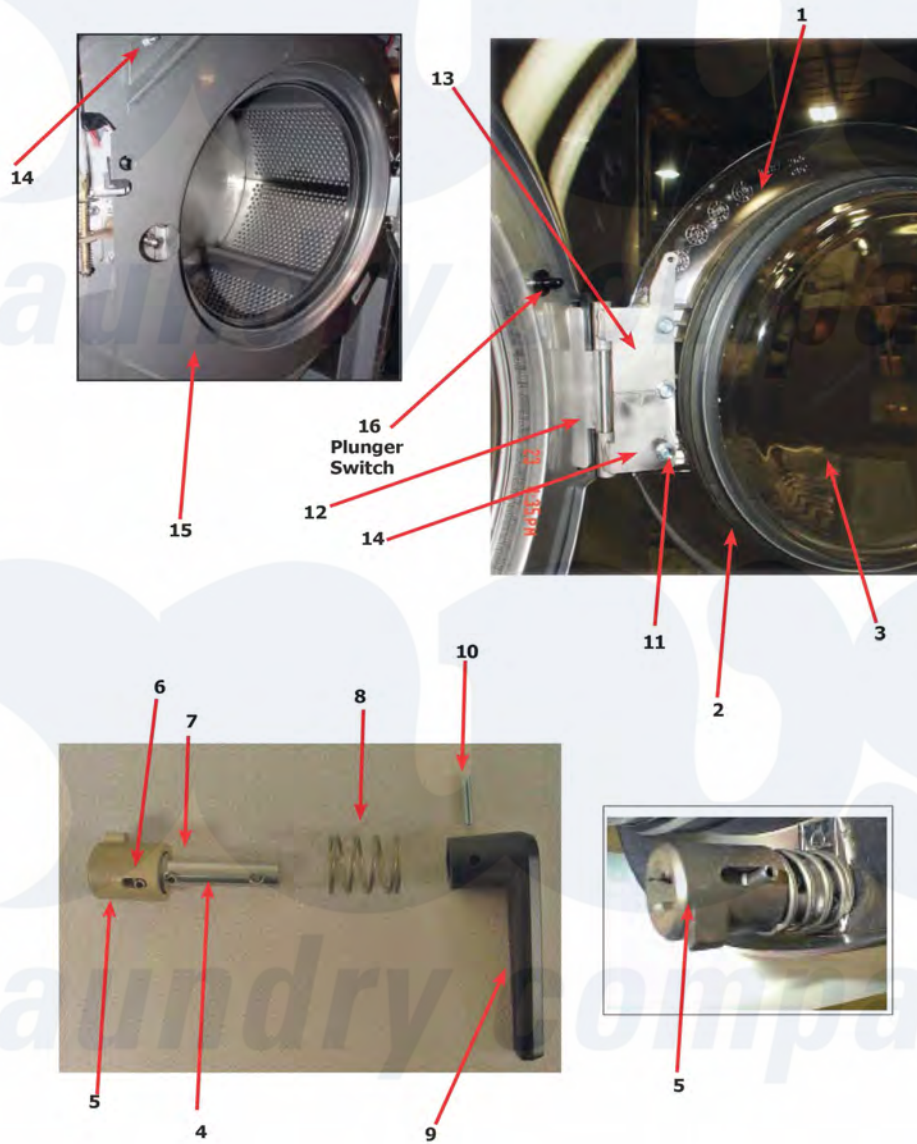

Dexter [Commercial Dexter SWD Stacked Washer and Dryer Parts](#) Parts Diagram WSAD Loading Door Group
 Click on the part number to view part

Item	Original Part Number	Replaced By	Status	Part Description
"	9960-274-004	9960-274-004P		Door Assy. 180
1	9487-265-002			Loading Door, Ring
2	9206-419-001			Gasket, Loading Door
3	9635-016-001			Window, Loading Door
*	9913-134-003	9913-134-003P		Shaft assy.
4	9537-195-002			Shaft, Door Locking
5	9095-040-002			Cam, Locking
6	9451-181-005			Pin, Groove (1 1/4)
7	9451-181-004			Pin, Dowel
8	9534-360-002			Spring, Lock Cam
9	9244-080-003			Handle, Door

10	9451-181-006		Pin, Door Handle (groove)
11	9545-056-002		Screw, Loading Door Mtg.
*	9552-037-001		Shim, Door Lock, Thin
12	9550-030-001	Not Available	Door Hinge Assembly Mounts to Tub Front
*	9545-014-009		Screw, Hinge Mtg 5/16" x 3/4"
"	8641-582-009		Lockwasher, Circuit Board
"	9627-816-002		Wiring Harness, Door Lock P15/P4
"	8220-063-025		Wire Assembly Door Close Switch, Red 17"
"	8220-063-026		Wire Assembly Door Close Switch, BLK 17"
13	9545-005-004	Not Available	Leaf assembly, Hinge Top (Push Button Style)
14	9545-005-002	Not Available	Leaf assembly, Hinge Bottom
15	9487-273-002	Not Available	Masking Ring (push Button SwitchStyle)
16	9539-492-001		Switch, Door closed Switch (Push Button style)
*	9950-060-002	Not Available	Masking Assembly
"	9845-005-003		Top, Loading Door Leaf Hinge.with pin
"	9801-089-001		Switch Assembly Complete Door Closure
"	9041-087-001	Not Available	Switch Box
"	9053-067-003		Bushing Insulating
"	9539-461-007		Switch-Micro
"	9550-159-001		Shield, Door Switch
"	8640-401-001		Nut, Special Twin
"	9545-020-001		Screw, Switch Mtg
"	8220-062-028		Wires Black
"	8220-062-027		Wires Red
"	9008-004-001		Actuator, Switch- Lower

the laundry company[®]