

Dexter SWD WSAD Rear View Access Parts Group

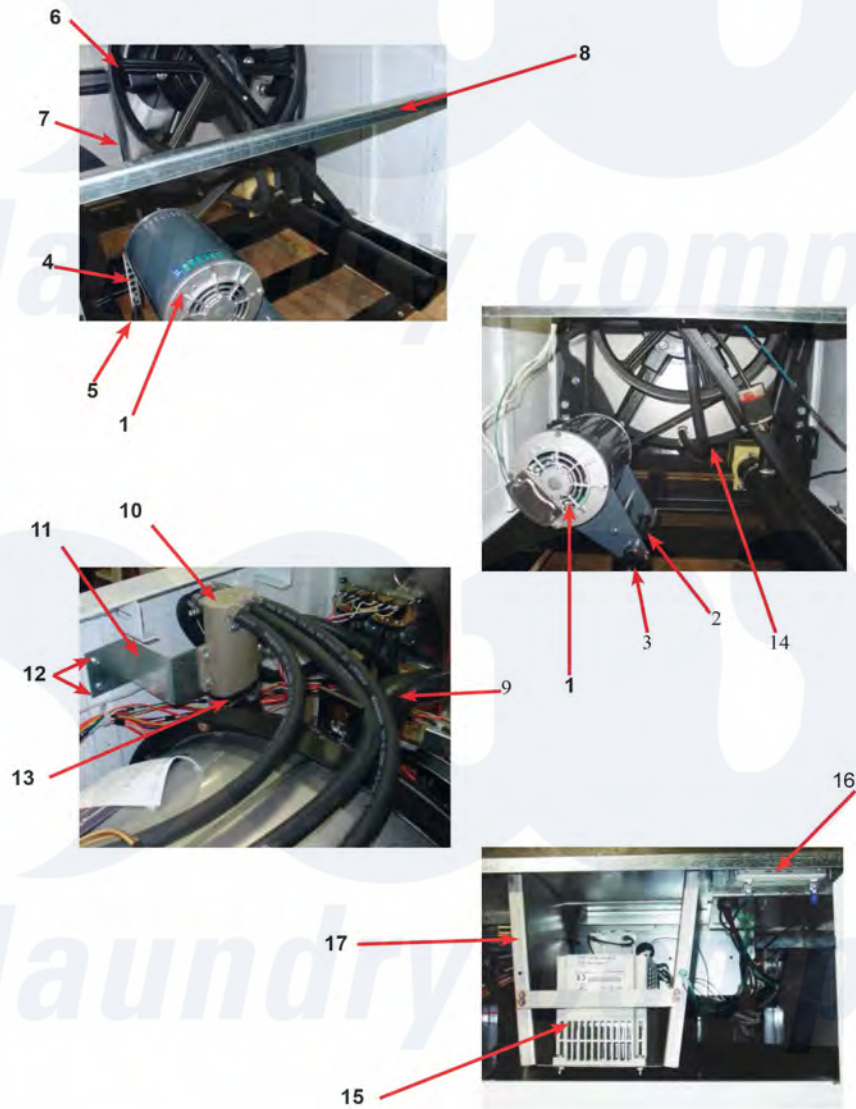

Dexter [Commercial Dexter SWD Stacked Washer and Dryer Parts](#) Parts Diagram WSAD Rear View Access Parts Group
 Click on the part number to view part

Item	Original Part Number	Replaced By	Status	Part Description
1	9376-319-001			Drive Motor, 3 Phase (Inverter duty)
2	9497-222-006		Not Available	Rod, Motor Mtg
*	9076-052-002			Collar, Shaft (w/set screws)
"	9053-074-002			Motor Bushing (plastic) Before Serial # 530726
3	9053-082-001			Motor Bushing (Rubber) after Serial #530726
*	8654-117-019			Clamp-Worm, 316SS, 1.5" (for Rubber bushing)
4	9029-206-002		Not Available	Strap Bracket, Motor Tension (After Serial # 525645)
*	8640-413-002			Nut, Hinge to Door

"	9029-027-005	Not Available	Strap Bracket, Motor Tension (Before Serial # 525645)
"	8640-414-003		Nut, 1/4 Elastic Stop
"	8641-581-006		Washer, Flat (meter assy mtg)
5	9534-319-002		Spring, Tension
*	9545-055-002		Bolt, Eye (1/4"×20×1/2")
"	8640-414-003		Nut, 1/4 Elastic Stop
"	9453-170-003		Pulley, Motor
"	9545-028-015		Set Screw, Sq. Hd.(motor pulley)
"	9487-234-003		Tolerance Ring
6	9453-168-003		Pulley, Driven
*	9545-060-001		Screw 5/8-11×1/1/2"
"	8641-582-018		Lockwasher
"	8641-581-032		Washer, Flat 5/8×2 1/4"
7	9040-077-003		Belt, Motor Drive
8	9081-131-001	Not Available	Channel, Rear
*	9545-008-026		Screw, Vault Mtg
"	8640-399-004	8640-399-008	Nut, Spring-To Front Panel
"	9242-449-004		Hose, Overflow to drain
"	8654-117-009		Clamp, Tub End
9	9242-463-005		Hose, Overflow Vent Top
*	8654-117-014		Clamp, Hose to Vacuum Breaker
10	9610-001-001		Vaccum Breaker ALL
11	9029-121-001	Not Available	Bracket, Vacume Breaker
12	9545-008-026		Screw, Vault Mtg
13	9242-458-001		Hose, Vacuum Breaker to tub
*	9456-041-006		Plug-Plastic, 7/8"
"	9454-714-001		Panel Assy., Back
"	9545-008-026		Screw, Vault Mtg
"	9545-030-002		Screw Tube (Bracket to Base 1/4"×3/4)
"	8640-399-004	8640-399-008	Nut, Spring-To Front Panel
14	9242-175-005		Hose, Pressure Switch
*	8654-117-015		Clamp, Pressure Switch Hose
15	9375-015-014	9375-015-014P	VFD-WSAD25KCS
16	9483-004-002		Braking resistors (200 ohm)
17	9985-176-001	Not Available	Bracket assembly (drive mounting)

the laundry company®