

## Dexter WCAD20KCS-10 (T300) Loading Door Parts

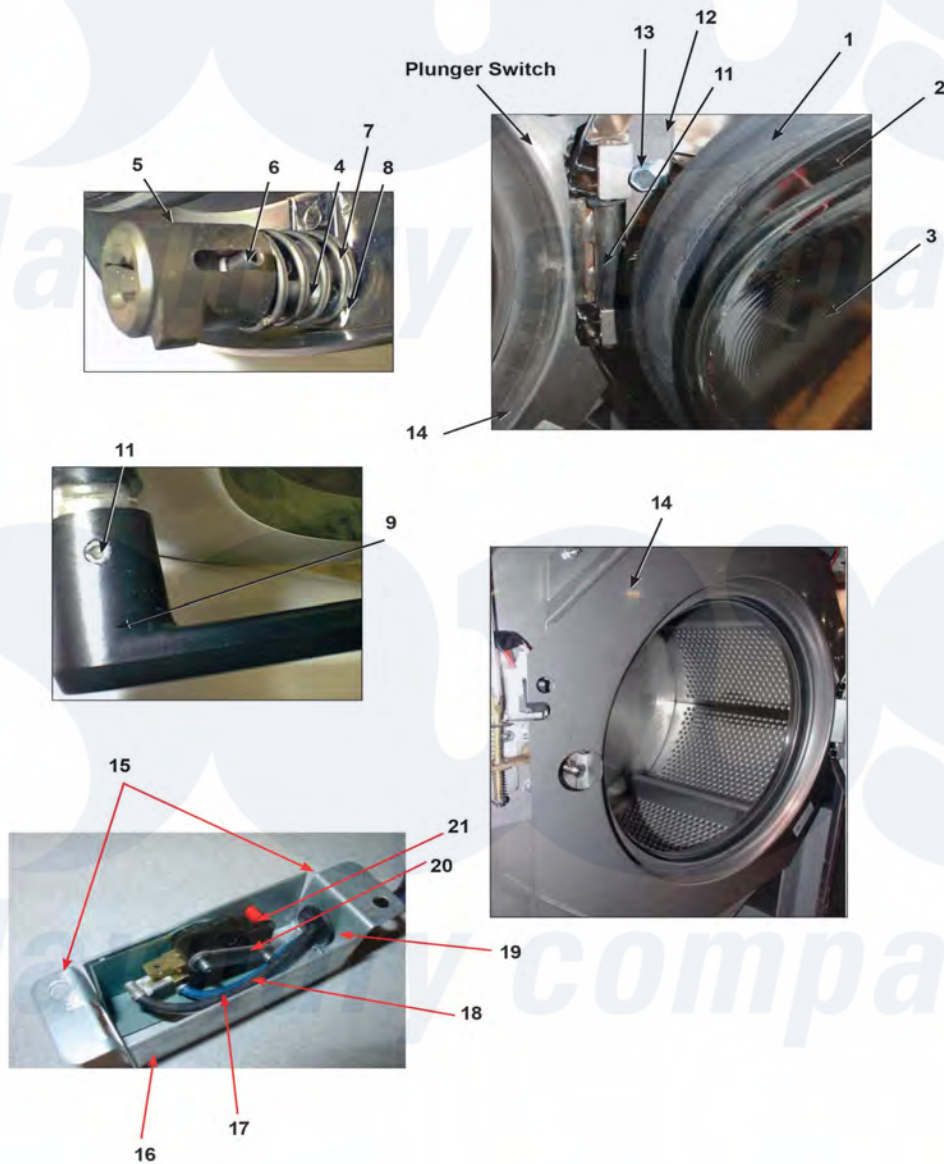

Dexter [Commercial Dexter WCAD20KCS-10 \(T300\) Washer Parts](#) Parts Diagram Loading Door Parts  
 Click on the part number to view part

Item	Original Part Number	Replaced By	Status	Part Description
*	9960-273-001	<a href="#">9960-273-001P</a>		18# Door Assy.
1	<a href="#">9487-264-001</a>			Loading Door, Ring
2	<a href="#">9206-411-002</a>			Gasket, Loading Door
3	<a href="#">9635-018-001</a>			Window, Loading Door
*	9913-134-003	<a href="#">9913-134-003P</a>		Shaft assy.
4	<a href="#">9537-195-002</a>			Shaft, Door Locking
5	<a href="#">9095-040-002</a>			Cam, Locking
6	<a href="#">9451-181-005</a>			Pin, Groove (1 1/4)
7	<a href="#">9451-181-004</a>			Pin, Dowel
	<a href="#">8649-031-002</a>			Retaining Ring (c-clip)
8	<a href="#">9534-360-002</a>			Spring, Lock Cam

9	<a href="#">9244-080-003</a>		Handle, Door
11	<a href="#">9451-181-006</a>		Pin, Door Handle (groove)
*	<a href="#">9545-014-009</a>		Screw, Hinge Mtg 5/16" x 3/4"
"	<a href="#">8641-582-009</a>		Lockwasher, Circuit Board
"	<a href="#">9552-036-001</a>		Shim, Loading Door Hinge, Thin
10	<a href="#">9955-029-002</a>		Door Hinge Assembly Mounts to Tub Front
13	<a href="#">9545-056-001</a>		Screw, Loading Door Mtg (5/16" TF)
*	9059-063-004	<a href="#">9059-063-004P</a>	Edge protector 18
"	<a href="#">8640-413-002</a>		Nut, Hinge to Door
"	<a href="#">9627-791-003</a>		Wiring Harness doorlock safety switch
12	<a href="#">9938-040-002</a>		Loading Door Hinge Clamp (mounts to door ring )
*	<a href="#">9079-122-003</a>		Loading Door Hinge Clamp (No Hinge Switch Pin) (NEW Style)
14	<a href="#">9950-059-001</a>		Masking Assembly
*	<a href="#">8640-413-002</a>		Nut, Hinge to Door
15	<a href="#">9801-089-001</a>		Switch Assembly Complete Door Closure
16	9041-087-001	Not Available	Switch Box
17	<a href="#">8220-063-026</a>		Wire Assembly Door Close Switch, BLK 17"
18	<a href="#">8220-063-025</a>		Wire Assembly Door Close Switch, Red 17"
19	<a href="#">9053-067-003</a>		Bushing Insulating
20	<a href="#">8640-401-001</a>		Nut, Special Twin
*	<a href="#">9545-020-001</a>		Screw, Switch Mtg
"	<a href="#">8640-413-002</a>		Nut, Hinge to Door
"	<a href="#">9008-004-001</a>		Actuator, Switch- Lower
21	<a href="#">9539-461-007</a>		Switch-Micro

*the laundry company*<sup>®</sup>