

## Dexter WCAD25KCS-12 (T-400) Cylinder, Seals & Bearings

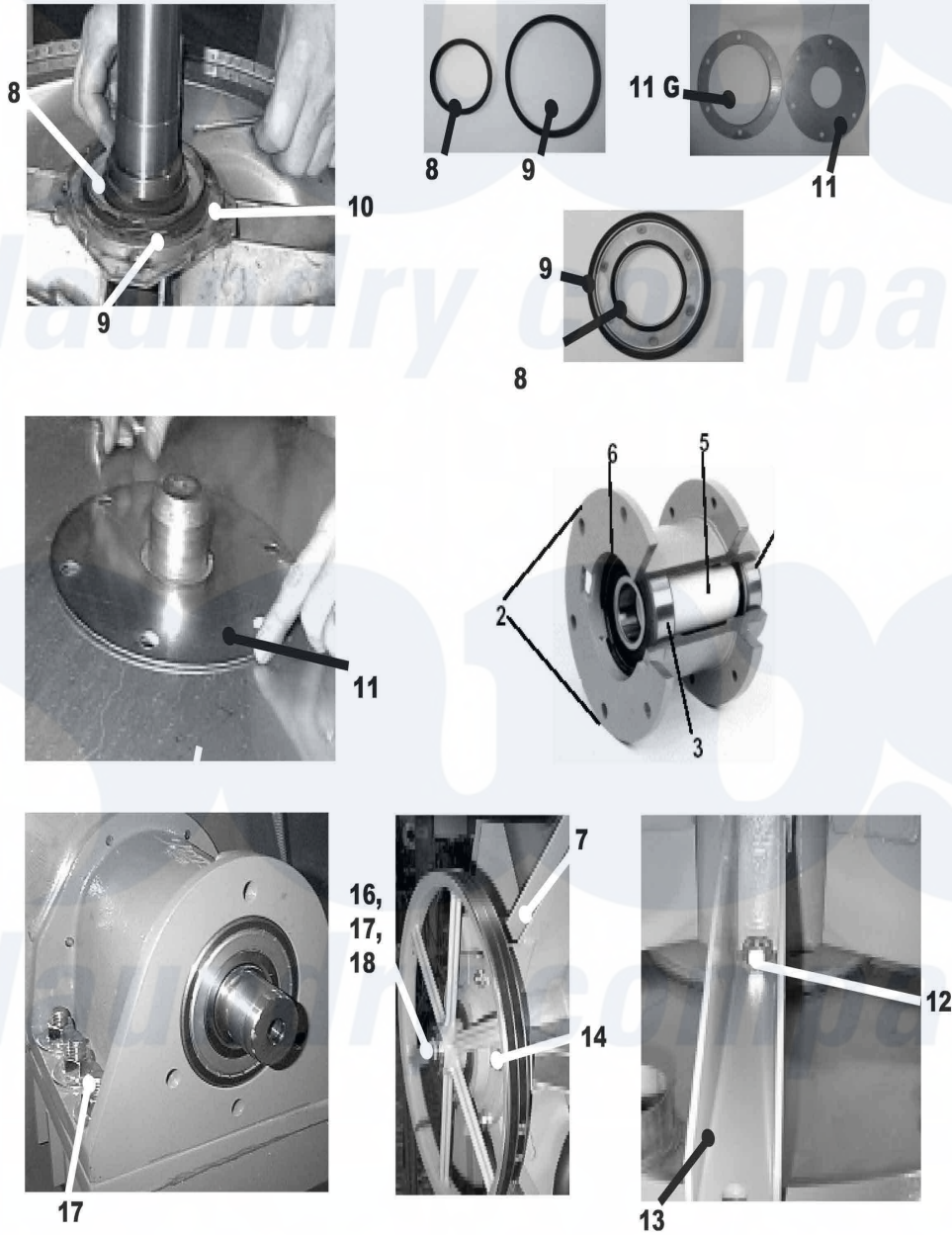

Dexter [Commercial Dexter WCAD25KCS-12 \(T-400\) Washer Parts](#) Parts Diagram Cylinder, Seals & Bearings  
 Click on the part number to view part

Item	Original Part Number	Replaced By	Status	Part Description
*	<a href="#">9803-179-002</a>			Housing, Bearing- Assembly (items #2-#6)
2	<a href="#">9241-169-002</a>			Housing, Bearing
3	<a href="#">9036-159-002</a>			Bearing, Ball-Front
4	<a href="#">9036-159-001</a>			Bearing, Ball-Rear
5	<a href="#">9538-158-001</a>			Spacer, Bearing
6	<a href="#">9487-238-001</a>			Ring, Bearing Retainer
7	<a href="#">9732-137-002</a>			Back Assy, Tub 2 piece
8	<a href="#">9532-140-002</a>			Seal, Primary
9	<a href="#">9532-140-003</a>			Seal, Secondary
10	<a href="#">9950-042-001</a>			Ring, Seal Mounting
11	<a href="#">9487-261-002</a>			Tub Back Mating Ring

12	<a href="#">9545-017-009</a>		Screw, Hx Cap
"	<a href="#">8640-417-005</a>		Nut, 1/2 - 13
"	<a href="#">8641-582-016</a>		Lockwasher
13	9991-048-002	<a href="#">9991-061-002</a>	Support Arm Assy, Bearing Housing
14	<a href="#">9545-029-003</a>		Bolt, 3/8-16 x 1 1/2
"	<a href="#">8640-415-004</a>		Nut
15	<a href="#">9453-168-004</a>		Pulley, Driven
--	<a href="#">9487-234-001</a>		Ring, Tolerance
16	<a href="#">8641-581-026</a>		Washer, Flat
18	<a href="#">9545-017-009</a>		Screw, Hx Cap
20	<a href="#">8641-582-016</a>		Lockwasher
--	9848-109-001	<a href="#">9732-120-001</a>	Cylinder Ass'y
"	9869-016-001	<a href="#">9869-016-001P</a>	Tub & Cylinder

