

## Dexter WCAD40KCS-12 (T-600) Cylinder, Seals & Bearings

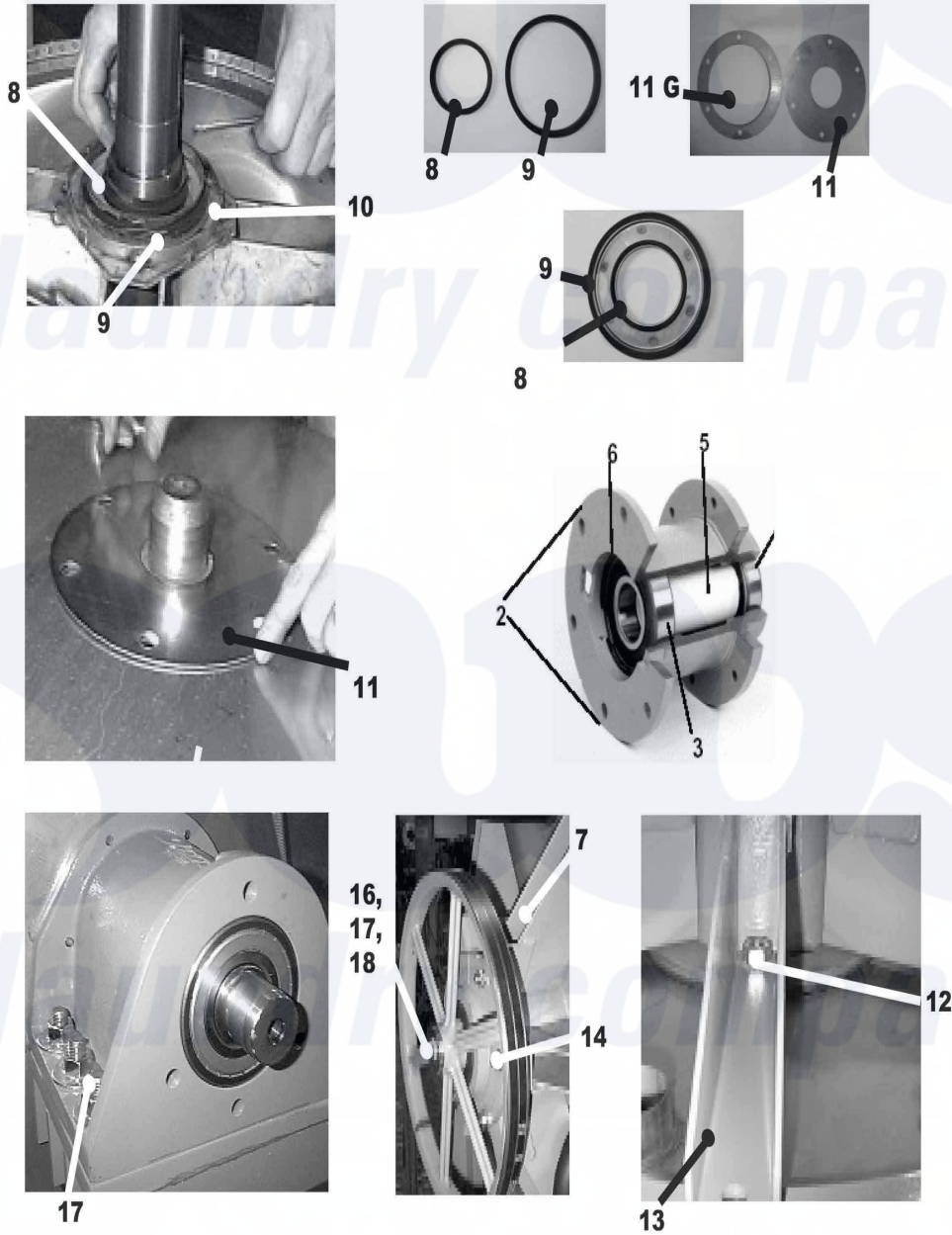

Dexter [Commercial Dexter WCAD40KCS-12 \(T-600\) Washer Parts](#) Parts Diagram Cylinder, Seals & Bearings  
 Click on the part number to view part

Item	Original Part Number	Replaced By	Status	Part Description
*	<a href="#">9803-186-001</a>			Housing, Bearing- Assembly (items #2-#6)
2	<a href="#">9241-180-002</a>			Housing, Bearing
3	<a href="#">9036-159-005</a>			Bearing, Front ( LARGE )
4	<a href="#">9036-159-004</a>			Bearing, Rear ( SMALL )
5	<a href="#">9538-167-001</a>			Spacer, Bearing
6	<a href="#">9487-238-003</a>			Ring, Bearing Retainer
7	<a href="#">9732-137-003</a>			Back Assy, Tub 2 piece
8	<a href="#">9532-140-002</a>			Seal, Primary
9	<a href="#">9532-140-006</a>			Seal, Secondary
10	<a href="#">9950-048-001</a>			Ring, Seal Mounting
11	<a href="#">9487-261-003</a>			Tub Back Mating Ring

12	<a href="#">9545-059-003</a>		Screw, 7/16-14x1 1/2
"	<a href="#">8640-425-001</a>		Nut, Hex 5/8-11
"	<a href="#">8641-582-018</a>		Lockwasher
13	<a href="#">9991-056-002</a>		Support Arm Assy, Bearing Housing
14	<a href="#">9545-059-003</a>		Screw, 7/16-14x1 1/2
"	<a href="#">8640-416-005</a>		Nut, Flange Lock
15	<a href="#">9453-168-003</a>		Pulley, Driven
--	<a href="#">9487-234-003</a>		Tolerance Ring
16	<a href="#">8641-581-032</a>		Washer, Flat 5/8x2 1/4
19	<a href="#">9545-060-001</a>		Screw 5/8-11x1 1/2
18	<a href="#">8641-582-018</a>		Lockwasher
--	9848-113-001	<a href="#">9732-121-001</a>	Cylinder Ass'y
"	<a href="#">9869-017-001</a>		Tub and Cylinder Assy.

