

Dexter WCN25AB Loading Door Group

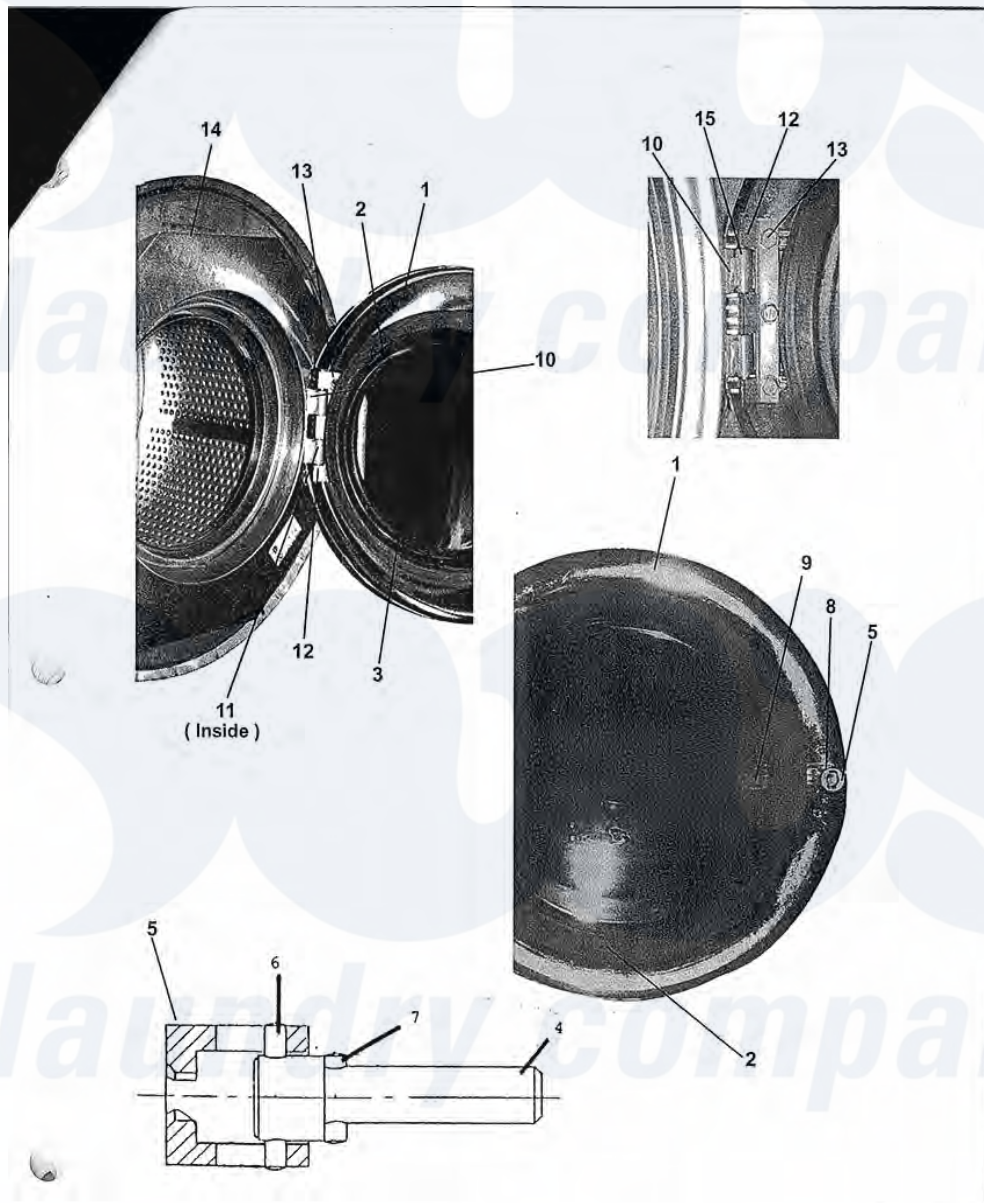

55

Dexter Commercial Dexter WCN25AB Washer Parts Parts Diagram Loading Door Group
 Click on the part number to view part

Item	Original Part Number	Replaced By	Status	Part Description
*	9960-259-002	9732-178-002		Kit-Door Assy.
1	9487-230-001		Not Available	Loading Door, Ring
2	9206-419-001			Gasket, Loading Door
3	9635-016-001			Window, Loading Door
*	9913-134-003	9913-134-003P		Shaft assy.
4	9537-195-002			Shaft, Door Locking
5	9095-040-001	9095-040-002		Cam, Locking
6	9451-181-005			Pin, Groove (1 1/4)
7	9451-181-004			Pin, Dowel
8	9534-360-002			Spring, Lock Cam
9	9244-080-003			Handle, Door

*	9451-181-006		Pin, Door Handle (groove)
10	9955-029-001		Hinge Assy, Loading Door
*	9545-014-009		Screw, Hinge Mtg 5/16" x 3/4"
"	8641-582-009		Lockwasher, Circuit Board
"	9552-036-001		Shim, Loading Door Hinge, Thin
"	9552-036-002	Not Available	Shim, Loading Door Hinge, Thick AR AR
11	9451-184-003	9781-001-001	Loading Door Hinge Pin
15	8649-031-000		Ring, Retaining (snap ring ext)
12	9079-122-001		Clamp, Loading Door Hinge Pin
13	9545-056-001		Screw, Loading Door Mtg (5/16" TF)
14	9487-254-001		Ring, Masking
*	9059-063-002	9059-063-002P	Edge protector
"	8640-413-002		Nut, Hinge to Door

