

Dexter WCN40AA (T600) Loading Door Group

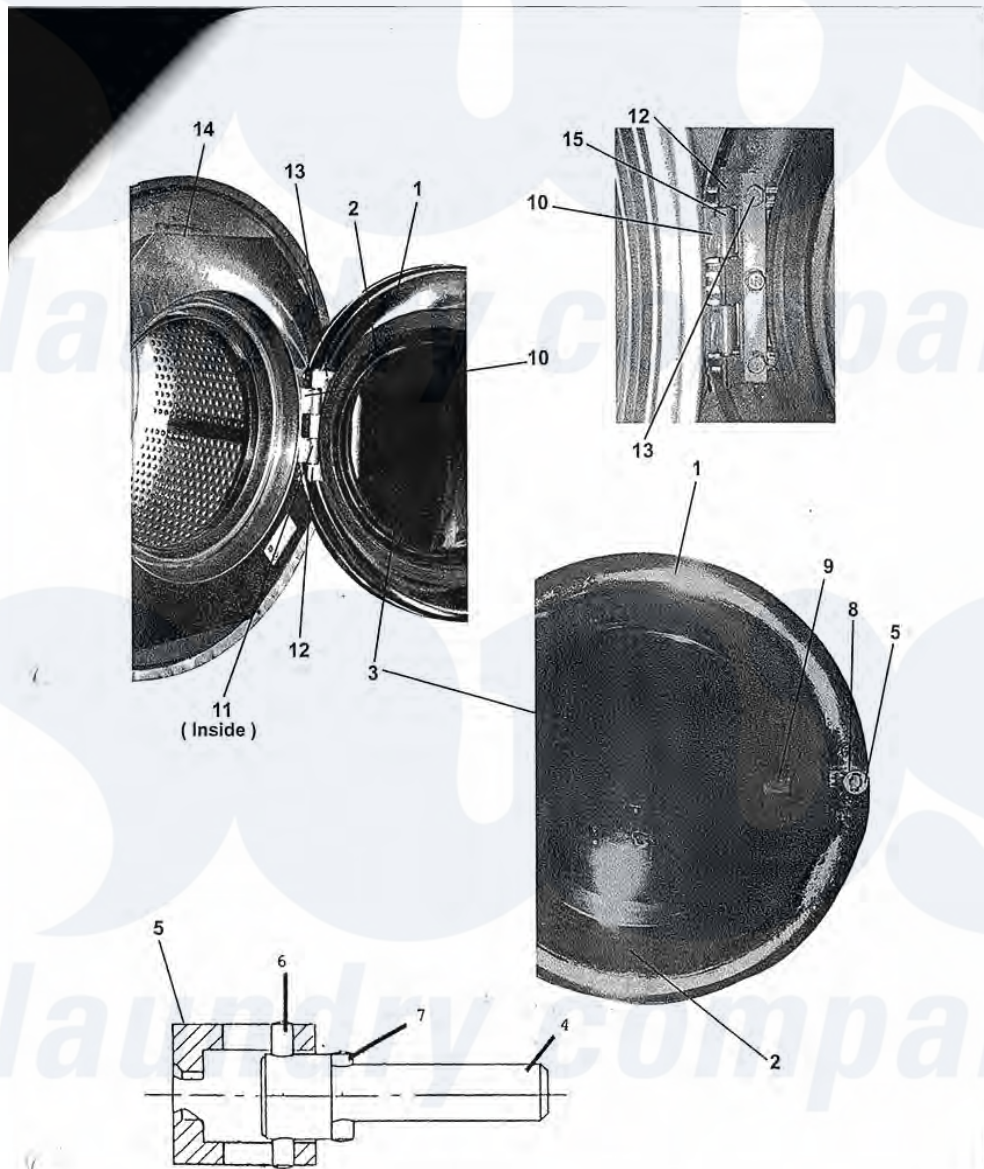

79

[Dexter Commercial Dexter WCN40AA \(T600\) Washer Parts](#) Parts Diagram Loading Door Group
 Click on the part number to view part

Item	Original Part Number	Replaced By	Status	Part Description
*	9960-259-002	9732-178-002		Kit-Door Assy.
1	9487-230-001		Not Available	Loading Door, Ring
2	9206-419-001			Gasket, Loading Door
3	9635-016-001			Window, Loading Door
*	9913-134-003	9913-134-003P		Shaft assy.
4	9537-195-002			Shaft, Door Locking
5	9095-040-001	9095-040-002		Cam, Locking
6	9451-181-005			Pin, Groove (1 1/4)
7	9451-181-004			Pin, Dowel
8	9534-360-002			Spring, Lock Cam
9	9244-080-003			Handle, Door

*	9451-181-006		Pin, Door Handle (groove)
"	9545-014-009		Screw, Hinge Mtg 5/16" x 3/4"
"	8641-582-009		Lockwasher, Circuit Board
"	9552-036-001		Shim, Loading Door Hinge, Thin
"	9552-036-002	Not Available	Shim, Loading Door Hinge, Thick AR AR
10	9955-029-001		Hinge Assy, Loading Door
11	9451-184-003	9781-001-001	Loading Door Hinge Pin
15	8649-031-000		Ring, Retaining (snap ring ext)
12	9079-122-001		Clamp, Loading Door Hinge Pin
13	9545-056-001		Screw, Loading Door Mtg (5/16" TF)
14	9487-254-001		Ring, Masking
*	8640-413-002		Nut, Hinge to Door
"	9059-063-002	9059-063-002P	Edge protector

