

# Dexter WCVD18KCS-10 Loading Door Group 18LB

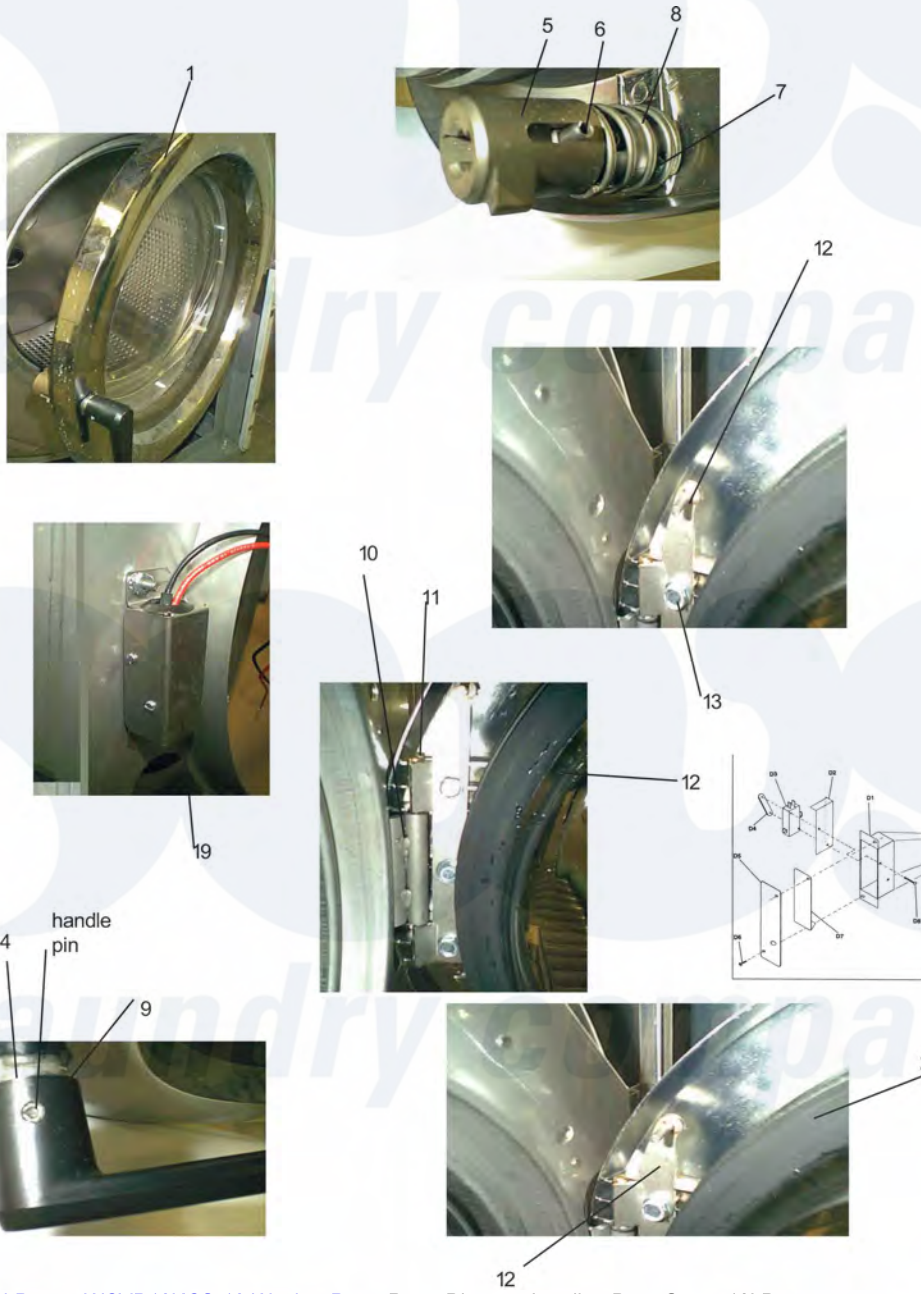

96  
 Dexter [Commercial Dexter WCVD18KCS-10 Washer Parts](#) Parts Diagram Loading Door Group 18LB  
 Click on the part number to view part

Item	Original Part Number	Replaced By	Status	Part Description
*	9960-273-001	<a href="#">9960-273-001P</a>		18# Door Assy.
1	<a href="#">9487-264-001</a>			Loading Door, Ring
2	<a href="#">9206-411-002</a>			Gasket, Loading Door
3	<a href="#">9635-018-001</a>			Window, Loading Door
*	9913-134-003	<a href="#">9913-134-003P</a>		Shaft assy.
4	<a href="#">9537-195-002</a>			Shaft, Door Locking
5	9095-040-001	<a href="#">9095-040-002</a>		Cam, Locking
6	<a href="#">9451-181-005</a>			Pin, Groove (1 1/4)
7	<a href="#">9451-181-004</a>			Pin, Dowel
8	<a href="#">9534-360-002</a>			Spring, Lock Cam
9	<a href="#">9244-080-003</a>			Handle, Door

*	<a href="#">9451-181-006</a>		Pin, Door Handle (groove)
10	<a href="#">9955-029-002</a>		Door Hinge Assembly Mounts to Tub Front
*	<a href="#">9545-014-009</a>		Screw, Hinge Mtg 5/16" x 3/4"
"	<a href="#">8641-582-009</a>		Lockwasher, Circuit Board
"	<a href="#">9552-036-001</a>		Shim, Loading Door Hinge, Thin
"	9552-036-002	Not Available	Shim, Loading Door Hinge, Thick AR AR
11	9451-184-004	<a href="#">9781-001-001</a>	Loading Door Hinge Pin
*	<a href="#">8649-031-000</a>		Ring, Retaining ( snap ring ext )
12	9079-122-002	<a href="#">9079-122-003</a>	Loading Door Hinge Clamp (No Hinge Switch Pin) (NEW Style)
13	<a href="#">9545-056-001</a>		Screw, Loading Door Mtg (5/16" TF)
14	<a href="#">9950-059-001</a>		Masking Assembly
*	9059-063-002	<a href="#">9059-063-002P</a>	Edge protector
"	<a href="#">8640-413-002</a>		Nut, Hinge to Door
15	<a href="#">9539-461-007</a>		Switch-Micro
16	<a href="#">9550-159-001</a>		Shield, Door Switch
17	<a href="#">8220-062-027</a>		Wires Red
18	<a href="#">8220-062-028</a>		Wires Black
19	<a href="#">9801-089-001</a>		Switch Assembly Complete Door Closure
D1	9041-087-001	Not Available	Switch Box
21	<a href="#">9053-067-003</a>		Bushing Insulating
D3	<a href="#">9539-461-007</a>		Switch-Micro
D2	<a href="#">9550-159-001</a>		Shield, Door Switch
D4	<a href="#">8640-401-001</a>		Nut, Special Twin
D8	<a href="#">9545-020-001</a>		Screw, Switch Mtg
D7	<a href="#">9008-004-001</a>		Actuator, Switch- Lower

*the laundry company*<sup>®</sup>