

Dexter WCVD55KCS-12 Chassis And Drain Group 55LB, 75LB

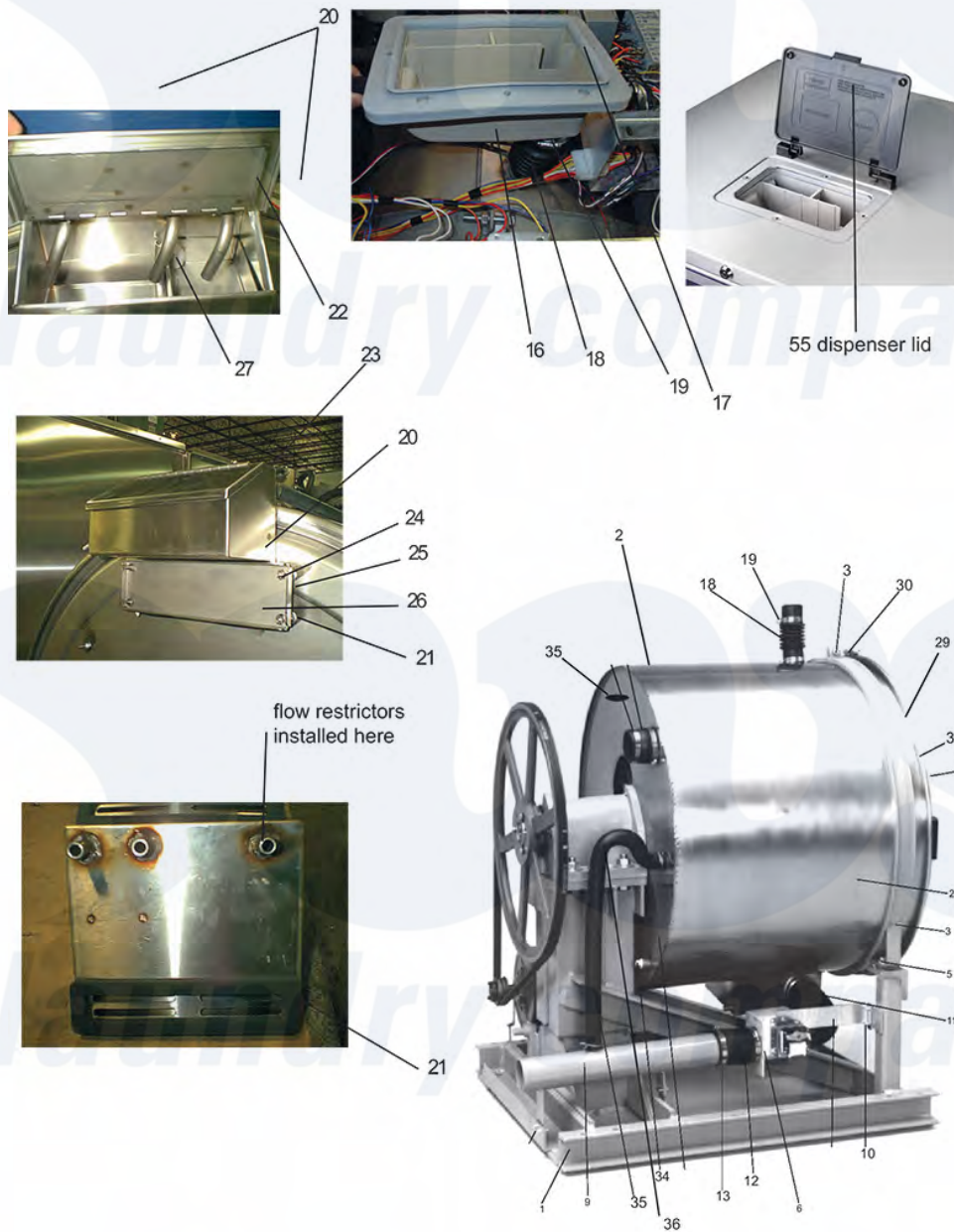

104

Dexter Commercial [Dexter WCVD55KCS-12 Washer Parts](#) Parts Diagram Chassis And Drain Group 55LB, 75LB

[Click on the part number to view part](#)

Item	Original Part Number	Replaced By	Status	Part Description
1	9945-105-002		Not Available	Base Assy,Frame
"	9945-125-002		Not Available	Base Assy,Frame
2	9930-138-001			Outer Tub Assy
"	9930-144-001			Outer Tub Assy
3	9950-053-002	9950-053-002P		Ring-Tub Mtg. Frt
4	9545-017-013			Bolt, 1/2-13x2, Grd 5 Tub to Base
"	8640-417-005			Nut, 1/2 - 13
"	8640-417-002			Nut
"	8641-582-016			Lockwasher
5	9545-017-013			Bolt, 1/2-13x2, Grd 5 Tub to Base
"	8641-581-026			Washer, Flat

"	8641-581-026		Washer, Flat
"	9552-013-001		Shim, Thin AR
"	9552-013-002		Shim, Thick AR
6	9379-187-001	Not Available	Valve Drain before Serial # 482181
9	9915-126-002		Tube Assy, Drain
"	9915-120-002		Tube Assy, Drain
10	9545-030-002		Screw Tube (Bracket to Base 1/4Bx3/4)
11	9242-459-001		Hose, Tub to Drain Valve
12	9242-457-001		Hose, Drain Valve to Tube
13	8654-117-014		Clamp, Hose to Vacuum Breaker
*	9610-001-001		Vaccum Breaker ALL
"	9029-069-001		Bracket, Vacuum Breaker
"	9545-008-026		Screw, Vault Mtg
"	8654-117-001	Not Available	Shim, Support Assembly (thin)
16	9732-108-002	9122-005-004	Dispenser Soap
"	9475-002-002		Flow Restrictors (in dispenser)
17	9475-002-003		Flow Restrictors (in dispenser)
"	9206-416-001		Gasket, Dispenser
18	9242-450-001		Hose, Dispenser to Tub
19	8654-117-008		Clamp, Hose Vent
20	9807-091-001	9732-290-001	Front Soap BoxKit
21	9206-425-001		Soap Box mounting Gasket
22	9987-104-001		Lid Assembly soap box
23	9545-012-017		Lid screws #10-32x1/2 SS
24	8640-413-006	Not Available	Nut Hex Elasticstop #10-32 SS
25	9538-157-019	Not Available	Spacer Plastic #10x1/2
26	9029-148-001	Not Available	Bracket Soap box mounting
27	9574-252-002		Softner siphon tube
28	9475-002-003		Flow Restrictors (in dispenser)
29	9974-007-002	Not Available	Front AssÖy, Tub
30	9950-055-001		Ring Assy.Clamp Tub Mtg.- Rear
31	9545-029-009		Screw, 3/8-16x3
32	8640-415-001		Nut
33	9206-421-002	9206-421-002P	Gasket-Tub Front
34	8615-104-039	Not Available	Pipe Plug 1/2Ó
35	9242-449-003		Hose, Overflow to drain
36	8654-029-000	8654-117-018	Clamp, Hose overflow to drain