

# Maytag A18CA 06 - TRANSMISSION

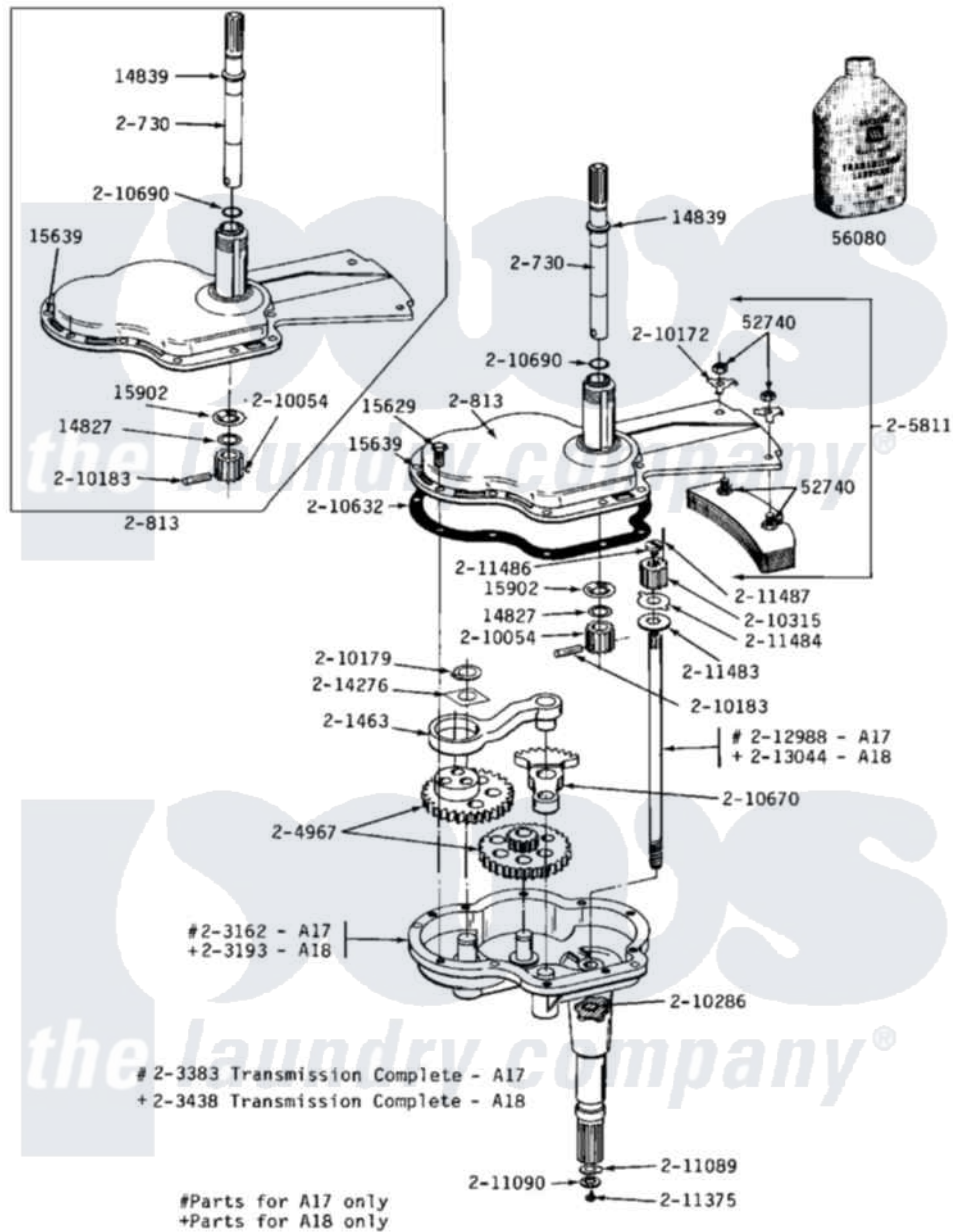

Maytag [Commercial Maytag A18CA Washer Parts](#) Parts Diagram 06 - TRANSMISSION  
 Click on the part number to view part

Item	Original Part Number	Replaced By	Status	Part Description
001	<a href="#">Y014827</a>			Washer-Center Shaft
002	<a href="#">Y014839</a>			Collar-Drive Shaft
003	<a href="#">Y015629</a>			Bolt, Grinding Chamber
004	NLA		Not Available	DOWEL PIN
005	<a href="#">Y015902</a>			Spring For Agitator
006	<a href="#">Y052740</a>	<a href="#">62739</a>		Nut, Lock
007	Y056080	<a href="#">6-0560800</a>		Oil
008	200730	<a href="#">22002124</a>		Shaft- Agi
009	NLA		Not Available	GEAR CASE COVER ASSEMBLY
010	NLA		Not Available	PITMAN WITH WRIST PIN
011	NLA		Not Available	GEAR HOUSING W/STUDS & TUBE
013	203438	<a href="#">W10172457</a>		Transmison
014	203438	<a href="#">W10172457</a>		Transmison
015	<a href="#">204967</a>			Gear Kit-Power Fin Agitator
016	NLA		Not Available	COUNTERWEIGHT

017	<a href="#">210054</a>		Pinion
018	NLA	Not Available	LOCK WASHER
019	NLA	Not Available	RETAINING RING
020	<a href="#">210183</a>		Groove Pin
021	<a href="#">210286</a>		Seal
022	<a href="#">210315</a>		Pinion
023	210632	<a href="#">22210632</a>	Gasket
024	NLA	Not Available	SEGMENT
025	<a href="#">210690</a>		Seal, Rubber
026	<a href="#">211089</a>		Lug, Stop Pulley
027	211090	<a href="#">22003555</a>	Washer, Stop Lug
028	211375	<a href="#">681582</a>	Screw
029	211483	<a href="#">6-2114830</a>	Washer- SP
030	<a href="#">211484</a>		Washer, Lug
031	<a href="#">211486</a>		Screw, 3/8-16 X 1/2 Inch
032	NLA	Not Available	GROOV-PIN
033	<a href="#">213044</a>		Shaft, Center
034	<a href="#">213044</a>		Shaft, Center
035	NLA	Not Available	WASHER FOR GEARS

