

Maytag A18CT 07 - TRANSMISSION

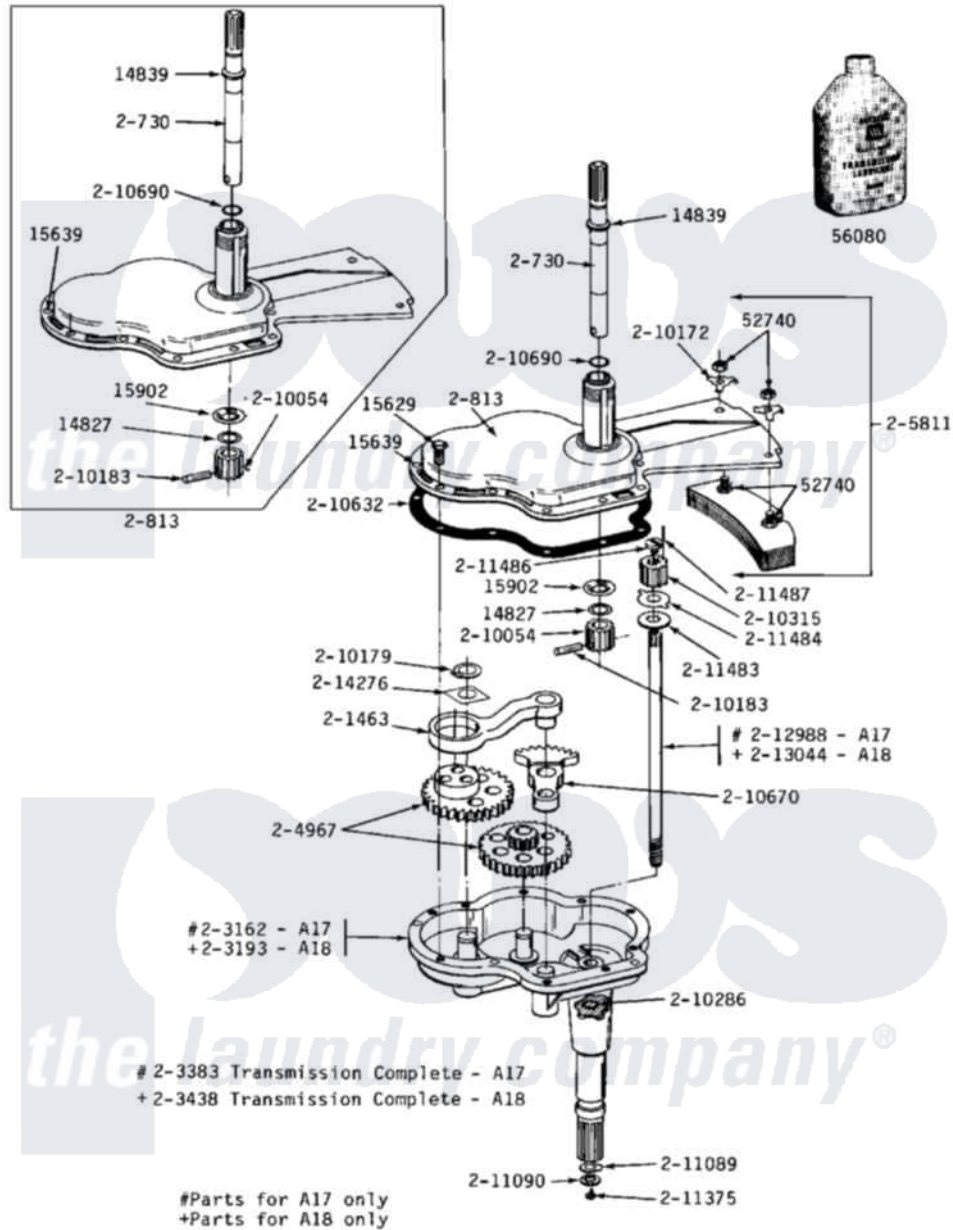

Maytag Commercial Maytag A18CT Washer Parts Parts Diagram 07 - TRANSMISSION

Click on the part number to view part

| Item | Original Part Number | Replaced By | Status | Part Description |
|------|-------------------------|---------------------------|---------------|-----------------------------|
| 001 | Y014827 | | | Washer-Center Shaft |
| 002 | Y014839 | | | Collar-Drive Shaft |
| 003 | Y015629 | | | Bolt, Grinding Chamber |
| 004 | NLA | | Not Available | DOWEL PIN |
| 005 | Y015902 | | | Spring For Agitator |
| 006 | Y052740 | 62739 | | Nut, Lock |
| 007 | Y056080 | 6-0560800 | | Oil |
| 008 | 200730 | 22002124 | | Shaft- Agi |
| 009 | NLA | | Not Available | GEAR CASE COVER ASSEMBLY |
| 010 | NLA | | Not Available | PITMAN WITH WRIST PIN |
| 011 | NLA | | Not Available | GEAR HOUSING W/STUDS & TUBE |
| 013 | 203438 | W10172457 | | Transmison |
| 014 | 203438 | W10172457 | | Transmison |
| 015 | 204967 | | | Gear Kit-Power Fin Agitator |
| 016 | NLA | | Not Available | COUNTERWEIGHT |

| | | | |
|-----|------------------------|---------------------------|--------------------------|
| 017 | 210054 | | Pinion |
| 018 | NLA | Not Available | LOCK WASHER |
| 019 | NLA | Not Available | RETAINING RING |
| 020 | 210183 | | Groove Pin |
| 021 | 210286 | | Seal |
| 022 | 210315 | | Pinion |
| 023 | 210632 | 22210632 | Gasket |
| 024 | NLA | Not Available | SEGMENT |
| 025 | 210690 | | Seal, Rubber |
| 026 | 211089 | | Lug, Stop Pulley |
| 027 | 211090 | 22003555 | Washer, Stop Lug |
| 028 | 211375 | 681582 | Screw |
| 029 | 211483 | 6-2114830 | Washer- SP |
| 030 | 211484 | | Washer, Lug |
| 031 | 211486 | | Screw, 3/8-16 X 1/2 Inch |
| 032 | NLA | Not Available | GROOV-PIN |
| 033 | 213044 | | Shaft, Center |
| 034 | 213044 | | Shaft, Center |
| 035 | NLA | Not Available | WASHER FOR GEARS |

