

Maytag A25CME 07 - TRANSMISSION (SERIES 00)

ALL MODELS

TRANSMISSION
PRIOR TO SERIES 10

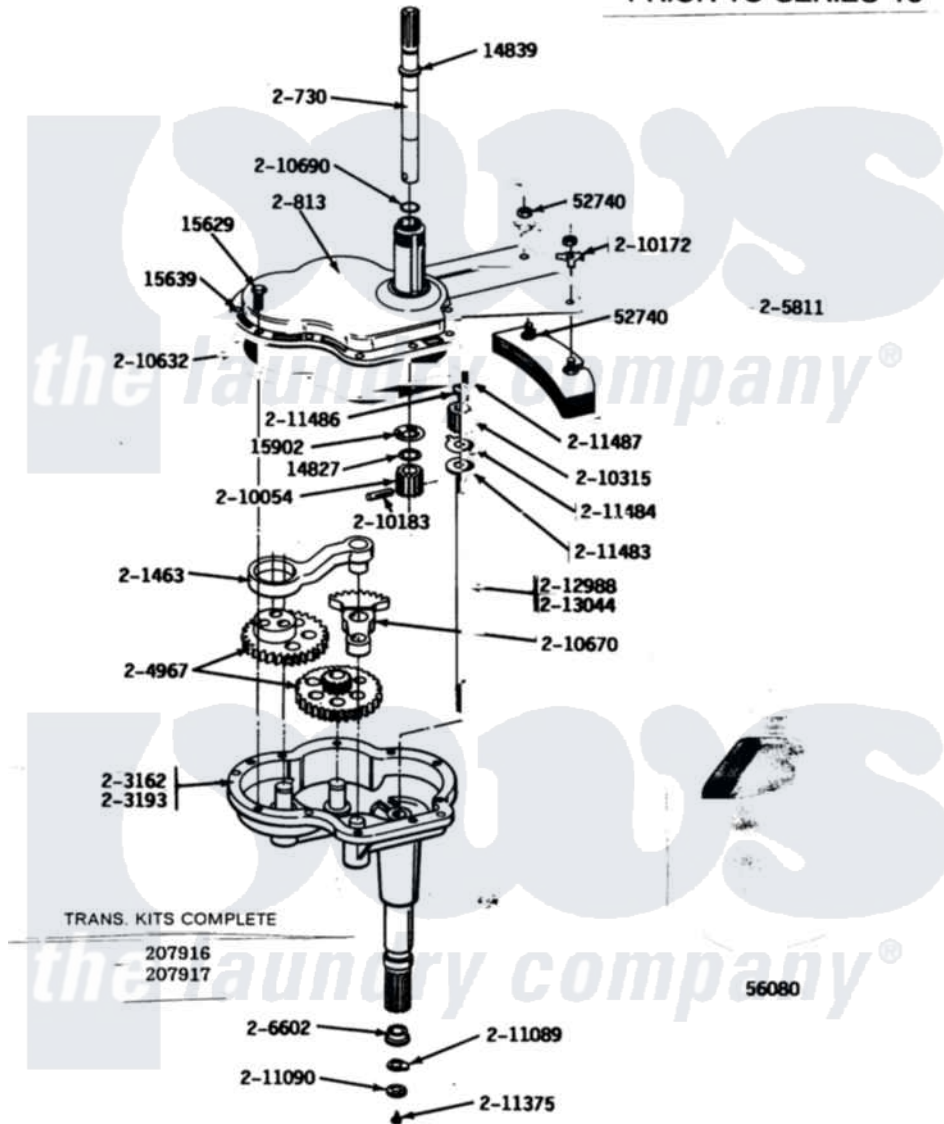

Maytag Commercial Maytag A25CME Washer Parts Parts Diagram 07 - TRANSMISSION (SERIES 00)
Click on the part number to view part

Item	Original Part Number	Replaced By	Status	Part Description
001	Y014827			Washer-Center Shaft
002	Y014839			Collar-Drive Shaft
003	Y015629			Bolt, Grinding Chamber
004	NLA		Not Available	DOWEL PIN
005	Y015902			Spring For Agitator
006	Y052740	62739		Nut, Lock
007	Y056080	6-0560800		Oil
008	200730	22002124		Shaft- Agi
009	NLA		Not Available	GEAR CASE COVER ASSEMBLY
010	NLA		Not Available	PITMAN WITH WRIST PIN
011	NLA		Not Available	GEAR HOUSING W/STUDS & TUBE
012	NLA		Not Available	PART NOT USED
013	204967			Gear Kit-Power Fin Agitator
014	NLA		Not Available	COUNTERWEIGHT
015	206602	207843		Lip Seal Repair Kit

016	210054		Pinion
017	NLA	Not Available	LOCK WASHER
018	210183		Groove Pin
019	210315		Pinion
020	210632	22210632	Gasket
021	NLA	Not Available	SEGMENT
022	210690		Seal, Rubber
023	211089		Lug, Stop Pulley
024	211090	22003555	Washer, Stop Lug
025	211375	681582	Screw
026	211483	6-2114830	Washer- SP
027	211484		Washer, Lug
028	211486		Screw, 3/8-16 X 1/2 Inch
029	NLA	Not Available	GROOV-PIN
030	212988		Part Not Used
031	213044		Shaft, Center

