

MODELS DG21CA CONVERSION KITS FOR GAS VALVES

KITS FOR THE 3-3388 GAS VALVE

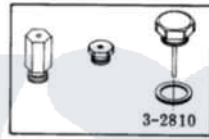

3-3751
Conv. Kit - Nat. to LPG
for 3-3388 gas valve

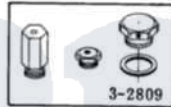

3-4672
Conv. Kit - LPG to Nat.
for 3-3388 gas valve



3-5860 Main Burner
Orifice Kit - Nat.
for 3-3388 gas valve



3-5861 Main Burner
Orifice Kit - LPG
for 3-3388 gas valve



3-5862 Main Burner
Orifice Kit - Mixed
for 3-3388 gas valve



3-5863 Main Burner
Orifice Kit - Mfg.
for 3-3388 gas valve

MODELS DG21CM-CS-CT

KITS FOR THE 3-3777 GAS VALVE

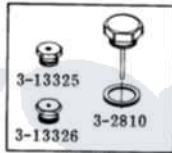

3-3779
Conv. Kit - Nat. to LPG
for 3-3777 gas valve



3-13366 Main Burner
Orifice - Internal - Nat.



3-13367 Main Burner
Orifice - External - Nat.



3-13381 Main Burner
Orifice Kit - Mfg.
for 3-3777 gas valve

Maytag [Commercial Maytag DG21CA Dryer Parts](#) Parts Diagram 08 - CONVERSION KIT
Click on the part number to view part

Item	Original Part Number	Replaced By	Status	Part Description
001	NLA		Not Available	SCREW ASSEMBLY, LEAK LIMIT
002	NLA		Not Available	SCREW ASSM - BLUE BLOCK OPE
003	Y303751	MAL9000AXX		LP Gas Con
004	Y304672			Conversion Kit-LPG To Nat.
005	305860		Not Available	MAIN BURNER ORIFICE KIT-NAT
006	NLA		Not Available	MAIN BURNER ORIFICE KIT-LPG
007	NLA		Not Available	MAIN BURNER ORIFICE KIT-MIX
008	NLA		Not Available	MAIN BURNER ORIFICE KIT-MFG