

MODELS DG21CA **CONVERSION KITS FOR GAS VALVES**

KITS FOR THE 3-3388 GAS VALVE

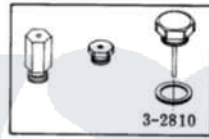

3-3751
Conv. Kit - Nat. to LPG
for 3-3388 gas valve

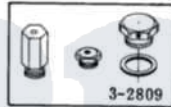

3-4672
Conv. Kit - LPG to Nat.
for 3-3388 gas valve



3-5860 Main Burner
Orifice Kit - Nat.
for 3-3388 gas valve



3-5861 Main Burner
Orifice Kit - LPG
for 3-3388 gas valve



3-5862 Main Burner
Orifice Kit - Mixed
for 3-3388 gas valve



3-5863 Main Burner
Orifice Kit - Mfg.
for 3-3388 gas valve

MODELS DG21CM-CS-CT

KITS FOR THE 3-3777 GAS VALVE

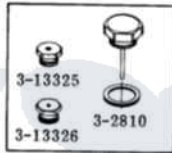

3-3779
Conv. Kit - Nat. to LPG
for 3-3777 gas valve



3-13366 Main Burner
Orifice - Internal - Nat.



3-13367 Main Burner
Orifice - External - Nat.

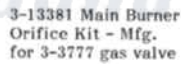

3-13381 Main Burner
Orifice Kit - Mfg.
for 3-3777 gas valve

Maytag [Commercial Maytag DG21CT Dryer Parts](#) Parts Diagram 16 - CONVERSION KIT
Click on the part number to view part

Item	Original Part Number	Replaced By	Status	Part Description
001	NLA		Not Available	SCREW ASSM - BLUE BLOCK OPE
002	Y303779			Conversion Kit
003	NLA		Not Available	MAIN BURNER ORIFICE - LPG
004	NLA		Not Available	INTERNAL ORIFICE - LPG
005	313366			Main Burner Orifice-Ext-NAT
006	313367			Main Burner Orifice-Int-NAT
007	NLA		Not Available	MAIN BURNER ORIFICE (MFG)