

# Maytag DGS30PC1 04 - DUAL CTRL MICROPROCESSOR (DMC) CNTRL BOX

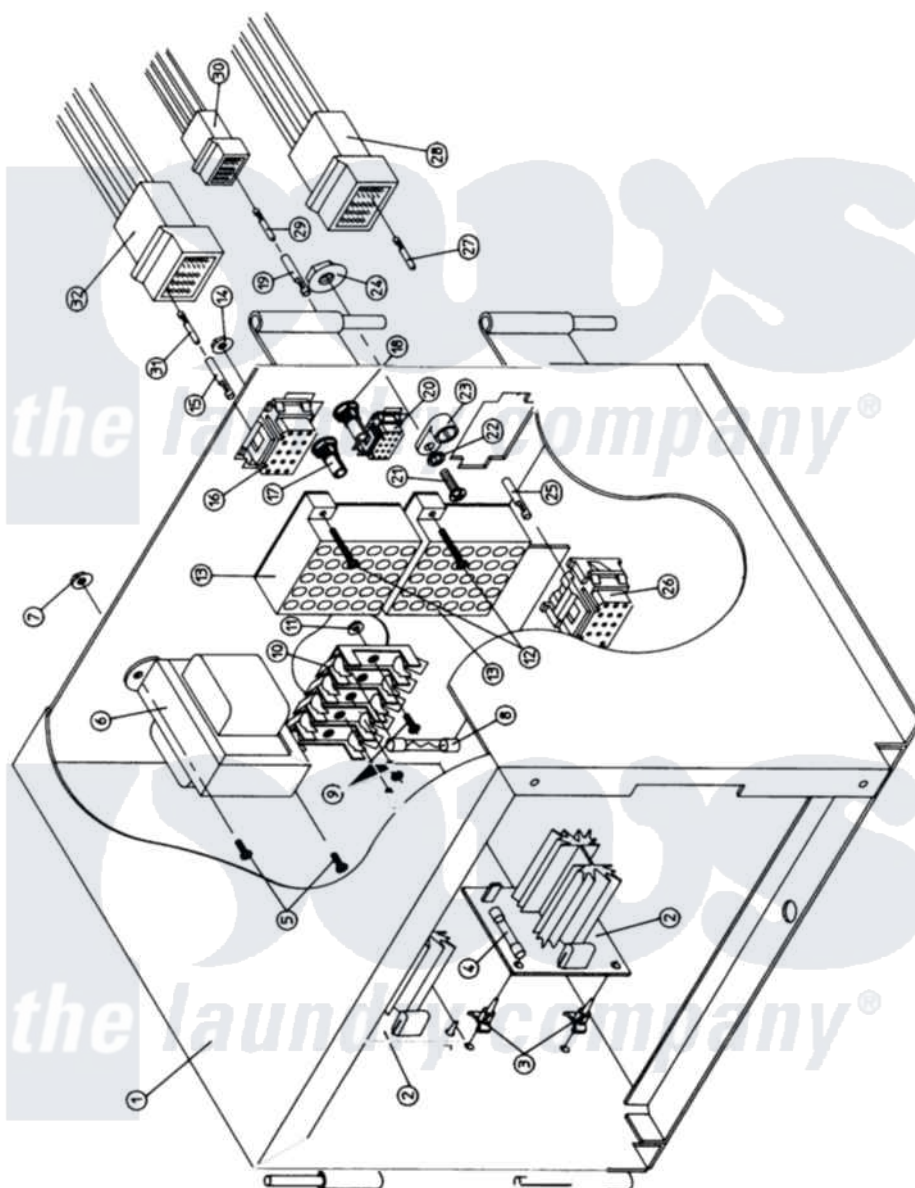

Maytag [Commercial Maytag DGS30PC1 Dryer Parts](#) Parts Diagram 04 - DUAL CTRL MICROPROCESSOR (DMC) CNTRL BOX

[Click on the part number to view part](#)

| Item | Original Part Number | Replaced By               | Status        | Part Description  |
|------|----------------------|---------------------------|---------------|---|
| 000  | W10124350            |                           | Not Available | ORDER PARTS FROM AMERICAN DRYER CORP AT 508-678-9000      |
| 001  | A800192              |                           | Not Available | DMC CONTROL BOX ASSY COMPLETE SPECIFY COLOR WHEN ORDERING |
| 002  | A137152              |                           | Not Available | SOLID STATE RELAY BOARD 1HP                               |
| 003  | A137013              | <a href="#">137013</a>    |               | Pc Bd Nylo  |
| 004  | A136058              | <a href="#">136058</a>    |               | 25A 125V  |
| 005  | A150106              | <a href="#">150106</a>    |               | 8-32 X 1  |
| 006  | A141403              |                           | Not Available | TRANSFORMER (24 VAC) (FOR MICROPROCESSOR MODELS)          |
| 007  | A151001              | <a href="#">W10146764</a> |               | 8-32 Pal N  |
| 008  | A136057              | <a href="#">W10146739</a> |               | 0.5 A 250   |
| 009  | A150106              | <a href="#">150106</a>    |               | 8-32 X 1  |

|     |         |                           |               |                           |
|-----|---------|---------------------------|---------------|---------------------------|
| 010 | A136009 |                           | Not Available | 5 POSITION FUSE BLOCK     |
| 011 | A151001 | <a href="#">W10146764</a> |               | 8-32 Pal N                |
| 012 | A150002 | <a href="#">150002</a>    |               | 6-32 X 1                  |
| 013 | A120715 | <a href="#">W10146700</a> |               | 30 Pos Ter                |
| 014 | A151000 | <a href="#">WH12X195</a>  |               | Switch Assembly           |
| 015 | A122705 | <a href="#">122705</a>    |               | Umnl Sok 2                |
| 016 | A122626 | <a href="#">122626</a>    |               | 15P Umnl C                |
| 017 | A122729 |                           | Not Available | TRANSMIT CONNECTOR (GREY) |
| 018 | A122728 |                           | Not Available | RECEIVER CONNECTOR (BLUE) |
| 019 | A122705 | <a href="#">122705</a>    |               | Umnl Sok 2                |
| 020 | A122631 | <a href="#">122631</a>    |               | 06P Umnl C                |
| 021 | A150111 | <a href="#">150111</a>    |               | 1 4-20 X 1                |
| 022 | A153007 | <a href="#">153007</a>    |               | 1 4 Split                 |
| 023 | A121010 | <a href="#">121010</a>    |               | 14-4 Termi                |
| 024 | A152014 | <a href="#">152014</a>    |               | 1 4-20 Ser                |
| 025 | A122705 | <a href="#">122705</a>    |               | Umnl Sok 2                |
| 026 | A122626 | <a href="#">122626</a>    |               | 15P Umnl C                |
| 027 | A122704 | <a href="#">122704</a>    |               | Umnl Pin 2                |
| 028 | A122625 | <a href="#">122625</a>    |               | 15 Pin Umn                |
| "   | A137025 | <a href="#">137025</a>    |               | 6-15 Positive             |
| 029 | A122704 | <a href="#">122704</a>    |               | Umnl Pin 2                |
| 030 | A122630 | <a href="#">122630</a>    |               | 06P Umnl P                |
| "   | A137025 | <a href="#">137025</a>    |               | 6-15 Positive             |
| 031 | A122704 | <a href="#">122704</a>    |               | Umnl Pin 2                |
| 032 | A122625 | <a href="#">122625</a>    |               | 15 Pin Umn                |
| "   | A122800 | <a href="#">122800</a>    |               | M R EXTRAC                |
| "   | A122801 | <a href="#">W10146716</a> |               | Mate-N-Loc                |
| "   | A137025 | <a href="#">137025</a>    |               | 6-15 Positive             |

