

# Maytag GA25CS 07 - TRANSMISSION (SERIES 00)

ALL MODELS

TRANSMISSION  
PRIOR TO SERIES 10

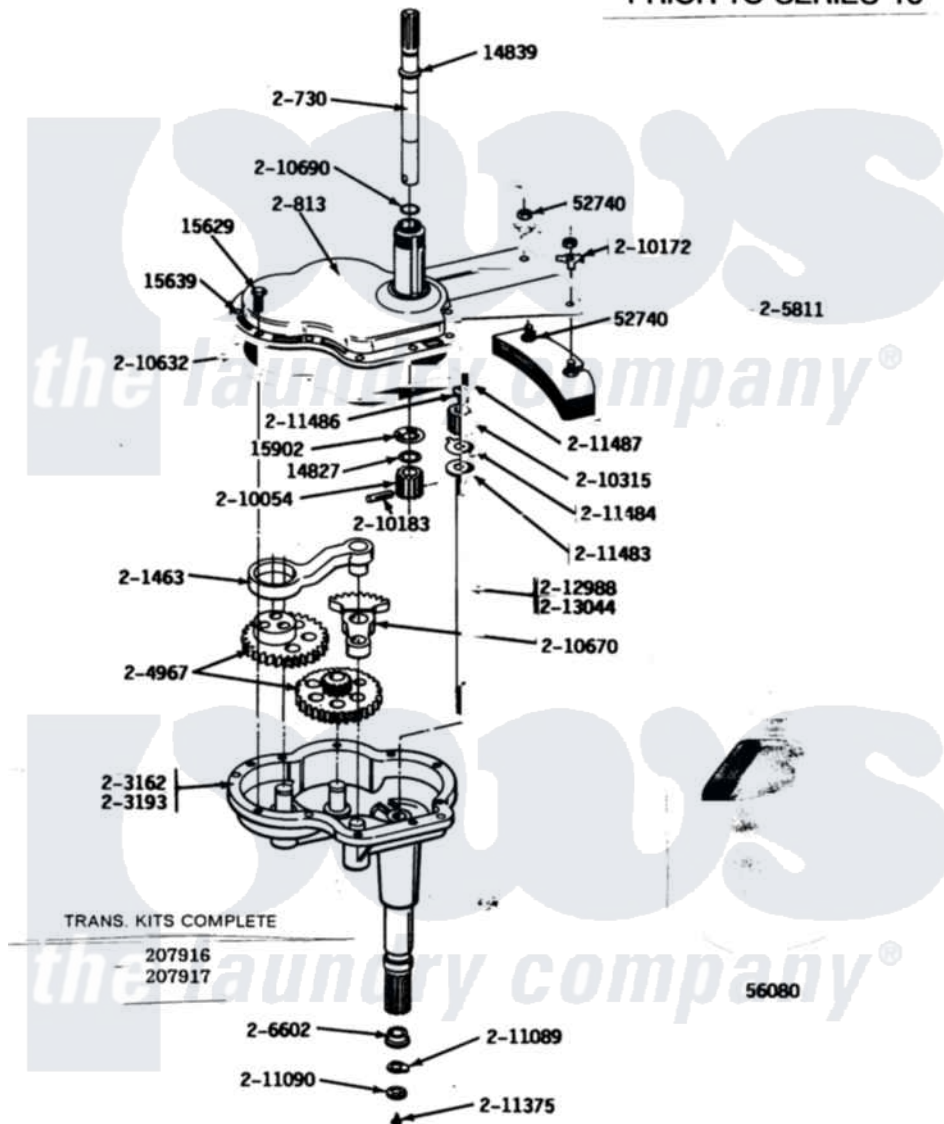

Maytag Commercial Maytag GA25CS Washer Parts Parts Diagram 07 - TRANSMISSION (SERIES 00)  
Click on the part number to view part

Item	Original Part Number	Replaced By	Status	Part Description
001	<a href="#">Y014827</a>			Washer-Center Shaft
002	<a href="#">Y014839</a>			Collar-Drive Shaft
003	<a href="#">Y015629</a>			Bolt, Grinding Chamber
NI	NLA		Not Available	DOWEL PIN
005	<a href="#">Y015902</a>			Spring For Agitator
006	<a href="#">Y052740</a>	<a href="#">62739</a>		Nut, Lock
007	Y056080	<a href="#">6-0560800</a>		Oil
008	200730	<a href="#">22002124</a>		Shaft- Agi
NI	NLA		Not Available	GEAR CASE COVER ASSEMBLY
"	NLA		Not Available	PITMAN WITH WRIST PIN
"	NLA		Not Available	GEAR HOUSING W/STUDS & TUBE
"	NLA		Not Available	PART NOT USED
013	<a href="#">204967</a>			Gear Kit-Power Fin Agitator
NI	NLA		Not Available	COUNTERWEIGHT
015	206602	<a href="#">207843</a>		Lip Seal Repair Kit

016	<a href="#">210054</a>			Pinion
NI	NLA		Not Available	LOCK WASHER
018	<a href="#">210183</a>			Groove Pin
019	<a href="#">210315</a>			Pinion
020	210632	<a href="#">22210632</a>		Gasket
NI	NLA		Not Available	SEGMENT
022	<a href="#">210690</a>			Seal, Rubber
023	<a href="#">211089</a>			Lug, Stop Pulley
024	211090	<a href="#">22003555</a>		Washer, Stop Lug
025	211375	<a href="#">681582</a>		Screw
026	211483	<a href="#">6-2114830</a>		Washer- SP
027	<a href="#">211484</a>			Washer, Lug
028	<a href="#">211486</a>			Screw, 3/8-16 X 1/2 Inch
NI	NLA		Not Available	GROOV-PIN
030	<a href="#">212988</a>			Part Not Used
031	<a href="#">213044</a>			Shaft, Center

