

# Maytag GDG26CD 06 - LINT SCREEN, TUMBLER (FRONT & BACK)

SECTION: LINT SCREEN, TUMBLER, TUMBLER FRONT & BACK  
 MODEL: DE-DG26CA-CD-CT

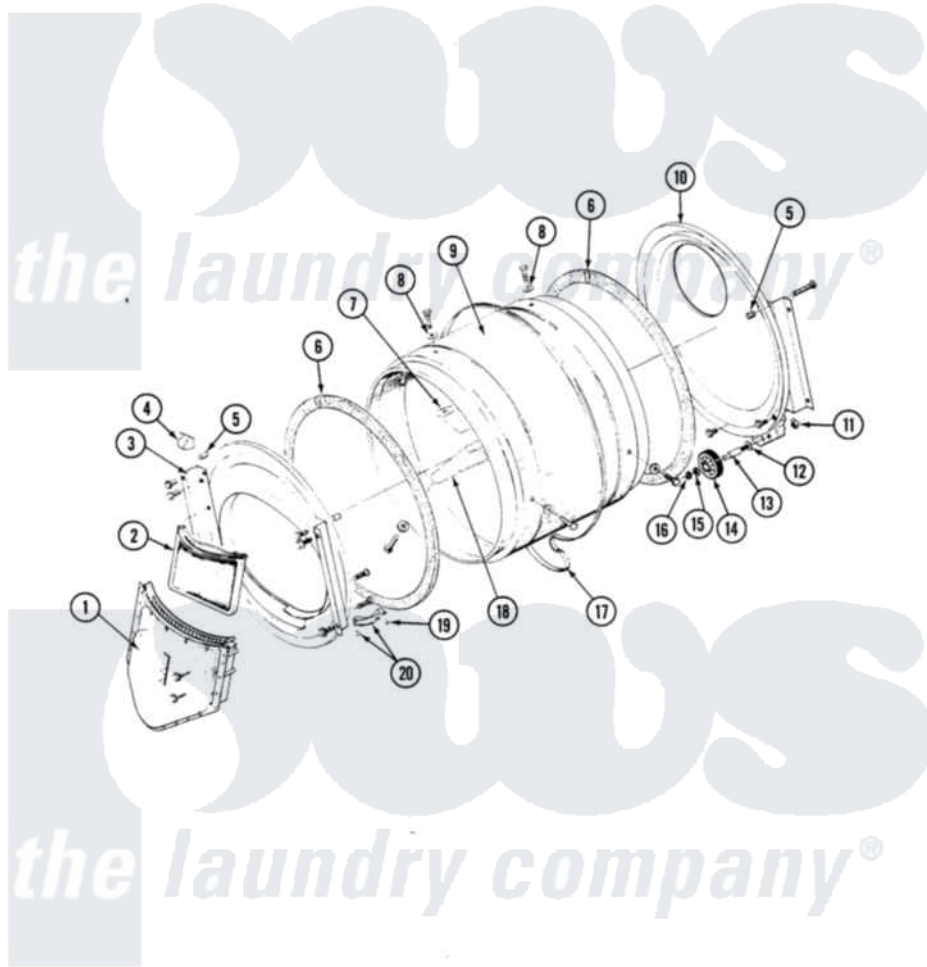

Issue Date: 11/90

26

Maytag [Commercial Maytag GDG26CD Dryer Parts](#) Parts Diagram 06 - LINT SCREEN, TUMBLER (FRONT & BACK)  
 Click on the part number to view part

Item	Original Part Number	Replaced By	Status	Part Description
001	Y307112	<a href="#">33001016</a>		Outlet Duct Assembly
"	Y314110	<a href="#">33002917</a>		Screw, No.10-16
002	307108	<a href="#">33002970</a>		Lint Filte
003	307109	<a href="#">33001179</a>		Front, Tumbler
"	<a href="#">Y313561</a>			Screw---NA
"	NLA		Not Available	SCREW
"	Y310632	<a href="#">1163839</a>		Screw
004	<a href="#">Y310376</a>			Clip, Door Switch Harness
005	NLA		Not Available	COVER, THREAD
006	<a href="#">314820</a>			Seal, Tumbler
007	314803	<a href="#">33001012</a>		Baffle
"	<a href="#">Y310759</a>			Screw, Tumbler Baffles
008	<a href="#">314158</a>			Washer, Baffle To Tumbler
009	306663		Not Available	TUMBLER W/BAFFLES
"	314802		Not Available	TUMBLER W/OUT BAFFLES
010	<a href="#">211294</a>	<a href="#">90767</a>		Screw, 8A X 3/8 HeX Washer Head Tapping

"	Y307114	<a href="#">33001178</a>	Back, Tumbler
"	Y308544	<a href="#">33001178</a>	Back, Tumbler
011	312538	<a href="#">33001443</a>	Nut, Hex
012	Y313347	<a href="#">312535</a>	Washer, Vault Mounting Brk.
013	Y312948	<a href="#">6-3129480</a>	Shaft- Tumbler
014	Y303373	<a href="#">12001541</a>	Drum Roller/Washer Assembly--W
015	<a href="#">312535</a>		Washer, Vault Mounting Brk.
016	410233	<a href="#">9703438</a>	Ring-Retrn
017	<a href="#">Y312959</a>		Poly "V" Belt For Tumbler
018	314804	<a href="#">33001004</a>	Baffle, Tall
"	<a href="#">Y310759</a>		Screw, Tumbler Baffles
019	<a href="#">210720</a>		Rivet, Bearing To Tumbler Fmt
020	<a href="#">306508</a>		Tumbler Bearing Kit ---W

