

Maytag GDG26CS 07 - LINT SCREEN, TUMBLER (FRONT & BACK)

MODEL DE-DG26CS LINT SCREEN, TUMBLER, TUMBLER FRONT & BACK

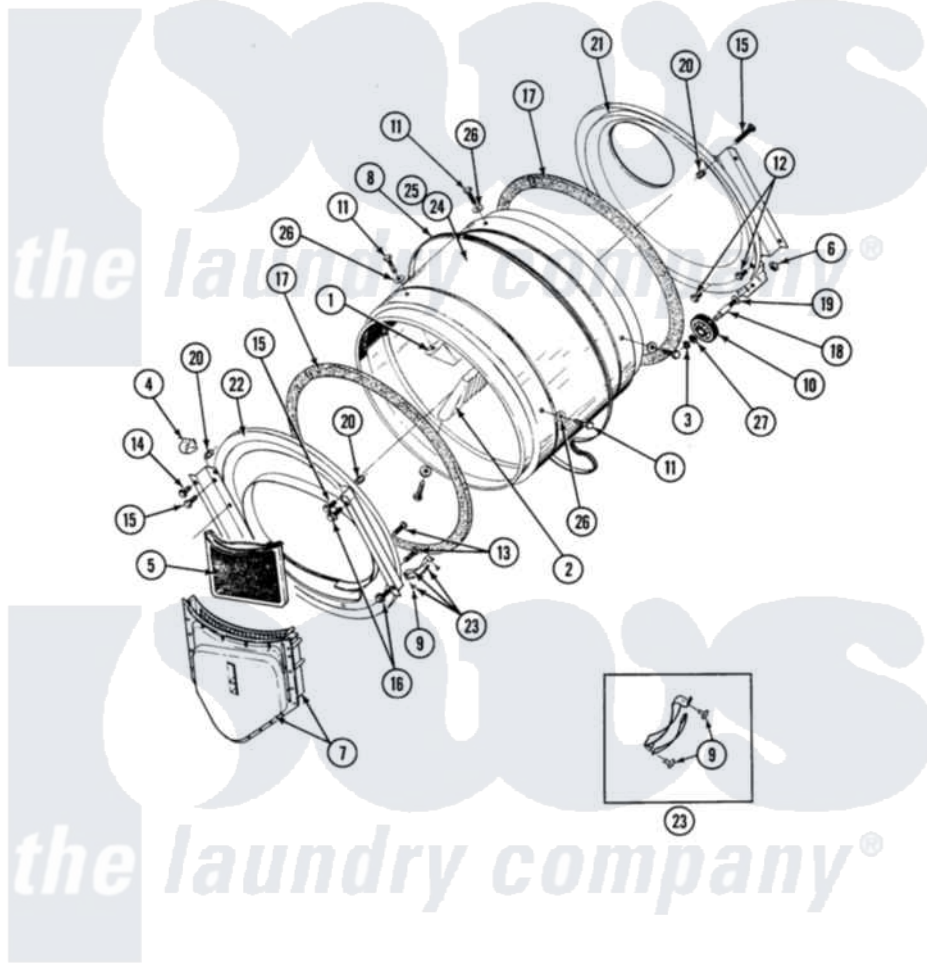

Maytag Commercial Maytag GDG26CS Dryer Parts Parts Diagram 07 - LINT SCREEN, TUMBLER (FRONT & BACK)
 Click on the part number to view part

| Item | Original Part Number | Replaced By | Status | Part Description |
|------|-------------------------|--------------------------|---------------|---|
| 001 | 314803 | 33001012 | | Baffle |
| 002 | 314804 | 33001004 | | Baffle, Tall |
| 003 | 410233 | 9703438 | | Ring-Retrn |
| 004 | Y310376 | | | Clip, Door Switch Harness |
| 005 | 307108 | 33002970 | | Lint Filte |
| 006 | 312538 | 33001443 | | Nut, Hex |
| 007 | Y307112 | 33001016 | | Outlet Duct Assembly |
| 008 | Y312959 | | | Poly "V" Belt For Tumbler |
| 009 | 210720 | | | Rivet, Bearing To Tumbler Frmt |
| 010 | Y303373 | 12001541 | | Drum Roller/Washer Assembly--W |
| 011 | Y310759 | | | Screw, Tumbler Baffles |
| 012 | 211294 | 90767 | | Screw, 8A X 3/8 HeX Washer Head Tapping |
| 013 | Y314110 | 33002917 | | Screw, No.10-16 |
| 014 | Y313561 | | | Screw----NA |
| 015 | NLA | | Not Available | SCREW |

| | | | |
|-----|------------------------|---------------------------|-----------------------------|
| 016 | Y310632 | 1163839 | Screw |
| 017 | 314820 | | Seal, Tumbler |
| 018 | Y312948 | 6-3129480 | Shaft- Tumbler |
| 019 | Y313347 | 312535 | Washer, Vault Mounting Brk. |
| 020 | NLA | Not Available | COVER, THREAD |
| 021 | Y307114 | 33001178 | Back, Tumbler |
| " | Y308544 | 33001178 | Back, Tumbler |
| 022 | 307109 | 33001179 | Front, Tumbler |
| 023 | 306508 | | Tumbler Bearing Kit ----W |
| 024 | 314802 | Not Available | TUMBLER W/OUT BAFFLES |
| 025 | 306663 | Not Available | TUMBLER W/BAFFLES |
| 026 | 314158 | | Washer, Baffle To Tumbler |
| 027 | 312535 | | Washer, Vault Mounting Brk. |

the laundry company[®]

the laundry company[®]

the laundry company[®]