

# Maytag GDG26CS 10 - INLET DUCT, GAS VALVE, CONE & EXTENSION

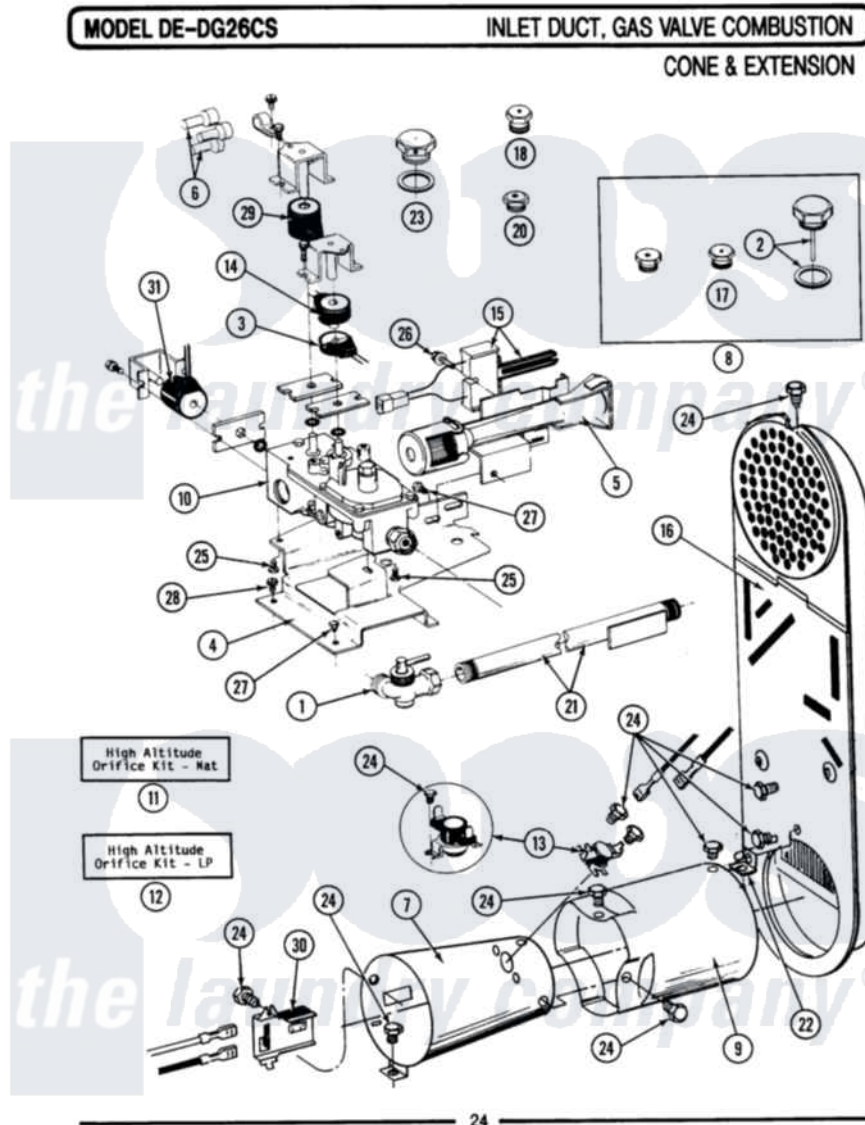

Maytag [Commercial Maytag GDG26CS Dryer Parts](#) Parts Diagram 10 - INLET DUCT, GAS VALVE, CONE & EXTENSION

[Click on the part number to view part](#)

Item	Original Part Number	Replaced By	Status	Part Description
001	<a href="#">Y303349</a>			Angle Shut-Off, Gas Valve
002	NLA		Not Available	SCREW ASSY - BLUE BLOCK OPE
003	<a href="#">305605</a>			Booster Coil
004	<a href="#">312929</a>			Gas Valve Bracket
005	304974	<a href="#">33002793</a>		Burner Assembly
006	311546	<a href="#">911445</a>		Wire Connector
007	<a href="#">Y303368</a>			Cone, Combustion
"	<a href="#">Y308548</a>			Combustion Cone Assembly
008	<a href="#">Y303779</a>			Conversion Kit
009	<a href="#">Y303841</a>			Cone, Extension
010	Y303777	<a href="#">W10116794</a>		Gas Valve
011	NLA		Not Available	WIRE
012	NLA		Not Available	ORIFICE KIT, LP (HIGH ALT.)
013	<a href="#">305169</a>			Thermostat, Hi-Limit Gas
014	<a href="#">305604</a>			Holding Coil

015	304970	<a href="#">4391996</a>	Ignitor
016	<a href="#">307119</a>		Duct, Inlet Assembly
017	NLA	Not Available	INTERNAL ORIFICE (LP)
018	<a href="#">313367</a>		Main Burner Orifice-Int-NAT
019	NLA	Not Available	MAIN BURNER ORIFICE (LP)
020	<a href="#">313366</a>		Main Burner Orifice-Ext-NAT
021	Y303383	<a href="#">33001735</a>	Pipe And Bracket Assembly Series 18 Not Needed Use Vavle
022	<a href="#">Y312890</a>		Retainer, Heater Chamber
023	NLA	Not Available	SCREW ASSEMBLY, LEAK LIMIT
024	<a href="#">211294</a>	<a href="#">90767</a>	Screw, 8A X 3/8 HeX Washer Head Tapping
025	NLA	Not Available	SCREW, HEX HD No.8 X 3/8 INCH
026	<a href="#">304971</a>		Screw Note: Screw, Igniter
027	Y310632	<a href="#">1163839</a>	Screw
028	<a href="#">Y313561</a>		Screw---NA
029	<a href="#">305603</a>		Secondary Coil
030	Y303377	<a href="#">338906</a>	Radiant, Sensor
031	<a href="#">Y304626</a>		Side Coil

