

# Maytag LA26CD 06 - TUB

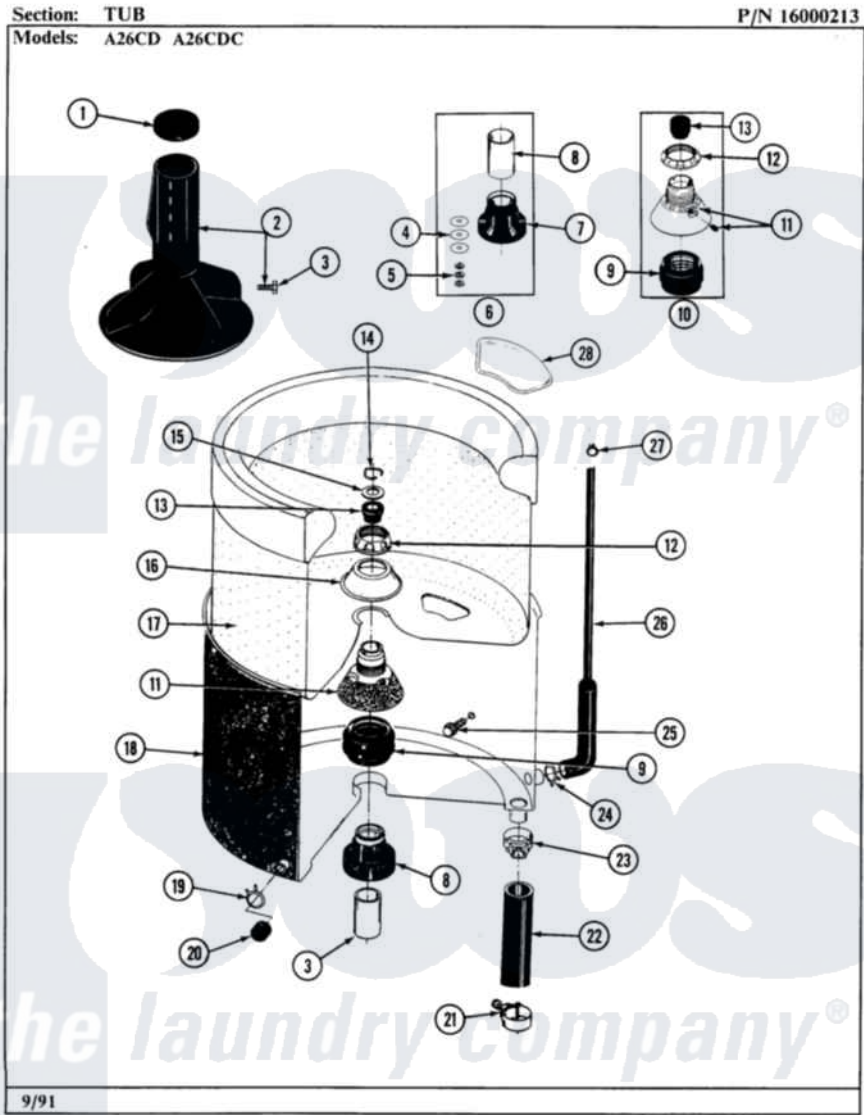

12

Maytag [Commercial Maytag LA26CD Washer Parts](#) Parts Diagram 06 - TUB  
Click on the part number to view part

Item	Original Part Number	Replaced By	Status	Part Description
001	<a href="#">215532</a>			Cap, Agitator
002	207119	<a href="#">207228</a>		Agitator W/Lock Screw
003	206478		Not Available	SCREW & WASHER FOR AGITATOR
004	<a href="#">211100</a>			Washer, Outer Tub
005	<a href="#">Y054867</a>			Washer, Lock
006	204013	<a href="#">6-2040130</a>		Tub Bearin
007	200824	<a href="#">6-2040130</a>		Tub Bearin
008	<a href="#">211130</a>			Bearing Liner, Tub Bearing
009	201537	<a href="#">6-2095720</a>		Mounting S
010	204012	<a href="#">6-2095720</a>		Mounting S
011	202521	<a href="#">6-2095720</a>		Mounting S
012	211047	<a href="#">6-2110472</a>		Nut- Clamp
013	Y0A4298	<a href="#">6-0A57420</a>		Seal- Agitator
014	<a href="#">Y015667</a>			Retaining Ring
015	<a href="#">Y015666</a>			Washer, Retaining -
016	<a href="#">211210</a>			Washer, Clamping Nut

017	207831		Not Available	TUB, INNER (W/PLUG)
018	<a href="#">205484</a>			Tub, Outer Part Not Used
019	214739	<a href="#">596669</a>		Clamp, Manifold
020	<a href="#">214725</a>			Cap For Spout-Outer Tub
021	202574	<a href="#">3367052</a>		Clamp, Hose
022	<a href="#">213045</a>			Hose, Outer Tub Part Not Used
023	200900	<a href="#">616099</a>		Clamp
024	<a href="#">211641</a>			Clamp, 1-1/16"
025	<a href="#">200744</a>	<a href="#">W10175939</a>		Bolt
"	<a href="#">205254</a>	<a href="#">W10175938</a>		Bolt
026	212942	<a href="#">22001619</a>		Tube, Water Level Switch
027	410296	<a href="#">596669</a>		Clamp, Manifold
028	<a href="#">215980</a>			Plug, Filter Hole

