

Maytag LDGS30PC1 04 - DUAL CTRL MICROPROCESSOR (DMC) CNTRL BOX

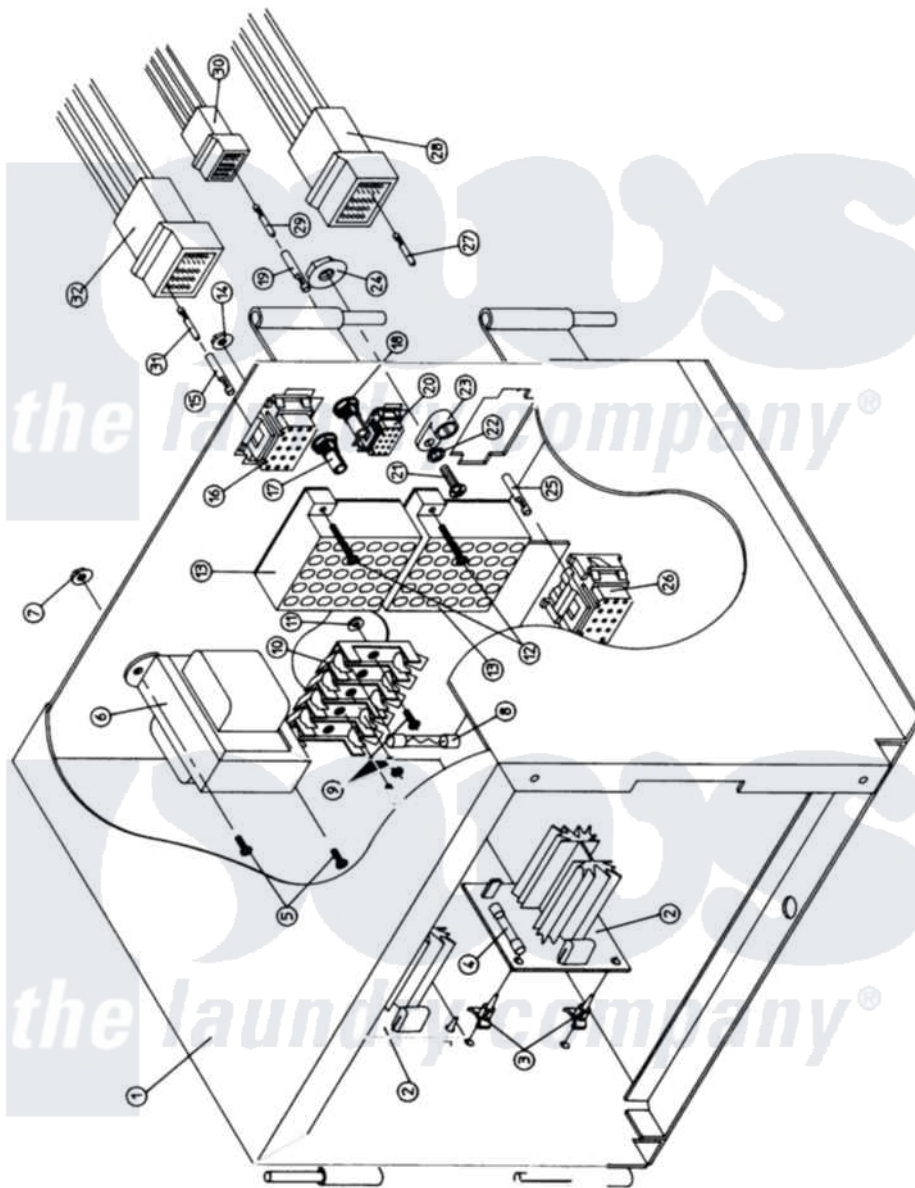

Maytag [Commercial Maytag LDGS30PC1 Dryer Parts](#) Parts Diagram 04 - DUAL CTRL MICROPROCESSOR (DMC) CNTRL BOX

[Click on the part number to view part](#)

| Item | Original Part Number | Replaced By | Status | Part Description |
|------|----------------------|---------------------------|---------------|---|
| 000 | W10124350 | | Not Available | ORDER PARTS FROM AMERICAN DRYER CORP AT 508-678-9000 |
| 001 | A800192 | | Not Available | DMC CONTROL BOX ASSY COMPLETE SPECIFY COLOR WHEN ORDERING |
| 002 | A137152 | | Not Available | SOLID STATE RELAY BOARD 1HP |
| 003 | A137013 | 137013 | | Pc Bd Nylo |
| 004 | A136058 | 136058 | | 25A 125V |
| 005 | A150106 | 150106 | | 8-32 X 1 |
| 006 | A141403 | | Not Available | TRANSFORMER (24 VAC) (FOR MICROPROCESSOR MODELS) |
| 007 | A151001 | W10146764 | | 8-32 Pal N |
| 008 | A136057 | W10146739 | | 0.5 A 250 |
| 009 | A150106 | 150106 | | 8-32 X 1 |

| | | | | |
|-----|---------|---------------------------|---------------|---------------------------|
| 010 | A136009 | | Not Available | 5 POSITION FUSE BLOCK |
| 011 | A151001 | W10146764 | | 8-32 Pal N |
| 012 | A150002 | 150002 | | 6-32 X 1 |
| 013 | A120715 | W10146700 | | 30 Pos Ter |
| 014 | A151000 | WH12X195 | | Switch Assembly |
| 015 | A122705 | 122705 | | Umnl Sok 2 |
| 016 | A122626 | 122626 | | 15P Umnl C |
| 017 | A122729 | | Not Available | TRANSMIT CONNECTOR (GREY) |
| 018 | A122728 | | Not Available | RECEIVER CONNECTOR (BLUE) |
| 019 | A122705 | 122705 | | Umnl Sok 2 |
| 020 | A122631 | 122631 | | 06P Umnl C |
| 021 | A150111 | 150111 | | 1 4-20 X 1 |
| 022 | A153007 | 153007 | | 1 4 Split |
| 023 | A121010 | 121010 | | 14-4 Termi |
| 024 | A152014 | 152014 | | 1 4-20 Ser |
| 025 | A122705 | 122705 | | Umnl Sok 2 |
| 026 | A122626 | 122626 | | 15P Umnl C |
| 027 | A122704 | 122704 | | Umnl Pin 2 |
| 028 | A122625 | 122625 | | 15 Pin Umn |
| " | A137025 | 137025 | | 6-15 Positive |
| 029 | A122704 | 122704 | | Umnl Pin 2 |
| 030 | A122630 | 122630 | | 06P Umnl P |
| " | A137025 | 137025 | | 6-15 Positive |
| 031 | A122704 | 122704 | | Umnl Pin 2 |
| 032 | A122625 | 122625 | | 15 Pin Umn |
| " | A122800 | 122800 | | M R EXTRAC |
| " | A122801 | W10146716 | | Mate-N-Loc |
| " | A137025 | 137025 | | 6-15 Positive |

