

# Maytag MAH22PDAGW0 04 - METER CASE PARTS

## METER CASE PARTS

For Model: MAH22PDAGW0  
(White)

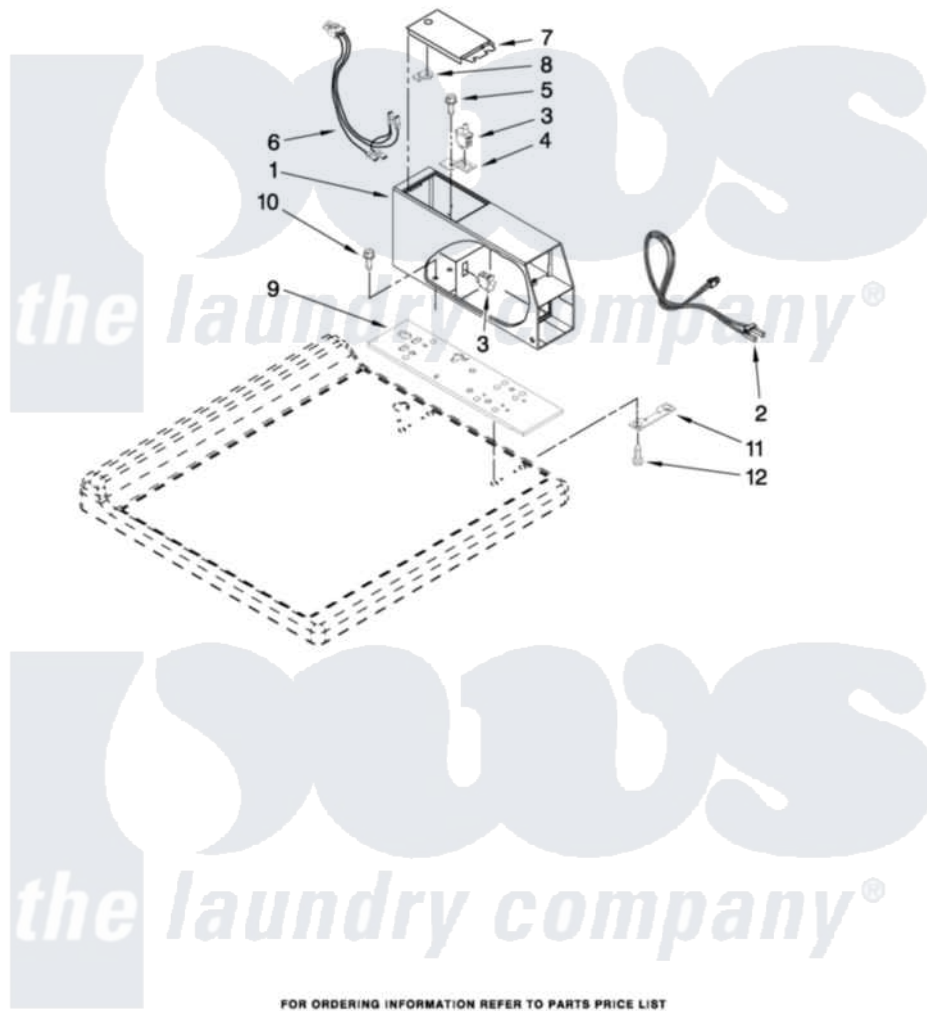

W10260629

FOR ORDERING INFORMATION REFER TO PARTS PRICE LIST

6

Maytag Commercial Maytag MAH22PDAGW0 Washer Parts Parts Diagram 04 - METER CASE PARTS

Click on the part number to view part

Item	Original Part Number	Replaced By	Status	Part Description
1	<a href="#">W10171128</a>			Meter Case
2	<a href="#">W10247388</a>			Coin Optic Sensor Assembly Coin 2
"	<a href="#">W10247389</a>			Sensor
3	<a href="#">W10131838</a>			Switch, Vault And Service Door
4	<a href="#">W10133508</a>			Bracket, Service Switch
5	<a href="#">W10139210</a>			Screw, 8-18 X 5/16
6	<a href="#">W10139456</a>			Wire Harness, Sensor Switch
7	<a href="#">3351136</a>			Service Door Assembly
8	<a href="#">W10145154</a>			Cam, Commercial Lock
9	<a href="#">W10137448</a>			Cushion, Meter Case
10	<a href="#">3349065</a>			Bolt, Meter Case Mounting
11	3347825	<a href="#">3353813</a>		Plate, Mounting
12	<a href="#">98445</a>			Screw, 10-16 X 3/4