

Maytag MAT10PDAAL 09 - CONTROL PANEL

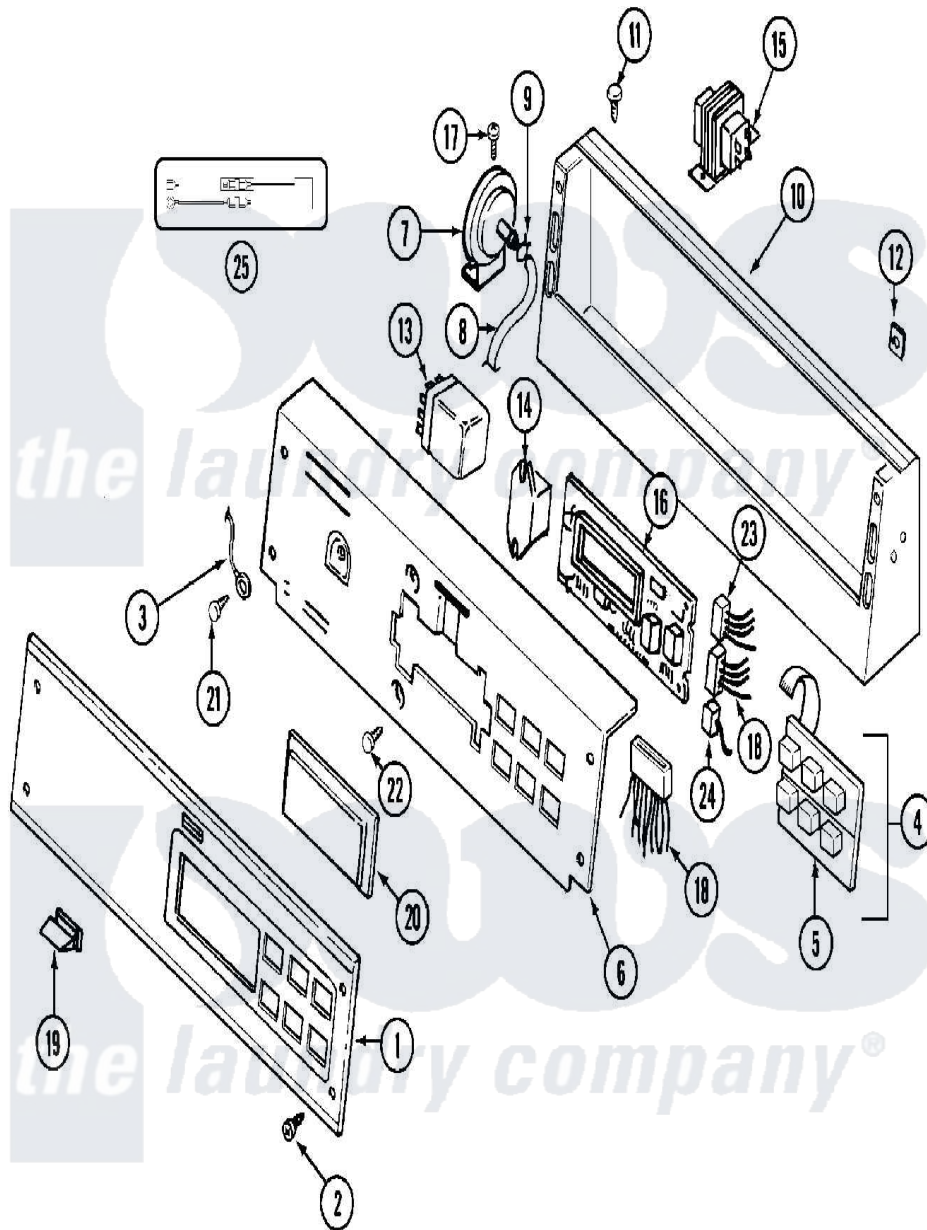

Maytag [Commercial Maytag MAT10PDAAL Washer Parts](#) Parts Diagram 09 - CONTROL PANEL
 Click on the part number to view part

| Item | Original Part Number | Replaced By | Status | Part Description |
|------|--------------------------|---------------------------|---------------|--------------------------------------|
| 001 | NLA | | Not Available | PANEL, CONTROL |
| 002 | 215506 | | | Screw, Control Panel Overlay |
| 003 | 204807 | | | Ground Wire, Supp. Plte To Top Cover |
| " | NLA | | Not Available | WIRE, GROUND |
| 004 | 206808 | W10135389 | | Push Button And Switch Assembly |
| " | 215526 | | | Screw, Circuit Board |
| 005 | 215517 | W10131113 | | Push Button |
| 006 | 215516 | | | Plate, Back-Up |
| " | NLA | | Not Available | (ALM) |
| 007 | 22001308 | | | Switch, Water Level |
| 008 | 212942 | 22001619 | | Tube, Water Level Switch |
| 009 | 410296 | 596669 | | Clamp, Manifold |
| 010 | 206780 | | | Control Cover Assembly |
| " | 206780L | 206780 | | Control Cover Assembly |
| 011 | 212276 | W10116760 | | Screw |

| | | | |
|-----|--------------------------|---------------------------|--------------------------------------------|
| 012 | 215003 | | Fastener, Panel And Bracket |
| 013 | 206421 | | Relay, Motor Reversing |
| 014 | 206824 | W10133335 | Relay, Motor |
| " | 212949 | 22001866 | Screw, Relay |
| 015 | 207766 | | Transformer |
| " | 211294 | 90767 | Screw, 8A X 3/8 HeX Washer Head Tapping |
| 016 | 207767 | 22002954 | Deflector, Water |
| " | 33001249 | | Battery, Control Board |
| " | 912077 | | Locknut, Reader Harness |
| " | NLA | Not Available | BOARD, CONTROL |
| " | NLA | Not Available | SUPPORT, BATTERY |
| " | Y215513 | | Standoff, Circuit Board |
| 017 | 211294 | 90767 | Screw, 8A X 3/8 HeX Washer Head Tapping |
| 018 | 314531 | | Connector, Edgeborard |
| " | NLA | Not Available | WIRE HARNESS, MAIN --N |
| " | Y312953 | | Terminal, Edgeboard |
| 019 | 214610 | | Bumper, Lid |
| 020 | 33001208 | | Cover, Display |
| 021 | 210186 | 3370225 | Screw |
| 022 | 215527 | W10140652 | Screw, 6-20 X 1/2 |
| 023 | 206799 | | Optic Switch Assembly |
| " | NLA | Not Available | CONNECTOR, EDGEBOARD--NA |
| 024 | 208045 | | Harness, Wire Sensor Switch To Circuit Brd |
| " | 22001361 | | Connector, Edgeboard |
| 025 | NLA | Not Available | SURGE SUPPRESSOR KIT |

the laundry company[®]

the laundry company[®]