

# Maytag MAT10PDEGW 01 - CONTROL PANEL

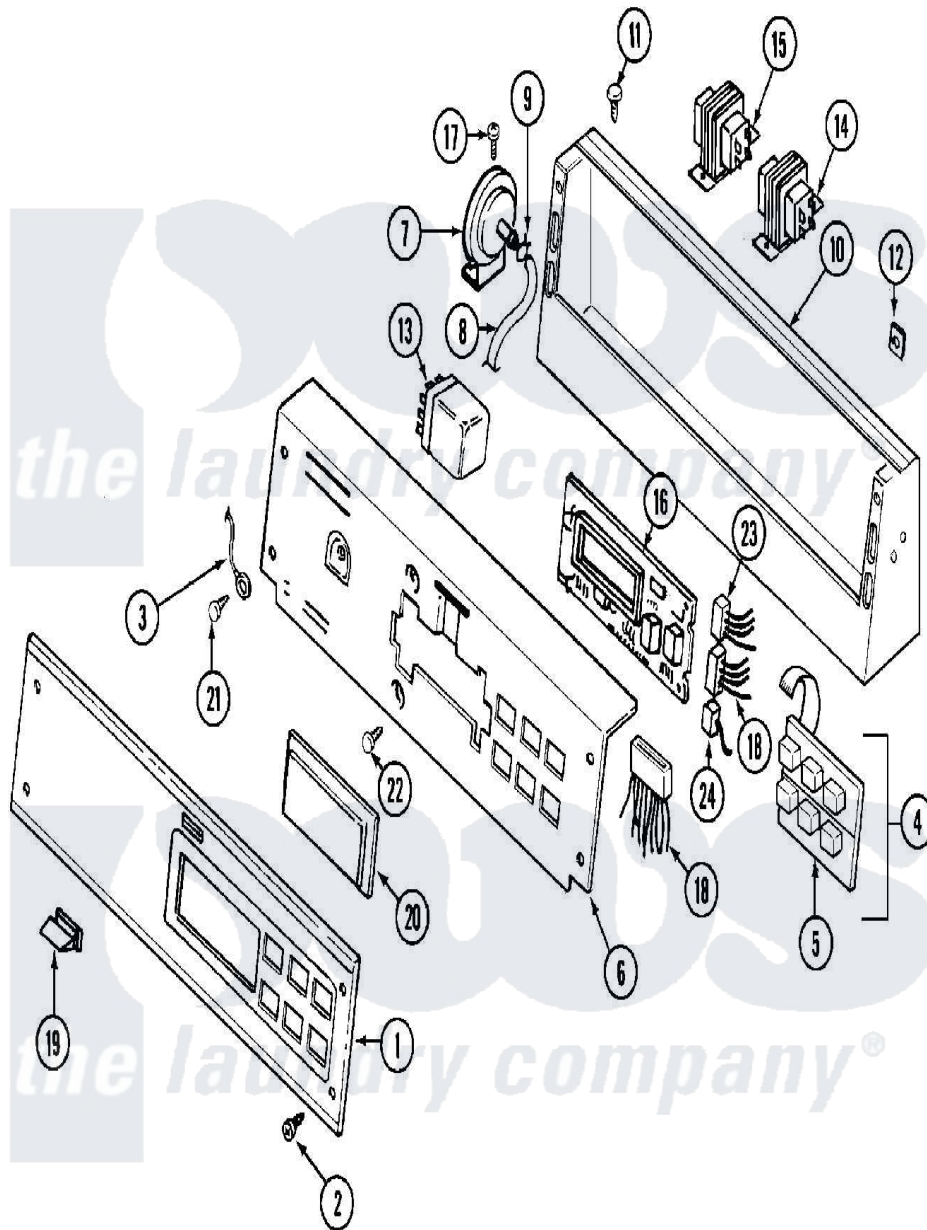

Maytag [Commercial Maytag MAT10PDEGW Washer Parts](#) Parts Diagram 01 - CONTROL PANEL  
 Click on the part number to view part

| Item | Original Part Number     | Replaced By               | Status        | Part Description                     |
|------|--------------------------|---------------------------|---------------|--------------------------------------|
| 001  | NLA                      |                           | Not Available | PANEL, CONTROL (W/LENS)              |
| 002  | <a href="#">215506</a>   |                           |               | Screw, Control Panel Overlay         |
| 003  | <a href="#">204807</a>   |                           |               | Ground Wire, Supp. Plte To Top Cover |
| 004  | 206808                   | <a href="#">W10135389</a> |               | Push Button And Switch Assembly      |
| "    | 215527                   | <a href="#">W10140652</a> |               | Screw, 6-20 X 1/2                    |
| 005  | 215517                   | <a href="#">W10131113</a> |               | Push Button                          |
| 006  | <a href="#">215516</a>   |                           |               | Plate, Back-Up                       |
| "    | <a href="#">22001513</a> |                           |               | Bracket, Back                        |
| 007  | <a href="#">22001308</a> |                           |               | Switch, Water Level                  |
| 008  | 212942                   | <a href="#">22001619</a>  |               | Tube, Water Level Switch             |
| 009  | 410296                   | <a href="#">596669</a>    |               | Clamp, Manifold                      |
| 010  | <a href="#">206780</a>   |                           |               | Control Cover Assembly               |
| 011  | 212276                   | <a href="#">W10116760</a> |               | Screw                                |
| 012  | <a href="#">215003</a>   |                           |               | Fastener, Panel And Bracket          |
| 013  | <a href="#">206421</a>   |                           |               | Relay, Motor Reversing               |

|     |                          |                          |  |
|-----|--------------------------|--------------------------|--|
| "   | 212949                   | <a href="#">22001866</a> | Screw, Relay                               |
| "   | <a href="#">22001418</a> |                          | Plate, Relay                               |
| 014 | <a href="#">211251</a>   |                          | Screw, Transformer                         |
| "   | <a href="#">22001417</a> |                          | Transformer                                |
| "   | <a href="#">22001419</a> |                          | Nut, Transformer                           |
| 015 | <a href="#">207766</a>   |                          | Transformer                                |
| "   | <a href="#">211294</a>   | <a href="#">90767</a>    | Screw, 8A X 3/8 HeX Washer Head Tapping    |
| 016 | 207767                   | <a href="#">22002954</a> | Deflector, Water                           |
| "   | <a href="#">33001249</a> |                          | Battery, Control Board                     |
| "   | <a href="#">912077</a>   |                          | Locknut, Reader Harness                    |
| "   | NLA                      | Not Available            | BOARD, CONTROL                             |
| "   | NLA                      | Not Available            | SUPPORT, BATTERY                           |
| "   | <a href="#">Y215513</a>  |                          | Standoff, Circuit Board                    |
| 017 | <a href="#">211294</a>   | <a href="#">90767</a>    | Screw, 8A X 3/8 HeX Washer Head Tapping    |
| 018 | <a href="#">314531</a>   |                          | Connector, Edgeboard                       |
| "   | NLA                      | Not Available            | WIRE HARNESS, MAIN---NA                    |
| "   | <a href="#">Y312953</a>  |                          | Terminal, Edgeboard                        |
| 019 | <a href="#">214610</a>   |                          | Bumper, Lid                                |
| 020 | <a href="#">33001208</a> |                          | Cover, Display                             |
| 021 | 210186                   | <a href="#">3370225</a>  | Screw                                      |
| 022 | <a href="#">215526</a>   |                          | Screw, Circuit Board                       |
| 023 | <a href="#">206799</a>   |                          | Optic Switch Assembly                      |
| "   | 207953                   | <a href="#">22001260</a> | Optic Switch Assembly                      |
| "   | <a href="#">314529</a>   |                          | Connector, Edgeboard                       |
| "   | NLA                      | Not Available            | CONNECTOR, EDGEBOARD (6 WIRE)              |
| 024 | <a href="#">208045</a>   |                          | Harness, Wire Sensor Switch To Circuit Brd |
| "   | <a href="#">22001361</a> |                          | Connector, Edgeboard                       |

