

Maytag MDG17CSBGW2 02 - CABINET PARTS

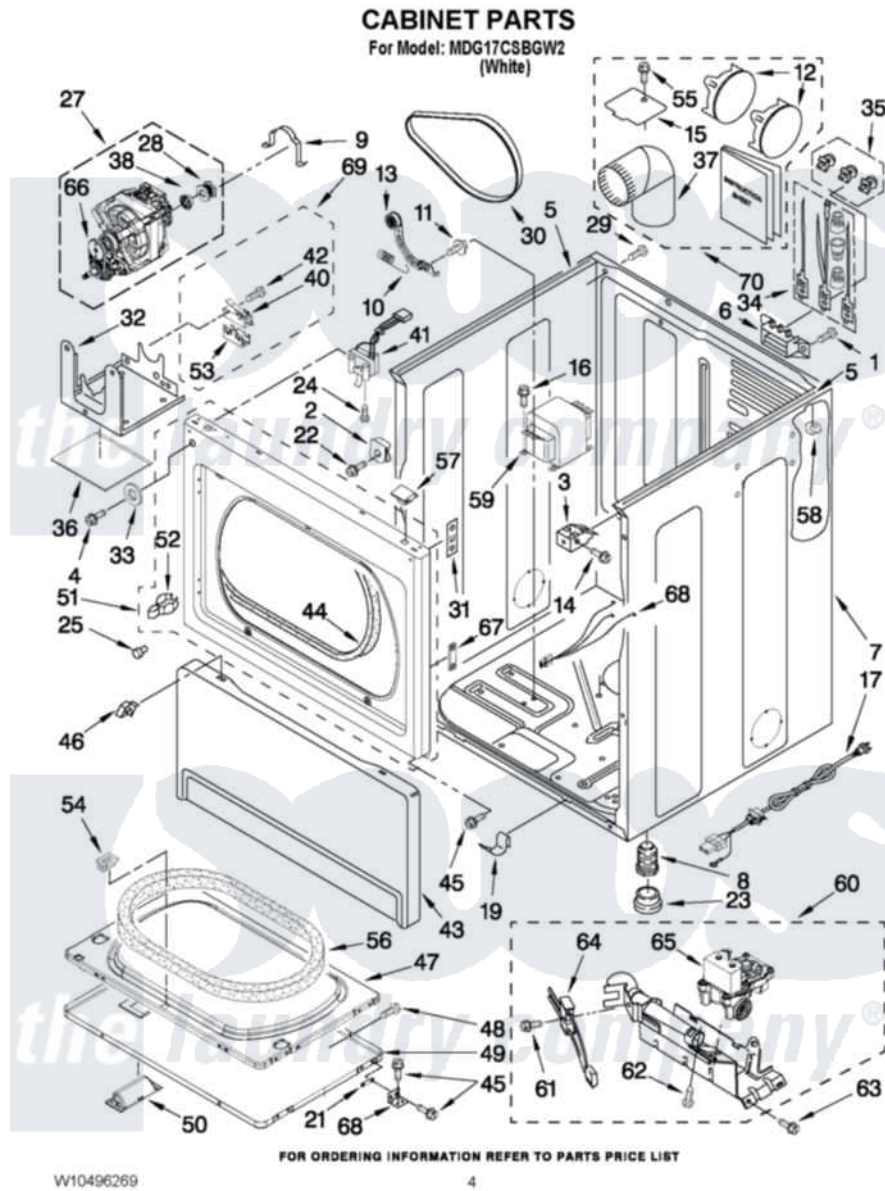

Maytag [Commercial Maytag MDG17CSBGW2 Dryer Parts](#) Parts Diagram 02 - CABINET PARTS
Click on the part number to view part

Item	Original Part Number	Replaced By	Status	Part Description
1	3393008	308685		Side Trim)
2	W10131123			NUT, 8 U-Type
3	3391846			Clip, Front Panel
4	3400077			Screw, 10-16 X 1/2
5	8318396			Foam-Seal
6	3397659			Block, Terminal
7	8310656			Cabinet
8	3392100	49621		Feet-Leveling
NI	279810			Foot-Optional
9	660658			Clamp, Motor Mounting 343481 685441
10	3387374			Spring, Idler
11	3389420			Retainer-Idler 1/4-20 X 1/16
12	697750	W10470674		Dryer Exhaust Kit
13	W10344192			Idler Assembly
14	3391915	681615		Screw
15	3394331			Plate Cover

16	3400000		Screw, 10-24 X 3/8
17	W10476824		Cord, Power
NI	N/P	Not Available	PARTS NOT SHOWN
"	W10446855		10A Cord Lock
"	W10476818		10A Cord Adapters
"	W10476822		10A Cord Adapters:
"	W10476820		10A Cord Adapters:
19	W10291934		Clip
21	W10279703		Hinge And Pin Assembly
22	W10131119		Screw, 8-18 X 5/16
23	3391943		Boot, Foot
24	697773	3395530	Screw
25	693152		Bumper, Console
27	W10289662	W10416574	Motor-Drive
28	W10167237		Pulley
29	8533974	4331106	Screw, No.10-32 X 7/16
30	W10131172		Belt, Drive
31	3390902		Clip, Door Hinge
32	W10135695		Bracket, Motor
33	W10223794		Washer
34	279318		Terminal Tinned And Brass Panel
35	279393		Terminal Block Screw Kit
36	W10212660		Pad, Sound Dampening
37	279731	49026	4" - 90° Elbow
38	3393657		Restrainer, Belt
40	W10410873		Assembly, Switch And Actuator
41	W10237959		Door Switch Assembly
42	3400934		Assembly, Screw And Insulator
43	697215	3406797	Toe Panel
44	3387242		Seal, Front Panel
45	342055	488627	Screw
46	3388229		Retainer, Toe Panel
47	W10323061		Door, Rear
48	W10080300		Screw, 8-18 X 3/8
49	W10322546		Door, Front
50	W10116360		Handle, Door
51	W10192882	W10242810	Panel
52	696144	279570	Latch
53	8564011		Bracket-Switch
54	3392538	279570	Latch
55	3390647	488729	Screw
56	3390735		Seal, Door
57	345670		Lock, Top
58	90406		Cage Nut, 5/16-18
59	3977633		Autotransformer
60	W10469829	Not Available	BURNER ASSEMBLY 50 HZ. (REFER TO PAGE 8 & 9 FOR FURTHER BREAKDOWN)
61	3393909		Screw, 8-32 X 7/8
62	W10080630	3387057	Screw, 10-16 X 1/2 Orifice, Burner
63	3390647	488729	Screw

64	686590	279311	Ignitor
65	W10304603		Valve, Gas 60 Hz
66	3405160		Belt, Drive
67	W10191265		Plug, Hinge Screw Front Panel
68	W10250903		Transformer Jumper
69	W10259136		Switch, Assembly
NI	279818	W10470674	Dryer Exhaust Kit

