

Maytag MDG26CSABG 04 - CS CONTROL CENTER

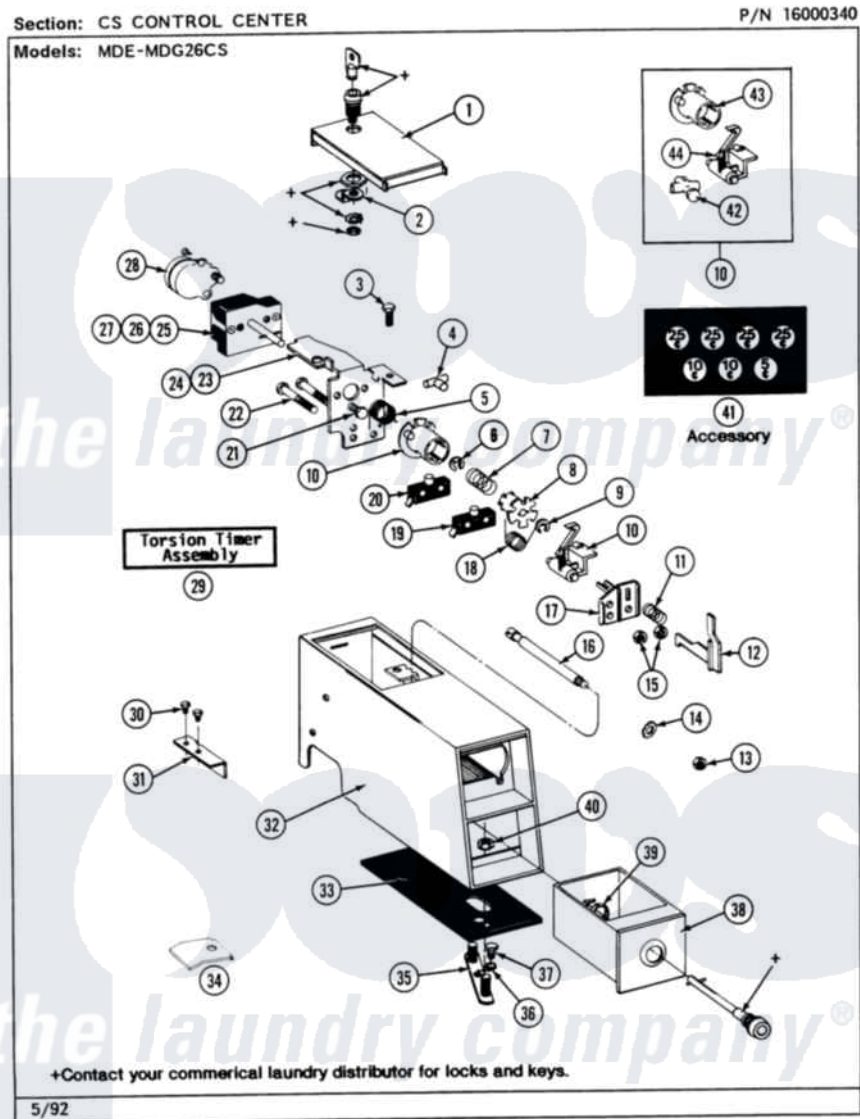

14

Maytag [Commercial Maytag MDG26CSABG Dryer Parts](#) Parts Diagram 04 - CS CONTROL CENTER
Click on the part number to view part

Item	Original Part Number	Replaced By	Status	Part Description
001	203188		Not Available	TIMER ACCESS DOOR (WHT)
"	203188L		Not Available	ACCESS DOOR-ALMOND
"	203188M		Not Available	ACCESS DOOR-HARVEST WHEAT
002	213750	W10133266		Cam-Lock
003	211168	W10139210		Screw, 8-18 X 5/16
004	314335			Peg, Tine Adjustment
005	314331			Spring, Torsion Return
006	Y312270			Clip, Spring Retainer
007	211065			Spring, Index Wheel
008	314337	33002968		Slider
009	211790			Lock Ring For Timer Shaft
010	306104			Actuator Switch Kit
011	NLA		Not Available	HELICAL SPRING ----N
012	314337	33002968		Slider
013	Y052721			Nut, Terminal Block Plate

014	910387		Lockwasher, Vault Assembly
015	Y052634	701719	Nut, Hex
016	215559		Bolt, Coin Slide Locking
017	314339		Switch And Slider Bracket
018	314332		Spring, Actuator
019	305798	Not Available	BYPASS SWITCH FOR MOTOR
020	Y305799		Bypass Switch For Heater
021	910708	488234	Screw 8-32 X 1/4
022	NLA	Not Available	SCREW
023	314333		Timer Mounting Bracket
024	NLA	Not Available	INSTRUCTION LABEL
025	305796		Timer
026	305813		Part Not Available Part Not Used
027	305800		Wire Harness For Timer
028	305870		Timer Motor
029	305797		Torsion Timer Assembly Complete
030	212707	3196385	Screw
031	314334		Bracket For Coin Slide
032	206956	22001405	Case, Coin Slide
"	206956L	22001405	Case, Coin Slide
"	206956M	22001405	Case, Coin Slide
033	214660		Gasket, Control Center
034	NLA	Not Available	STOP, TIMER MECHANISM
035	NLA	Not Available	MTG. STRAP---NA
036	910309		Washer, Mounting Strap
037	211294	90767	Screw, 8A X 3/8 HeX Washer Head Tapping
038	205423	208883	Coin Box K
"	205423L	208883	Coin Box K
"	205423M	208883	Coin Box K
039	212328	W10139762	Hex Nut, 3/4-27
040	Y052740	62739	Nut, Lock
041	214648		Decal, Coinage
042	314547	Y308109	Slide And Adj. Return Bracket
043	314546		Wheel, Index
044	314548	33002967	Actuator, Switch

