

Maytag MDG26CSAGL 05 - FRONT PANEL

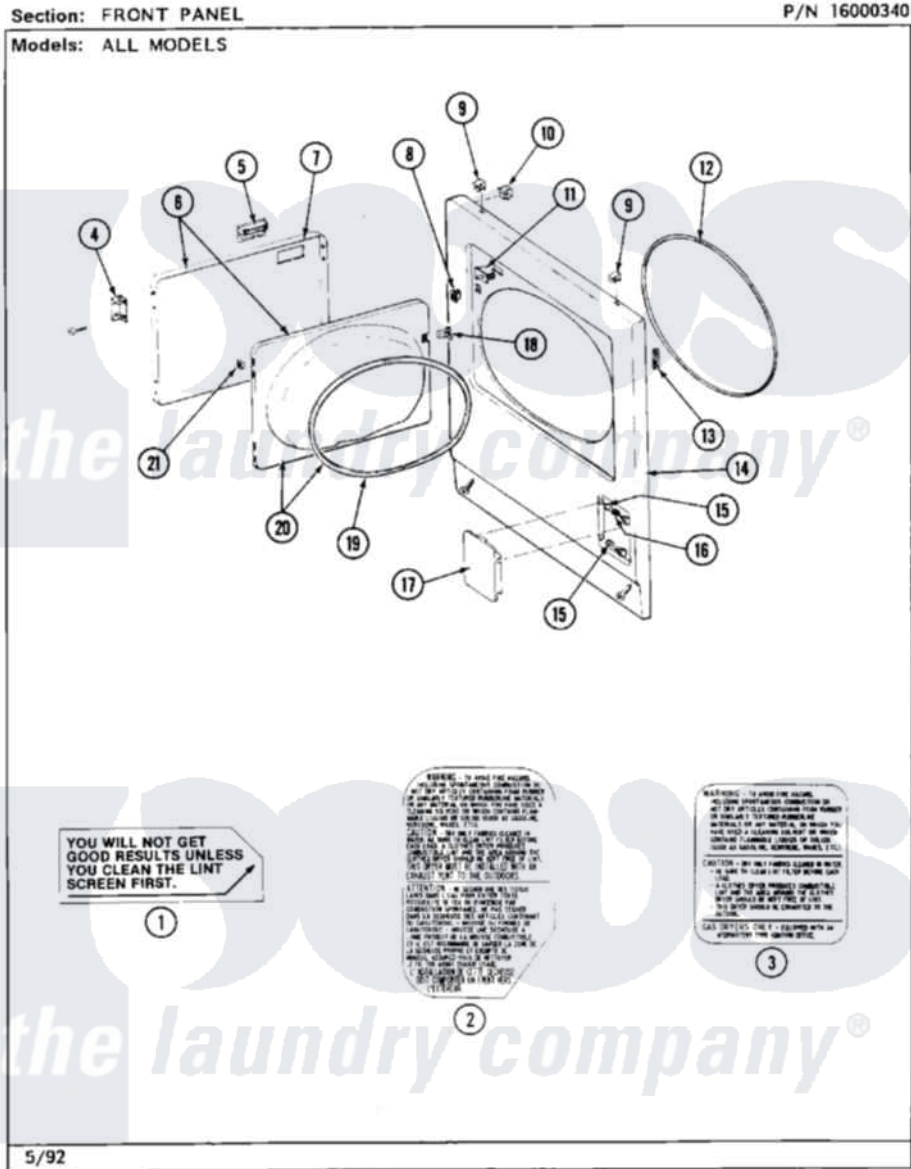

24

Maytag [Commercial Maytag MDG26CSAGL Dryer Parts](#) Parts Diagram 05 - FRONT PANEL
Click on the part number to view part

| Item | Original Part Number | Replaced By | Status | Part Description |
|------|-------------------------|--------------------------|---------------|--------------------------------|
| 001 | Y313340 | | | LABEL, LINT SCREEN INSTRUCTION |
| 002 | 314941 | | Not Available | LABEL, INSTRUCTION |
| 003 | 314942 | | | INSTRUCTION LABEL |
| " | NLA | | Not Available | INSTRUCTION LABEL |
| 004 | 307099 | 33001230 | | Hinge, Door |
| " | Y314062 | | | Screw, Door Hinge And Panel |
| 005 | 312960 | 489355 | | Screw, 8 X 1/2 |
| " | 314946 | | | Handle White |
| " | 314972 | | | Handle Door ALM |
| " | NLA | | Not Available | (H. WHEAT) |
| 006 | NLA | | Not Available | (ALM) |
| " | Y307111 | | Not Available | DOOR ASSY. COMPLETE (WHT) |
| 007 | 314966 | | | Panel, Outer |
| " | NLA | | Not Available | (ALM) |
| 008 | 306436 | | | Door Latch Kit--W |

| | | | |
|-----|-------------------------|---------------------------|--|
| 009 | 212982 | 22001650 | Fastener, Spring |
| 010 | Y310376 | | Clip, Door Switch Harness |
| 011 | Y305753 | W10169313 | Switch-Dor |
| 012 | 314937 | | Seal, Front Panel |
| 013 | Y313907 | | Fastener, Twin |
| 014 | 204439 | | Screw And Fstner Assembly |
| " | 307998L | | Front Panel----NA |
| " | NLA | Not Available | FRONT PANEL ASSY. (WHT) |
| 015 | 212949 | 22001866 | Screw, Relay |
| " | NLA | Not Available | BUSHING, ACCESS STUD |
| 016 | 312369 | | Sleeve, Access Panel Stud Part Not Used |
| 017 | NLA | Not Available | ACCESS DOOR (WHT) |
| 018 | 314936 | 33001305 | Strike, Door |
| " | 314944 | 33001305 | Strike, Door |
| 019 | 314935 | 33001192 | Seal, Door |
| 020 | 307098 | Not Available | DOOR, INNER (W/SEAL) |
| 021 | Y313910 | | Clip, Door Liner To Outer Panel |

