

Maytag MFR35MCAVS 20 - WATER VALVE & REAR PANEL (SERIES 11)

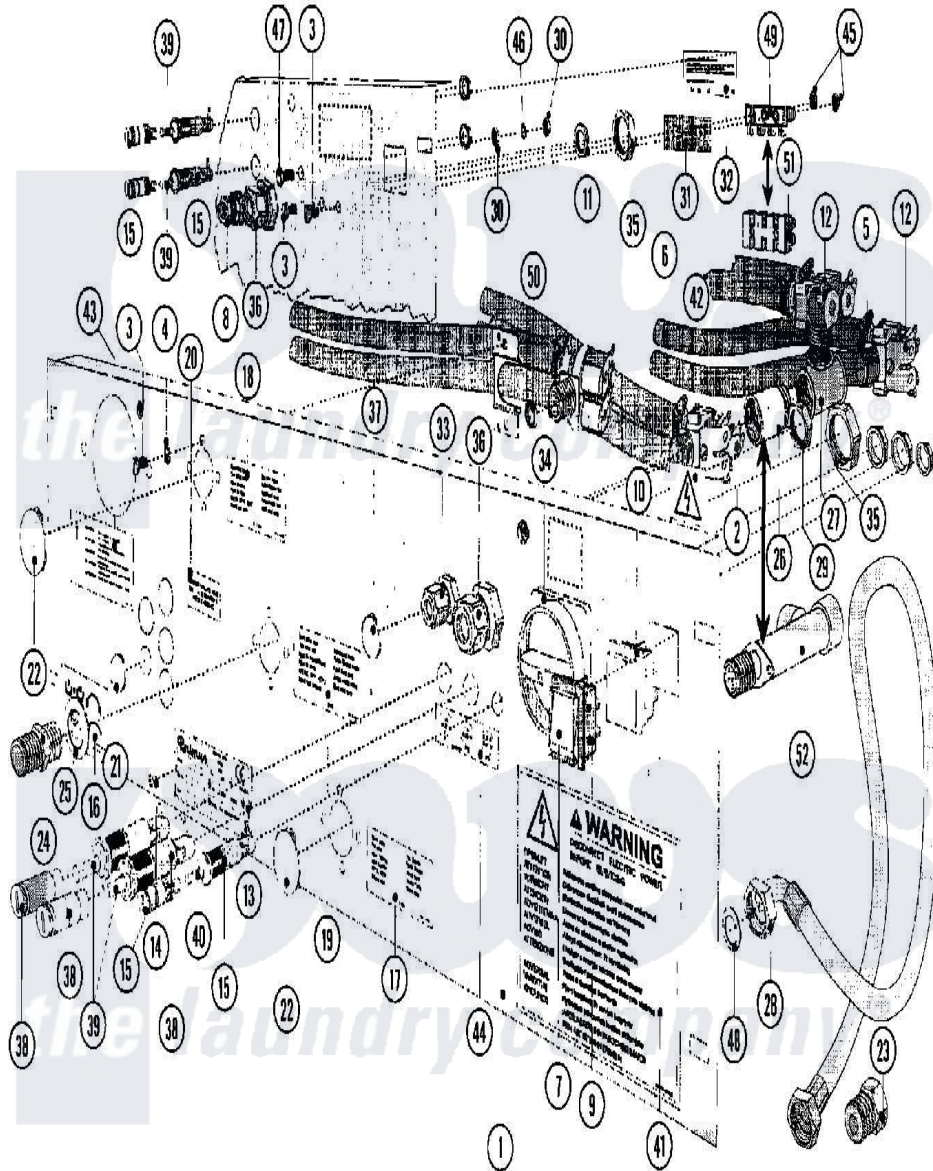

Maytag Commercial Maytag MFR35MCAVS Washer Parts Parts Diagram 20 - WATER VALVE & REAR PANEL (SERIES 11)

Click on the part number to view part

| Item | Original Part Number | Replaced By | Status | Part Description |
|------|--------------------------|--------------------------|---------------|-------------------------------|
| 001 | 23002909 | 23003683 | | Bridge, Rear |
| 002 | 23001533 | | | Valve, Three-Way |
| 003 | 23002423 | 23001361 | | Bolt |
| 004 | 23002111 | 23001013 | | Lock Washer External Teeth M4 |
| 005 | 23001506 | 596669 | | Clamp, Manifold |
| 006 | 23001507 | | | Waterhose |
| 007 | 23001532 | | | Cover, Button |
| 008 | 23001453 | | | Nut, Swivel |
| 009 | 23001529 | | | Button |
| 010 | 23001452 | | | Square Plug |
| 011 | 23001450 | | | Swivel |
| 012 | 23001455 | | | Valve, Two Way |
| 013 | BLANK | | Not Available | PLATE, IDENTIFICATION |
| 014 | 23001461 | | | Rivets, Blind |
| 015 | 23001462 | | | Holder, Fuse |

| | | | |
|-----|--------------------------|--------------------------|--------------------------------|
| 016 | 23001468 | | Sticker, Spin Direction |
| 017 | NLA | Not Available | PLATE, INDEX (HOT WATER) |
| 018 | NLA | Not Available | PLATE, INDEX (COLD HARD WATER) |
| 019 | NLA | Not Available | PLATE, INDEX (COLD SOFT WATER) |
| 020 | 23001509 | | Sticker, Pipe Thread |
| 021 | NLA | Not Available | PLUG (13) |
| 022 | 23001476 | | Plug, Water Inlet |
| 023 | 23001477 | | Adapter |
| 024 | 23001482 | | Connection |
| 025 | 23001483 | | Washer |
| 026 | 23001484 | | Extension, Brass Pipe Thread |
| 027 | 23001485 | | Tee, 3/4" Pipe Thread |
| 028 | 23001523 | | North American, Hose |
| 029 | 23002197 | | Med. Strain Relief Nut |
| 030 | 23001312 | | Mut M6 |
| 031 | 23001115 | | Terminal Block Insulation |
| 032 | NLA | Not Available | LABEL, TERMINAL |
| 033 | 23002196 | | Protector, Cable |
| 034 | 23001731 | 23003502 | Switch, Main |
| " | 23002914 | | Switch, Main |
| " | 23002915 | 23003501 | Switch, Main |
| " | 23002916 | | Switch, Main |
| 035 | 23002212 | | Bushing Nut |
| 036 | NLA | Not Available | SWIVEL |
| 037 | 23002243 | | Plug, Universal |
| 038 | 23002210 | | Holder, Fuse |
| 039 | 23001508 | | Fuse |
| " | 23002918 | 23001508 | Fuse |
| 040 | 23002919 | | Fuse 0.5A 250V |
| 041 | 23001465 | | Sticker, Electricity Warning |
| 042 | 23002920 | | Plate, Index |
| 043 | 23002053 | | Label, Warning Vent Out |
| 044 | NLA | Not Available | STICKER (1A) |
| 045 | 23001055 | 23001014 | Nut M4 |
| 046 | 23001158 | | Lockwasher |
| 047 | 23002778 | | Screw |
| 048 | 23002921 | | Washer, Fill Hose |
| 049 | 23001113 | | Housing, Connector |
| 050 | 23002922 | | Filter Screen |
| 051 | 23002923 | | Board, Terminal |
| 052 | 23002924 | | T-Part |