

# Maytag MFR35MNATS 04 - WATER VALVE & REAR PANEL

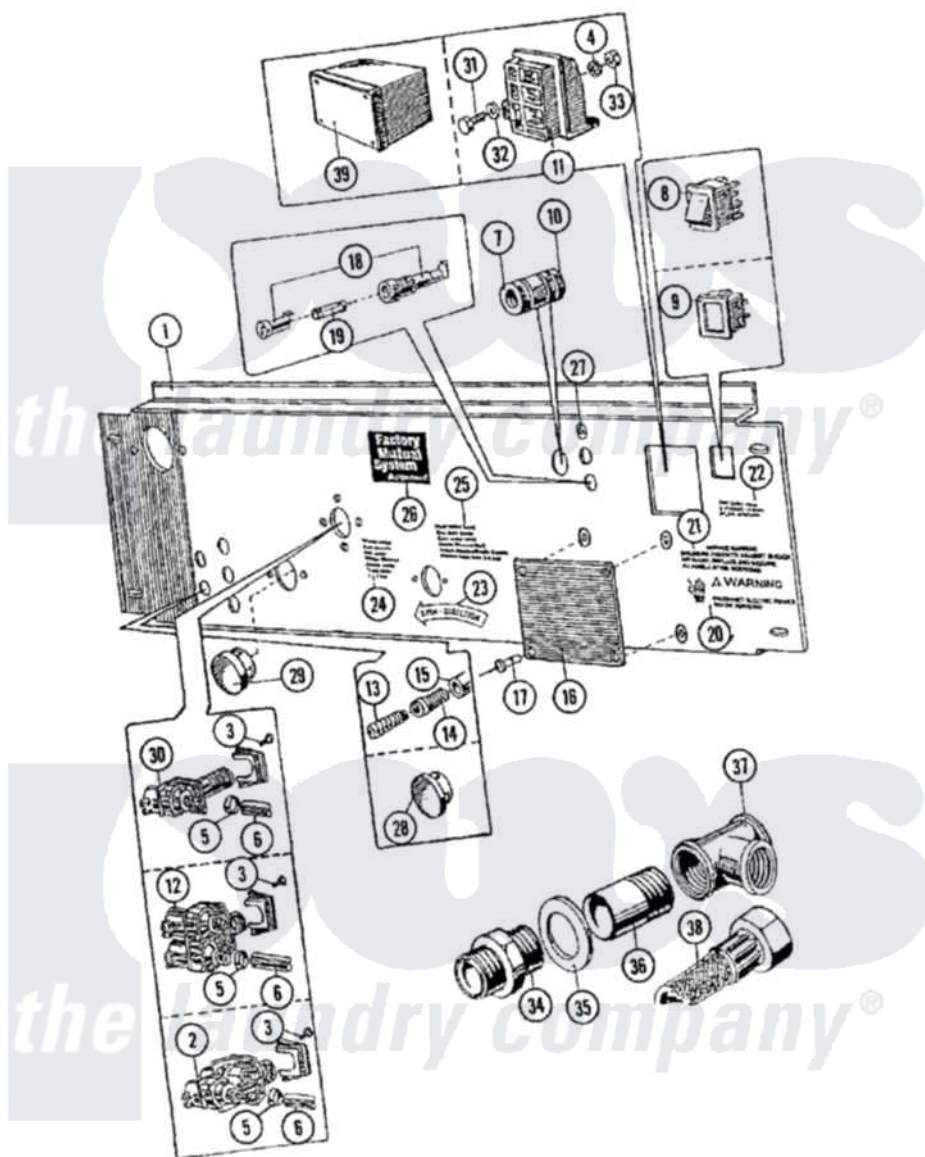

Maytag Commercial Maytag MFR35MNATS Washer Parts Parts Diagram 04 - WATER VALVE & REAR PANEL  
 Click on the part number to view part

| Item | Original Part Number     | Replaced By              | Status | Part Description              |
|------|--------------------------|--------------------------|--------|-------------------------------|
| 001  | 23001339                 | <a href="#">23002455</a> |        | Nut, Rapid                    |
| "    | <a href="#">23001503</a> |                          |        | Panel, Valve                  |
| 002  | <a href="#">23001361</a> |                          |        | Bolt                          |
| 003  | <a href="#">23001013</a> |                          |        | Lock Washer External Teeth M4 |
| 004  | 23001506                 | <a href="#">596669</a>   |        | Clamp, Manifold               |
| 005  | <a href="#">23001507</a> |                          |        | Waterhose                     |
| 006  | <a href="#">23001450</a> |                          |        | Swivel                        |
| 007  | <a href="#">23001529</a> |                          |        | Button                        |
| 008  | <a href="#">23001452</a> |                          |        | Square Plug                   |
| 009  | <a href="#">23001453</a> |                          |        | Nut, Swivel                   |
| 010  | <a href="#">23001454</a> |                          |        | Block, Terminal Connection    |
| 011  | <a href="#">23001455</a> |                          |        | Valve, Two Way                |
| 012  | <a href="#">23001460</a> |                          |        | Plate, Identification         |
| 013  | <a href="#">23001461</a> |                          |        | Rivets, Blind                 |
| 014  | <a href="#">23001462</a> |                          |        | Holder, Fuse                  |
| 015  | <a href="#">23001508</a> |                          |        | Fuse                          |

|     |                          |                          |                              |
|-----|--------------------------|--------------------------|------------------------------|
| 016 | <a href="#">23001465</a> |                          | Sticker, Electricity Warning |
| 017 | <a href="#">23001468</a> |                          | Sticker, Spin Direction      |
| 018 | <a href="#">23001469</a> |                          | Sticker, Hot Water           |
| 019 | <a href="#">23001471</a> |                          | Sticker, Cold Soft Water     |
| 020 | <a href="#">23001509</a> |                          | Sticker, Pipe Thread         |
| 021 | NLA                      | Not Available            | STICKER (1A)                 |
| 022 | NLA                      | Not Available            | PLUG, LIQUID SOAP<br>OPENING |
| 023 | <a href="#">23001477</a> |                          | Adapter                      |
| 024 | NLA                      | Not Available            | SCREW (M 4 X 16 BRASS)       |
| 025 | NLA                      | Not Available            | WASHER (DIA. 9 X 4.3 X 0.8)  |
| 026 | 23001481                 | <a href="#">23001014</a> | Nut M4                       |
| 027 | <a href="#">23001482</a> |                          | Connection                   |
| 028 | <a href="#">23001483</a> |                          | Washer                       |
| 029 | <a href="#">23001484</a> |                          | Extension, Brass Pipe Thread |
| 030 | <a href="#">23001485</a> |                          | Tee, 3/4" Pipe Thread        |
| 031 | <a href="#">23001523</a> |                          | North American, Hose         |

