

# Maytag MFR35PCATS 17 - TIMER & COIN ASSEMBLY (SERIES 11)

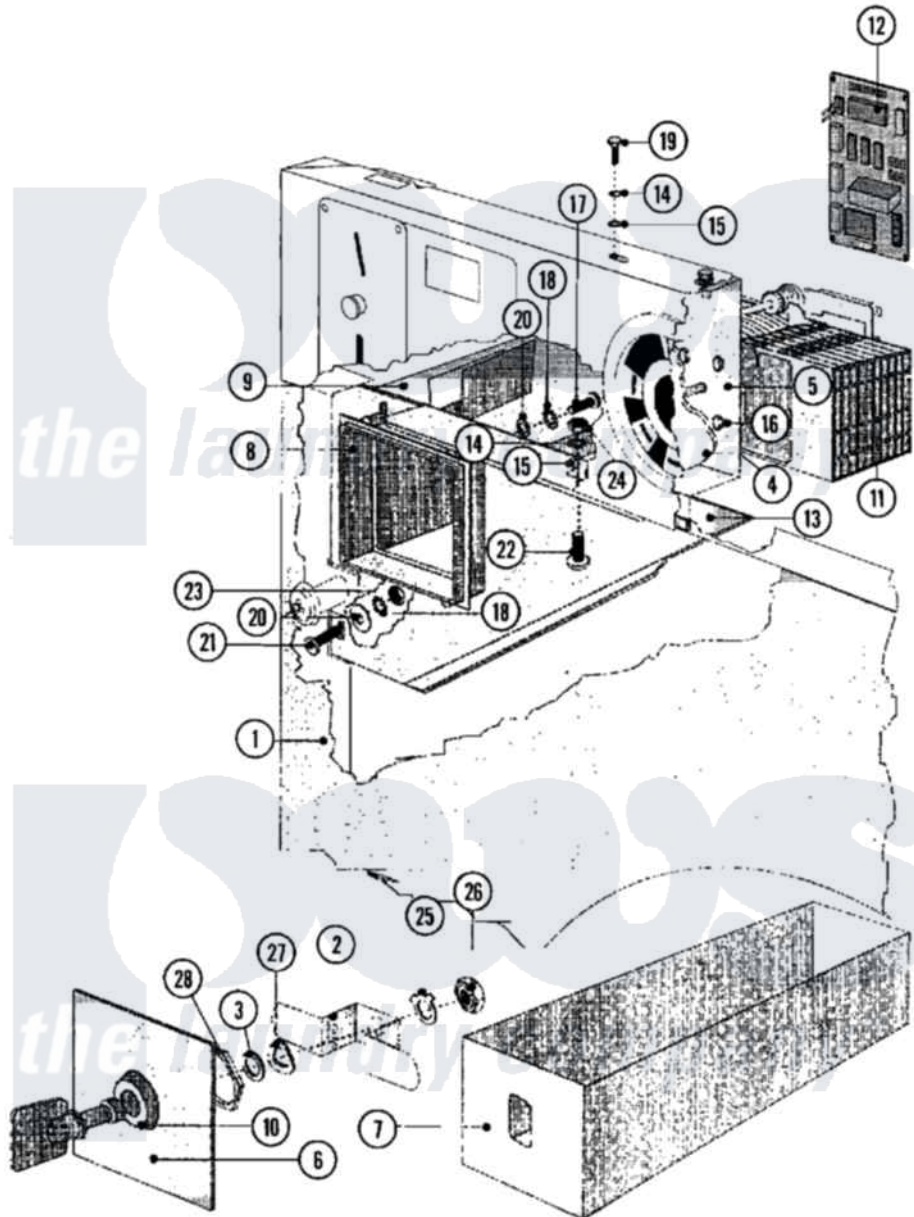

Maytag Commercial Maytag MFR35PCATS Washer Parts Parts Diagram 17 - TIMER & COIN ASSEMBLY (SERIES 11)  
 Click on the part number to view part

Item	Original Part Number	Replaced By	Status	Part Description
001	<a href="#">23001320</a>			Panel, Front
002	<a href="#">23002879</a>			Cam, Coin Lock Box
003	<a href="#">23001580</a>			Washer
004	<a href="#">23001060</a>			Disc, Timer Indicator
005	<a href="#">23002880</a>			Timer, Support
006	<a href="#">23002881</a>			Plate, Coin Vault Ornamental
007	<a href="#">23002882</a>			Box, Coin
008	<a href="#">23002883</a>			Vault, Ornamental
009	<a href="#">23002884</a>			Vault, Coin Lu
010	<a href="#">23002885</a>			Lock, Coin Vault
011	<a href="#">23001065</a>			Timer
"	<a href="#">23003445</a>			Coil
012	<a href="#">23001066</a>			Counter, Coin
"	23001693	<a href="#">23001066</a>		Counter, Coin
"	<a href="#">23003987</a>			Coin Counter Ham-Mc
013	<a href="#">23001502</a>			Support, Coin Vault

014	<a href="#">23002756</a>		Lockwasher
015	<a href="#">23001027</a>		Washer
016	<a href="#">23002886</a>		Screw
017	23002423	<a href="#">23001361</a>	Bolt
018	23002111	<a href="#">23001013</a>	Lock Washer External Teeth M4
019	23002354	<a href="#">23002461</a>	Screw
020	23001610	<a href="#">23002438</a>	Washer M4.3
021	<a href="#">23001012</a>		Screw
022	NLA	Not Available	SCREW (M6X12)
023	23002399	<a href="#">23001014</a>	Nut M4
024	23002436	Not Available	NUT (M6)
025	NLA	Not Available	WASHER, SELF LOCKING
026	NLA	Not Available	NUT, LOCK (SMALL)
027	NLA	Not Available	WASHER, SPRING LOCK
028	NLA	Not Available	NUT, LOCK (BIG)
029	<a href="#">23001038</a>		Conversion Kit
"	<a href="#">23002195</a>		Pc-Pn Conversion Kit
"	<a href="#">23002333</a>		Pc To Pn Conversion
"	<a href="#">23002334</a>		Mc To MN Convers.

