

# Maytag MFR35PDAVS 12 - ELECTRICAL COMPONENTS

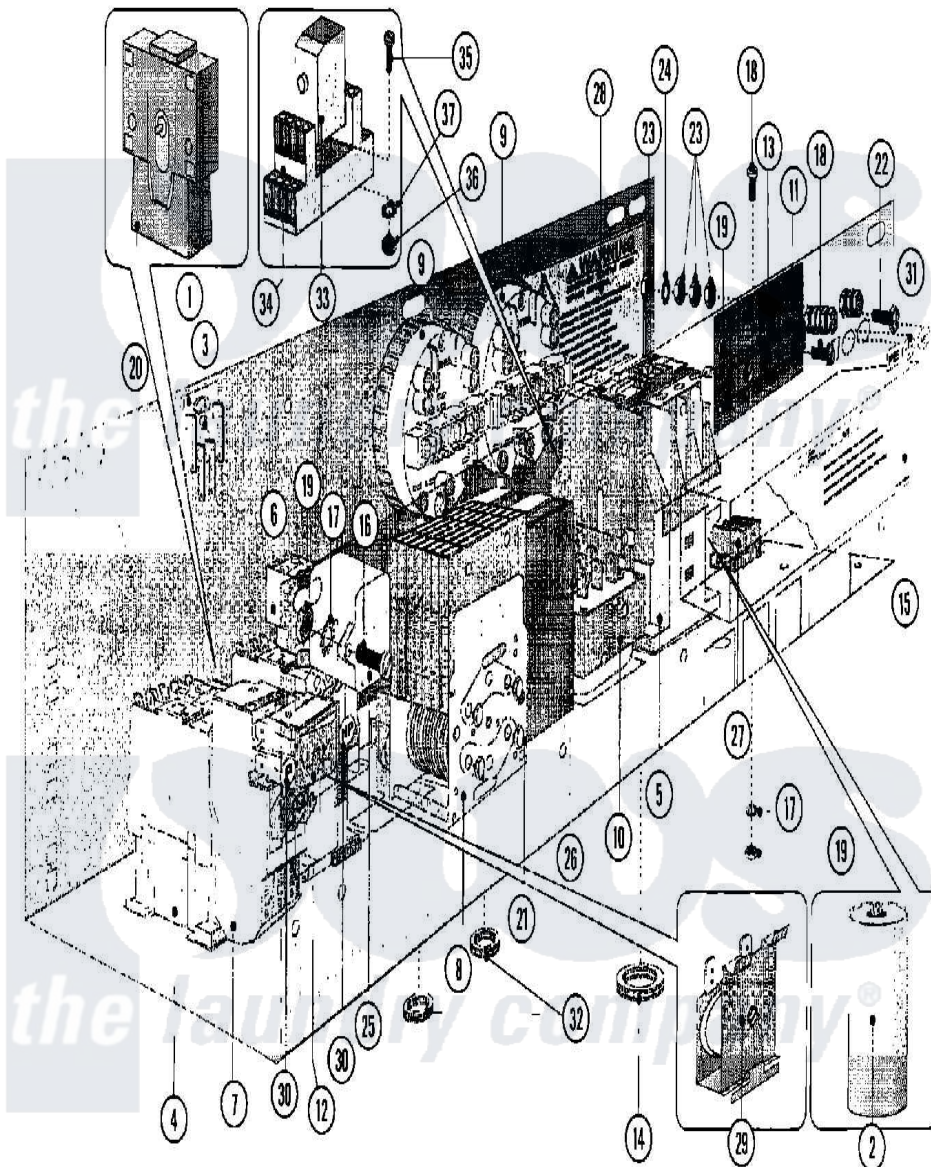

Maytag [Commercial Maytag MFR35PDAVS Washer Parts](#) Parts Diagram 12 - ELECTRICAL COMPONENTS  
 Click on the part number to view part

Item	Original Part Number	Replaced By	Status	Part Description
001	<a href="#">23001094</a>			Bridge, Rectifier
002	<a href="#">23001096</a>			Capacitor
"	<a href="#">23001098</a>			Capacitor
003	<a href="#">23001099</a>			Socket, Pc Board Socket
004	23001100	<a href="#">23003750</a>		Frequency Inverter Contactor
"	23001101	<a href="#">23003751</a>		Contactors Lc1 D12
"	<a href="#">23003750</a>			Frequency Inverter Contactor
"	<a href="#">23003751</a>			Contactors Lc1 D12
005	<a href="#">23001102</a>			Contactors
"	<a href="#">23001103</a>			Contactors
"	<a href="#">23001340</a>			Contactors
"	<a href="#">23003752</a>			Contactors Lc1
006	<a href="#">23001104</a>			Auxiliary Contact
007	23001105	<a href="#">23003761</a>		Overload Relay LR2D
"	<a href="#">23001106</a>			Relay, Thermal Overload
"	<a href="#">23001108</a>			Relay, Thermal Overload

"	23002101	<a href="#">23003757</a>	Overload Relay 5.5-8A
"	<a href="#">23003756</a>		Overload Relay 4-6a
"	<a href="#">23003757</a>		Overload Relay 5.5-8A
"	<a href="#">23003758</a>		Overload Relay LR2D
"	<a href="#">23003761</a>		Overload Relay LR2D
008	<a href="#">23001110</a>		Timer, Reversing
009	23001111	<a href="#">23001513</a>	Switch, Water Level
"	<a href="#">23001513</a>		Switch, Water Level
"	23002176	<a href="#">23001513</a>	Switch, Water Level
010	<a href="#">23002460</a>		Thermostat
011	<a href="#">23002154</a>		Housing, Connector
012	<a href="#">23001114</a>		Rocker Switch, Prewash/No Prew
013	<a href="#">23001115</a>		Terminal Block Insulation
014	<a href="#">23001117</a>		Ring, Rubber
015	<a href="#">23001118</a>		Sticker, Liquid Soap
016	23002423	<a href="#">23001361</a>	Bolt
017	23002111	<a href="#">23001013</a>	Lock Washer External Teeth M4
018	23002398	<a href="#">23001089</a>	Screw
019	23002399	<a href="#">23001014</a>	Nut M4
020	23001119	<a href="#">23003762</a>	Mechanical Interlock
021	23002952	<a href="#">23001069</a>	Screw
022	<a href="#">23002806</a>		Screw
023	23001515	<a href="#">23001312</a>	Mut M6
024	23001734	<a href="#">23002425</a>	Locker Washer M6
025	NLA	Not Available	MEMBER, RC
026	23002348	<a href="#">23003734</a>	Transformer
027	<a href="#">23002959</a>		Electric Heat Terminal Board
028	<a href="#">23001465</a>		Sticker, Electricity Warning
029	<a href="#">23002955</a>		Buzzer
030	NLA	Not Available	STICKER
031	NLA	Not Available	LABEL, EARTH
032	<a href="#">23001138</a>		Bushing, Cable Passage
033	<a href="#">23002956</a>		Schrach, Relay
034	<a href="#">23002957</a>		Base, Relay
035	<a href="#">23002906</a>		Screw
036	<a href="#">23002958</a>		Nut M3
037	23002865	<a href="#">23001054</a>	Washer, Locking

*the laundry company*<sup>®</sup>