

Maytag MFR50PDATS 09 - ELECTRICAL COMPONENTS

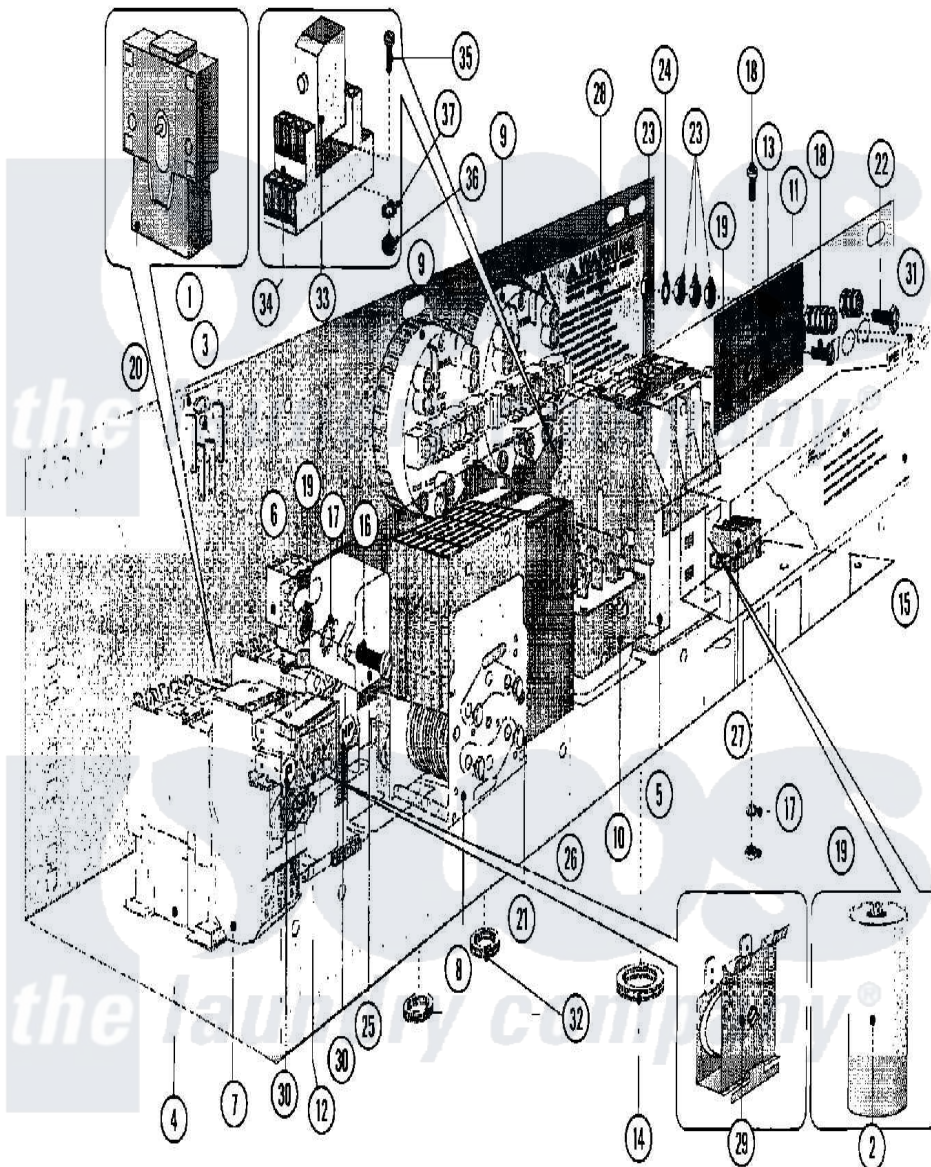

Maytag [Commercial Maytag MFR50PDATS Washer Parts](#) Parts Diagram 09 - ELECTRICAL COMPONENTS
 Click on the part number to view part

| Item | Original Part Number | Replaced By | Status | Part Description |
|------|--------------------------|--------------------------|---------------|-------------------------------|
| 001 | 23001094 | | | Bridge, Rectifier |
| 002 | W10124350 | | Not Available | NOT REQUIRED PART OR SEE NOTE |
| 003 | 23001099 | | | Socket, Pc Board Socket |
| 004 | 23001100 | 23003750 | | Frequency Inverter Contactor |
| " | 23001101 | 23003751 | | Contacteur Lc1 D12 |
| " | 23003750 | | | Frequency Inverter Contactor |
| " | 23003751 | | | Contacteur Lc1 D12 |
| 005 | W10124350 | | Not Available | NOT REQUIRED PART OR SEE NOTE |
| 006 | W10124350 | | Not Available | NOT REQUIRED PART OR SEE NOTE |
| 007 | 23001105 | 23003761 | | Overload Relay LR2D |
| " | 23001106 | | | Relay, Thermal Overload |
| " | 23001108 | | | Relay, Thermal Overload |
| " | 23002101 | 23003757 | | Overload Relay 5.5-8A |
| " | 23003756 | | | Overload Relay 4-6a |

| | | | |
|-----|--------------------------|--------------------------|--------------------------------|
| " | 23003757 | | Overload Relay 5.5-8A |
| " | 23003758 | | Overload Relay LR2D |
| " | 23003761 | | Overload Relay LR2D |
| 008 | W10124350 | Not Available | NOT REQUIRED PART OR SEE NOTE |
| 009 | 23001111 | 23001513 | Switch, Water Level |
| " | 23001513 | | Switch, Water Level |
| " | 23002176 | 23001513 | Switch, Water Level |
| 010 | 23002460 | | Thermostat |
| 011 | 23002154 | | Housing, Connector |
| 012 | 23001114 | | Rocker Switch, Prewash/No Prew |
| 013 | 23001115 | | Terminal Block Insulation |
| 014 | 23001117 | | Ring, Rubber |
| 015 | 23001118 | | Sticker, Liquid Soap |
| 016 | 23002423 | 23001361 | Bolt |
| 017 | 23002111 | 23001013 | Lock Washer External Teeth M4 |
| 018 | 23002398 | 23001089 | Screw |
| 019 | 23002399 | 23001014 | Nut M4 |
| 020 | 23001119 | 23003762 | Mechanical Interlock |
| " | 23003762 | | Mechanical Interlock |
| 021 | 23002952 | 23001069 | Screw |
| 022 | 23002806 | | Screw |
| 023 | 23001515 | 23001312 | Mut M6 |
| 024 | 23001734 | 23002425 | Locker Washer M6 |
| 025 | NLA | Not Available | MEMBER, RC |
| 026 | 23002348 | 23003734 | Transformer |
| 027 | 23002959 | | Electric Heat Terminal Board |
| 028 | 23001465 | | Sticker, Electricity Warning |
| 029 | 23002955 | | Buzzer |
| 030 | NLA | Not Available | STICKER |
| 031 | NLA | Not Available | LABEL, EARTH |
| 032 | 23001138 | | Bushing, Cable Passage |
| 033 | 23002956 | | Schrach, Relay |
| 034 | 23002957 | | Base, Relay |
| 035 | 23002906 | | Screw |
| 036 | 23002958 | | Nut M3 |
| 037 | 23002865 | 23001054 | Washer, Locking |

the laundry company[®]