

# Maytag MFS100PAVS 13 - CONTROL PANEL

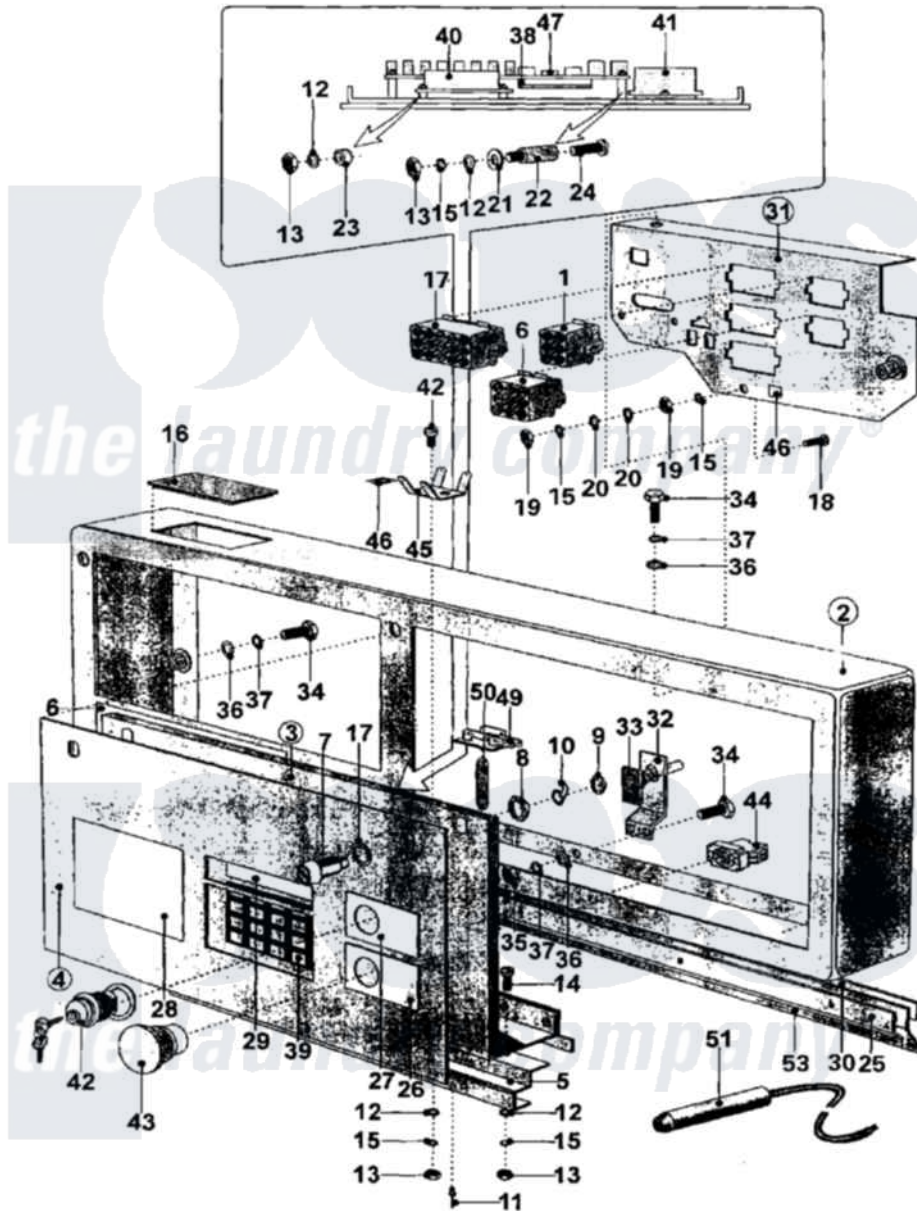

Maytag [Commercial Maytag MFS100PAVS Washer Parts](#) Parts Diagram 13 - CONTROL PANEL  
 Click on the part number to view part

Item	Original Part Number	Replaced By	Status	Part Description
001	<a href="#">23001723</a>			Board, Terminal
002	<a href="#">23002763</a>			Panel, Front
003	<a href="#">23002764</a>			Cover, Top
004	<a href="#">23002765</a>			Plate, Index
005	<a href="#">23002766</a>			Support, Plate
006	<a href="#">23001722</a>			Board, Terminal
007	<a href="#">23001583</a>			Device, Locking
008	<a href="#">23001008</a>			Nut, Lock
009	<a href="#">23001011</a>			Nut
010	<a href="#">23002451</a>			Pawl
011	NLA		Not Available	RIVET/CRANK (4 X 7.5)
012	23001610	<a href="#">23002438</a>		Washer M4.3
013	<a href="#">23002452</a>	<a href="#">8184504</a>		Nut
014	NLA		Not Available	COVER
015	<a href="#">23002400</a>			Washer
016	NLA		Not Available	COVER

017	<a href="#">23001721</a>		Board, Terminal
018	<a href="#">23002778</a>		Screw
019	NLA	Not Available	NUT (M4)
020	<a href="#">23002725</a>		Washer
021	NLA	Not Available	INSULATION (WASHER)
022	NLA	Not Available	INSULATION (BOARD SUPPORT)
023	<a href="#">23001058</a>		Tube, Distance
024	<a href="#">23002769</a>		Screw
025	NLA	Not Available	BAR
026	NLA	Not Available	PLATE (EMERGENCY STOP)
027	NLA	Not Available	PLATE (HOPPERS-PUMPS)
028	<a href="#">23002772</a>		Plate
029	<a href="#">23002163</a>		Hole, Inspection
030	NLA	Not Available	STRIP
031	<a href="#">23002773</a>		Bracket, Terminal Board
032	<a href="#">23002774</a>		Holder, Vibration Switch
033	<a href="#">23002775</a>		Switch, Vibration
034	NLA	Not Available	SCREW (M6X10)
035	23002651	<a href="#">23001312</a>	Mut M6
036	23002282	<a href="#">23001027</a>	Washer
037	23002357	<a href="#">23002440</a>	Washer, Spring Lock
038	<a href="#">23002201</a>		Microprocessor
039	<a href="#">23001692</a>		Keyboard
040	<a href="#">23001718</a>		Board, Additional
041		Not Available	
042		Not Available	
043	23001078	<a href="#">23002331</a>	Contactor, Central Stop
044	<a href="#">23001075</a>	<a href="#">23002331</a>	Contactor, Central Stop
045	NLA	Not Available	CONTACT (6.3 TYPE 140609-0)
046	NLA	Not Available	LABEL, EARTH
047	23003744	<a href="#">23003745</a>	Controller, Apl280ne V1.04
"	<a href="#">23003745</a>		Controller, Apl280ne V1.04
048	<a href="#">23002025</a>		Label, Electrostatic Sensitive
049	<a href="#">23001094</a>		Bridge, Rectifier
050	<a href="#">23001099</a>		Socket, Pc Board Socket
051	<a href="#">23001073</a>		Sensor, Temperature
052	23001609	<a href="#">23002721</a>	Screw
053	<a href="#">23002782</a>		Top Cuff