

Maytag MFX100PAVS 01 - SOAP INJECTION & ACCESSORIES

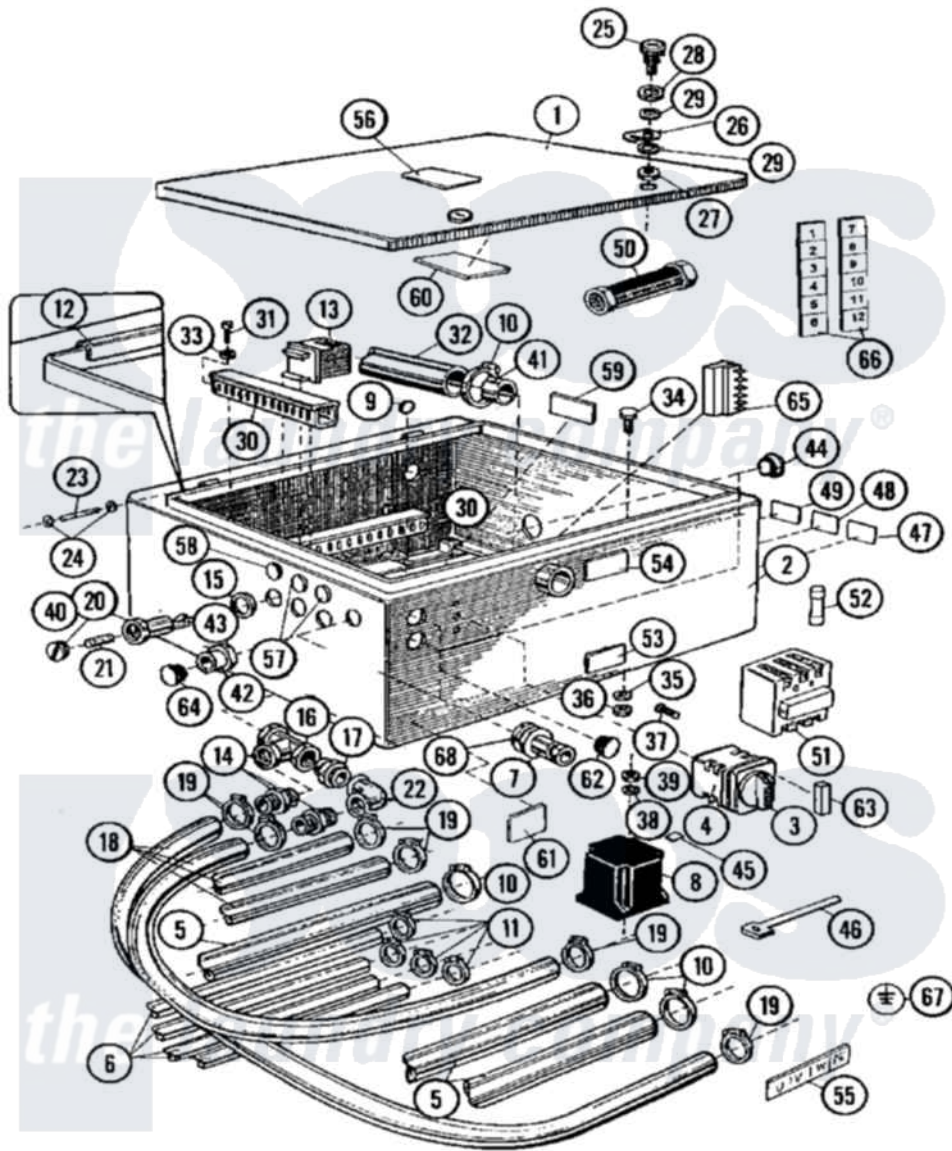

Maytag Commercial Maytag MFX100PAVS Washer Parts Parts Diagram 01 - SOAP INJECTION & ACCESSORIES
 Click on the part number to view part

Item	Original Part Number	Replaced By	Status	Part Description
001	23002021			Cover, Electrical Box
002	23002020			Box, Distributor
003	23002141			Device, Operating
004	23002022			Switch, Main
005	23002023			Hose, Inlet
006	23001507			Waterhose
007	NLA		Not Available	SWIVEL, CABLE
008	23002142	23003708		Transformer Control Brd
"	23003704			Transformer Use On Model Mfs125pavs
009	23002143			Nipple
010	23001261	616099		Clamp
011	23001506	596669		Clamp, Manifold
012	23001088	23002473		Rubber, Protective
013	23001102			Contactora
014	23001727			Connection, Tube
015	23001743			Ring, O

016	23001485		Tee, 3/4" Pipe Thread
017	23001482		Connection
018	23001740		Hose
019	23001262	616099	Clamp
020	23001462		Holder, Fuse
021	23001463		Fuse
"	23002043		Fuse
022	23001756		Elbow
023	23001690		Screw, Distance
024	23001056		Ring, Shaft Locking
025	23001006		Lock, Top Panel
026	23001009		Hook, Lock
027	23001011		Nut
028	23001008		Nut, Lock
029	23001007		Washer M21x27x1
030	23001551		Gutter, Cable
031	23001361		Bolt
032	NLA	Not Available	HOSE, VENT
033	23001708		Washer
034	23001026		Bolt
035	23001027		Washer
036	23001034	Not Available	NUT (M6)
037	23001361		Bolt
038	23001708		Washer
039	23001334	8184504	Nut
040	23002210		Holder, Fuse
041	BLANK	Not Available	SOCKET
042	23002196		Protector, Cable
043	23002197		Med. Strain Relief Nut
044	NLA	Not Available	PACKING, MULTI-PURPOSE
045	23002025		Label, Electrostatic Sensitive
046	23001720		Binder, Cable
047	23001469		Sticker, Hot Water
048	23001471		Sticker, Cold Soft Water
049	NLA	Not Available	STICKER, COLD HARD WATER
050	23002057		Hose, Water Inlet
"	23003973		Washer, Fill Hose
051	BLANK	Not Available	DISCONNECTER, FUSE
052	BLANK	Not Available	FUSE
053	23001468		Sticker, Spin Direction
054	23002053		Label, Warning Vent Out
055	NLA	Not Available	LABEL (U V W PE)
056	NLA	Not Available	LABEL (ELECTRIC HEATING)
057	NLA	Not Available	LABEL (4A)
058	23001744	Not Available	LABEL (2A)
059	NLA	Not Available	LABEL, WARNING EL. TENSION
060	23001550		Sticker, Service Warning
061	23001465		Sticker, Electricity Warning
"	NLA	Not Available	LABEL, WARNING (IMPORT)
062	NLA	Not Available	BLIND, UNIVERSAL
063	23002151	Not Available	(WITHOUT HEATING)

"	23002152	Not Available	(ELECTRICAL HEATING)
"	NLA	Not Available	CONTACT ("N")
064	23002153		Plug
065	23002154		Housing, Connector
066	23002218		LABEL, TERMINAL BOARD
067	NLA	Not Available	LABEL, EARTH
068	23002197		Med. Strain Relief Nut

