

Maytag MLE23PDAYQ 02 - CONTROL CENTER (UPPER)

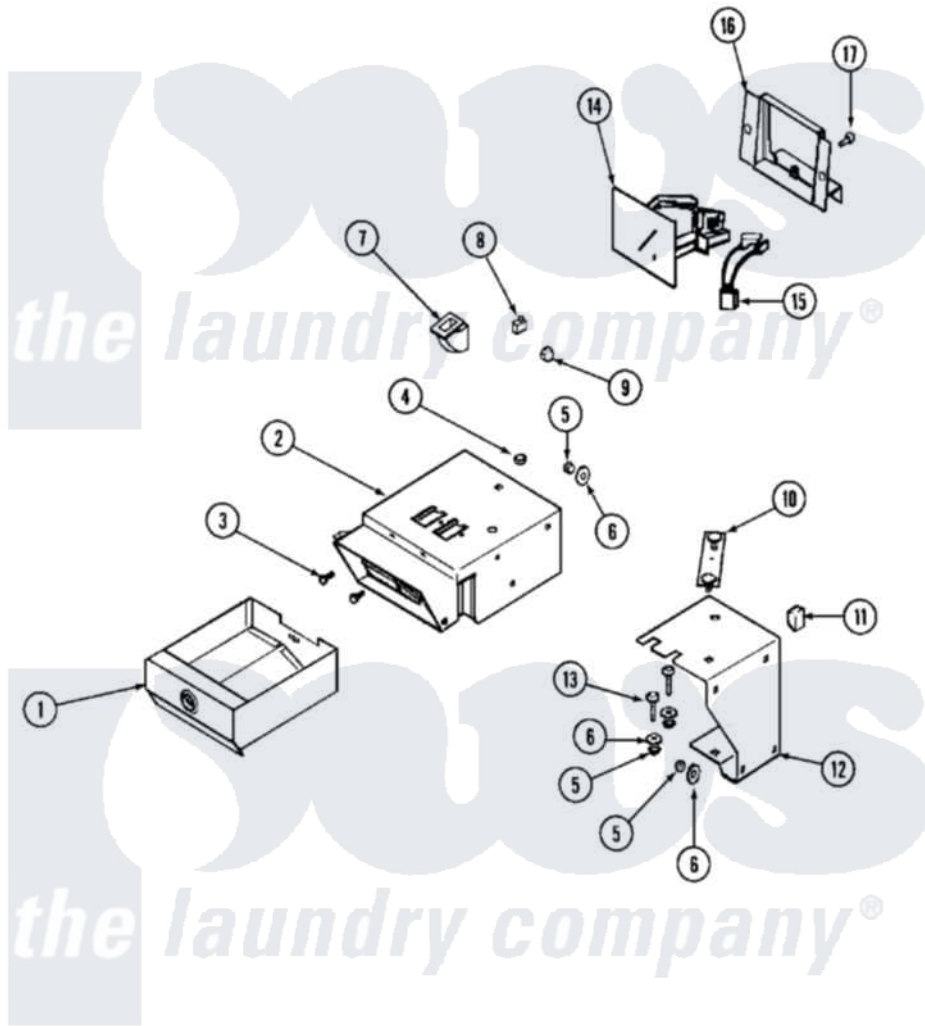

Maytag Commercial Maytag MLE23PDAYQ Dryer Parts Parts Diagram 02 - CONTROL CENTER (UPPER)
 Click on the part number to view part

Item	Original Part Number	Replaced By	Status	Part Description
001	33002443		Not Available	BOX, COIN (BSQ)
"	Y33001983			Box, Coin
002	33002444		Not Available	VAULT, COIN (BSQ)
"	Y33001986			Vault, Coin
003	33002683	694091		Trim, Side Right Hand
004	Y052740	62739		Nut, Lock
005	Y052734			Nut, Carrage Bolts And Bracket
006	312535			Washer, Vault Mounting Brk.
"	NLA		Not Available	WASHER, VAULT MOUNTING BRK.
007	314635			Chute, Coin
008	33001250			Switch, Vault And Service Door
009	NLA		Not Available	NUT, CAGE
010	22001810		Not Available	STRAP, MOUNTING
011	33001989			Retainer, Vault Switch

012	33001990		Bracket, Mounting Vault
013	33001991		Bolt, Carriage
014	216200		Face Plate Return Button
"	22002144		Single Faceplate
"	22003678	22004112	Coin Drop Greenwald Us.25
015	314665		Screw, Switch Assembly
"	33001985		Switch, Optic
016	33001992		Bracket, Coin Drop Mount.
"	33002445		Bracket, Coin Drop Mount.
017	212707	3196385	Screw
"	910181		Lockwasher, Terminal Block

