

Maytag MLG15PDAWA 02 - CONTROL CENTER (UPPER)

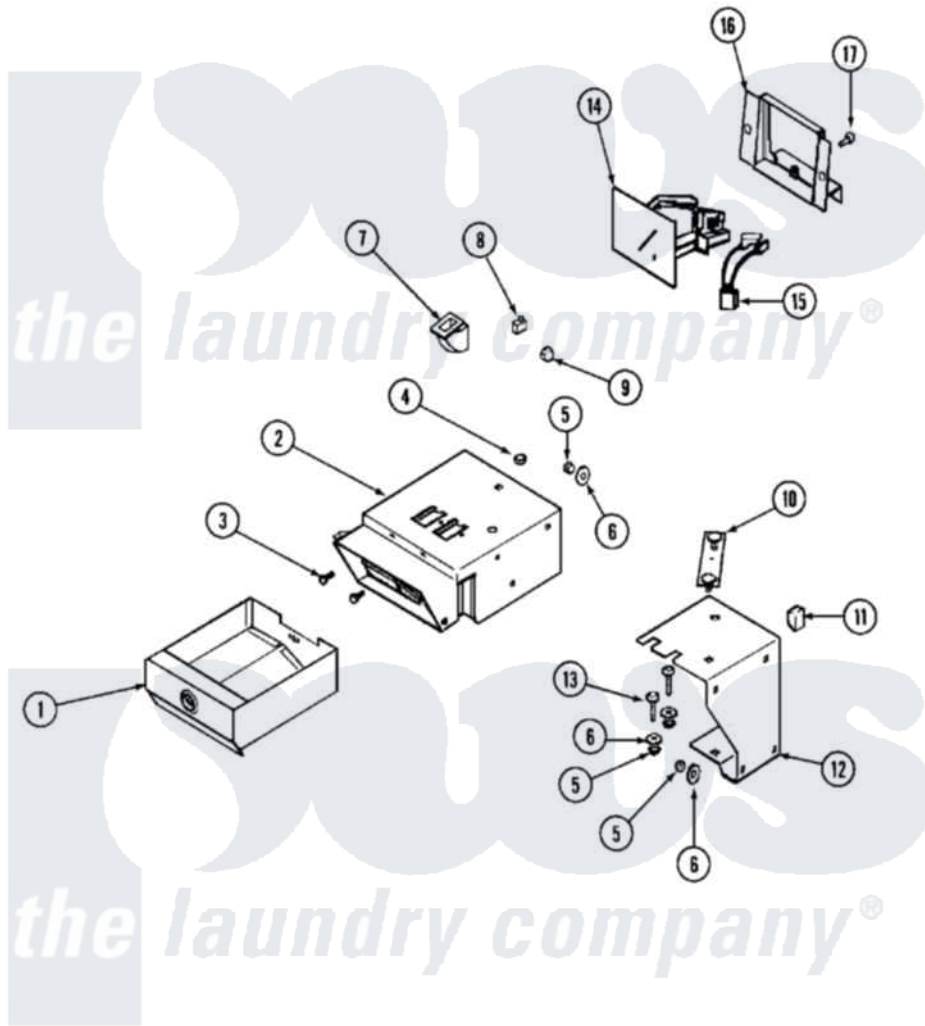

Maytag Commercial Maytag MLG15PDAWA Dryer Parts Parts Diagram 02 - CONTROL CENTER (UPPER)
 Click on the part number to view part

Item	Original Part Number	Replaced By	Status	Part Description
001	33001984	Y33001983		Box, Coin
"	33002443		Not Available	BOX, COIN (BSQ)
"	Y33001983			Box, Coin
002	33001987			(ALM)
"	33002444		Not Available	VAULT, COIN (BSQ)
"	Y33001986			Vault, Coin
003	212707	3196385		Screw
004	Y052740	62739		Nut, Lock
005	Y052734			Nut, Carrage Bolts And Bracket
006	312535			Washer, Vault Mounting Brk.
"	NLA		Not Available	WASHER, VAULT MOUNTING BRK.
007	314635			Chute, Coin
008	33001250			Switch, Vault And Service Door
009	NLA		Not Available	NUT, CAGE

010	22001810	Not Available	STRAP, MOUNTING
011	33001989		Retainer, Vault Switch
012	33001990		Bracket, Mounting Vault
013	33001991		Bolt, Carriage
014	216200		Face Plate Return Button
"	22001873	22004112	Coin Drop Greenwald Us.25
"	22002144		Single Faceplate
015	314665		Screw, Switch Assembly
"	33001985		Switch, Optic
016	33001992		Bracket, Coin Drop Mount.
"	33001993	33001992	Bracket, Coin Drop Mount.
"	33002445		Bracket, Coin Drop Mount.
017	Y313561		Screw---NA
"	910181		Lockwasher, Terminal Block

