

## Maytag MLG15PDAXW 02 - CONTROL CENTER (UPPER)

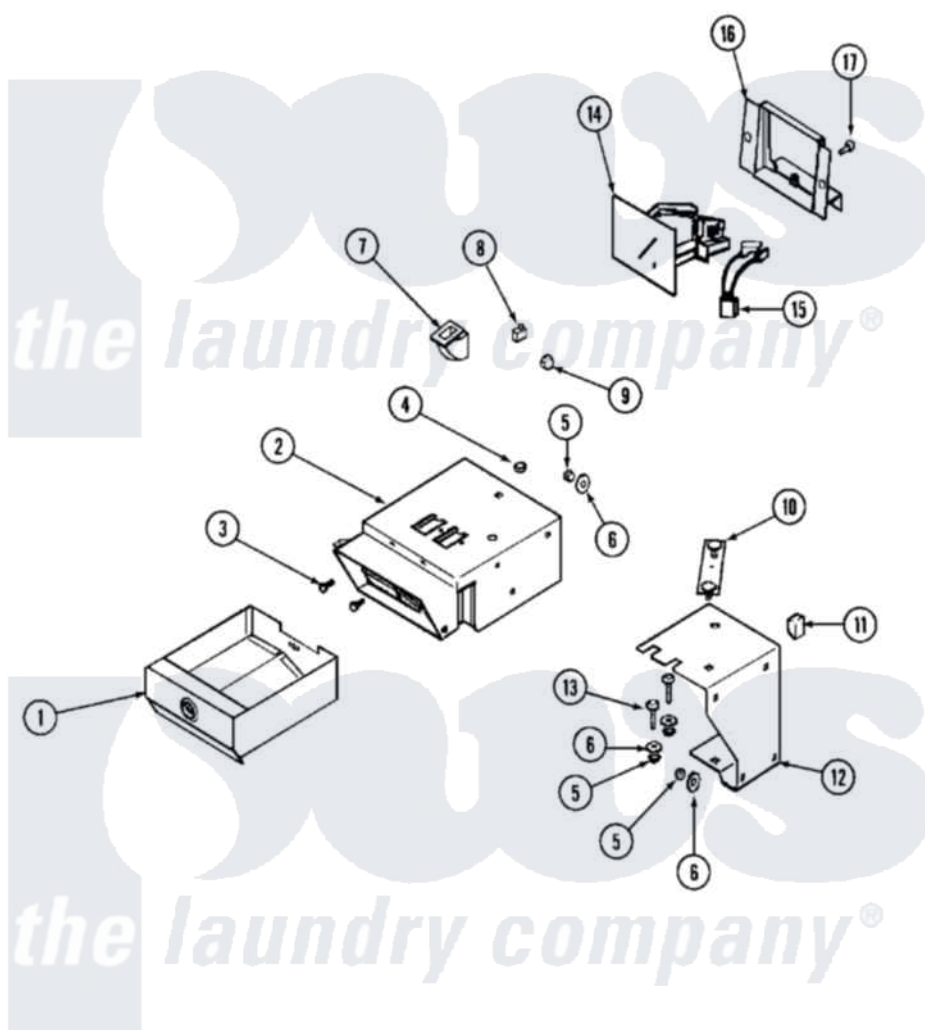

Maytag [Commercial Maytag MLG15PDAXW Dryer Parts](#) Parts Diagram 02 - CONTROL CENTER (UPPER)  
Click on the part number to view part

Item	Original Part Number	Replaced By	Status	Part Description
001	33001984	<a href="#">Y33001983</a>		Box, Coin
"	33002443		Not Available	BOX, COIN (BSQ)
"	<a href="#">Y33001983</a>			Box, Coin
002	<a href="#">33001987</a>			(ALM)
"	33002444		Not Available	VAULT, COIN (BSQ)
"	<a href="#">Y33001986</a>			Vault, Coin
003	212707	<a href="#">3196385</a>		Screw
004	<a href="#">Y052740</a>	<a href="#">62739</a>		Nut, Lock
005	<a href="#">Y052734</a>			Nut, Carrage Bolts And Bracket
006	<a href="#">312535</a>			Washer, Vault Mounting Brk.
"	NLA		Not Available	WASHER, VAULT MOUNTING BRK.
007	<a href="#">314635</a>			Chute, Coin
008	<a href="#">33001250</a>			Switch, Vault And Service Door
009	NLA		Not Available	NUT, CAGE

010	22001810	Not Available	STRAP, MOUNTING
011	<a href="#">33001989</a>		Retainer, Vault Switch
012	<a href="#">33001990</a>		Bracket, Mounting Vault
013	<a href="#">33001991</a>		Bolt, Carriage
014	<a href="#">216200</a>		Face Plate Return Button
"	<a href="#">22001875</a>		Coin Drop Assembly-Dual
"	<a href="#">22002144</a>		Single Faceplate
"	22002535	<a href="#">W10133245</a>	Dual Coin Drop Assembly
"	<a href="#">22003815</a>		Dual Faceplate
015	<a href="#">314665</a>		Screw, Switch Assembly
"	<a href="#">33001985</a>		Switch, Optic
016	<a href="#">33001992</a>		Bracket, Coin Drop Mount.
"	33001993	<a href="#">33001992</a>	Bracket, Coin Drop Mount.
"	<a href="#">33002445</a>		Bracket, Coin Drop Mount.
017	<a href="#">Y313561</a>		Screw---NA
"	<a href="#">910181</a>		Lockwasher, Terminal Block

