

Maytag MLG15PDCXW 02 - CONTROL CENTER (UPPER)

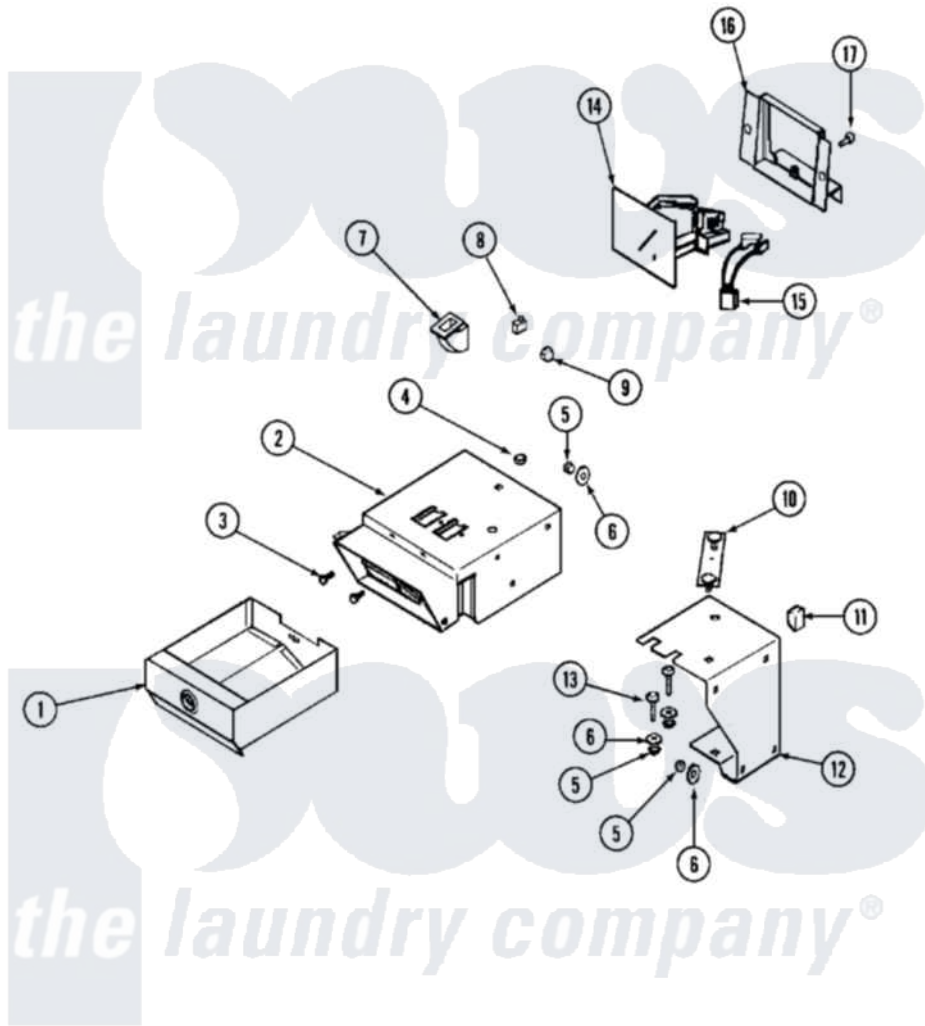

Maytag Commercial Maytag MLG15PDCXW Dryer Parts Parts Diagram 02 - CONTROL CENTER (UPPER)
 Click on the part number to view part

| Item | Original Part Number | Replaced By | Status | Part Description |
|------|---------------------------|---------------------------|---------------|--------------------------------|
| 001 | 33001984 | Y33001983 | | Box, Coin |
| " | 33002443 | | Not Available | BOX, COIN (BSQ) |
| " | Y33001983 | | | Box, Coin |
| 002 | 33001987 | | | (ALM) |
| " | 33002444 | | Not Available | VAULT, COIN (BSQ) |
| " | Y33001986 | | | Vault, Coin |
| 003 | 212707 | 3196385 | | Screw |
| 004 | Y052740 | 62739 | | Nut, Lock |
| 005 | Y052734 | | | Nut, Carrage Bolts And Bracket |
| 006 | 312535 | | | Washer, Vault Mounting Brk. |
| " | NLA | | Not Available | WASHER, VAULT MOUNTING BRK. |
| 007 | 314635 | | | Chute, Coin |
| 008 | 33001250 | | | Switch, Vault And Service Door |
| 009 | NLA | | Not Available | NUT, CAGE |

| | | | |
|-----|--------------------------|---------------------------|----------------------------|
| 010 | 22001810 | Not Available | STRAP, MOUNTING |
| 011 | 33001989 | | Retainer, Vault Switch |
| 012 | 33001990 | | Bracket, Mounting Vault |
| 013 | 33001991 | | Bolt, Carriage |
| 014 | 216200 | | Face Plate Return Button |
| " | 22001875 | | Coin Drop Assembly-Dual |
| " | 22002144 | | Single Faceplate |
| " | 22002535 | W10133245 | Dual Coin Drop Assembly |
| " | 22003815 | | Dual Faceplate |
| 015 | 314665 | | Screw, Switch Assembly |
| " | 33001985 | | Switch, Optic |
| 016 | 33001992 | | Bracket, Coin Drop Mount. |
| " | 33001993 | 33001992 | Bracket, Coin Drop Mount. |
| " | 33002445 | | Bracket, Coin Drop Mount. |
| 017 | Y313561 | | Screw---NA |
| " | 910181 | | Lockwasher, Terminal Block |

