

Maytag MLG19PDAWW 07 - CONTROL CENTER (DRYER)

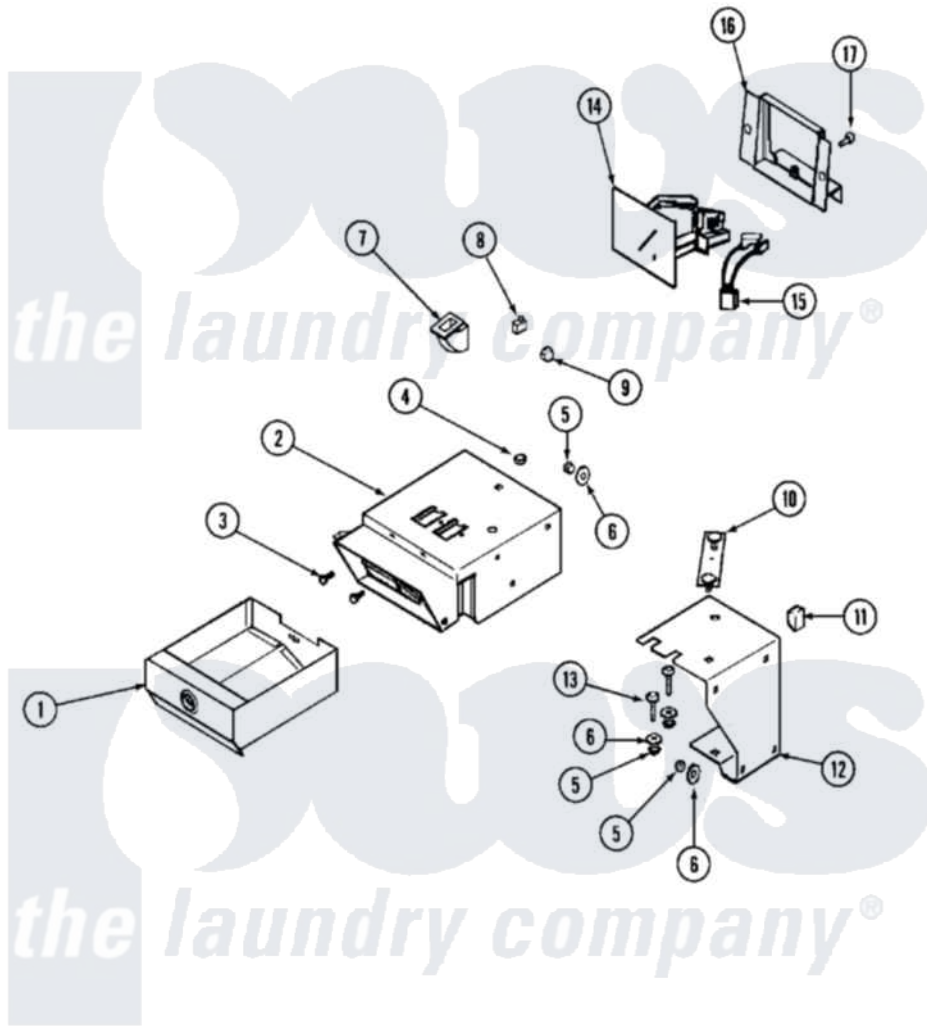

Maytag [Commercial Maytag MLG19PDAWW Dryer Parts](#) Parts Diagram 07 - CONTROL CENTER (DRYER)
 Click on the part number to view part

| Item | Original Part Number | Replaced By | Status | Part Description |
|------|---------------------------|------------------------|---------------|--------------------------------|
| 001 | Y33001983 | | | Box, Coin |
| 002 | Y33001986 | | | Vault, Coin |
| 003 | 33002683 | 694091 | | Trim, Side Right Hand |
| 004 | Y052740 | 62739 | | Nut, Lock |
| 005 | Y052734 | | | Nut, Carrage Bolts And Bracket |
| 006 | 312535 | | | Washer, Vault Mounting Brk. |
| " | NLA | | Not Available | WASHER, VAULT MOUNTING BRK. |
| 007 | 314635 | | | Chute, Coin |
| 008 | 33001250 | | | Switch, Vault And Service Door |
| " | 33001989 | | | Retainer, Vault Switch |
| 009 | NLA | | Not Available | NUT, CAGE |
| 010 | 22001810 | | Not Available | STRAP, MOUNTING |
| 011 | 33001989 | | | Retainer, Vault Switch |
| 012 | 33001990 | | | Bracket, Mounting Vault |

| | | | |
|-----|--------------------------|----------------------------|---------------------------|
| 013 | 33001991 | Bolt, Carriage | |
| 014 | 216200 | Face Plate Return Button | |
| " | 22001873 | 22004112 | Coin Drop Greenwald Us.25 |
| " | 22001875 | Coin Drop Assembly-Dual | |
| " | 22002144 | Single Faceplate | |
| " | 22002535 | W10133245 | Dual Coin Drop Assembly |
| " | 22003678 | 22004112 | Coin Drop Greenwald Us.25 |
| " | 22003815 | Dual Faceplate | |
| " | 22004112 | Coin Drop Greenwald Us.25 | |
| " | 33002647 | Single Faceplate Assembly | |
| 015 | 22001965 | Optic Switch Assembly | |
| " | 314665 | Screw, Switch Assembly | |
| 016 | 33001992 | Bracket, Coin Drop Mount. | |
| 017 | 212707 | 3196385 | Screw |
| " | 910181 | Lockwasher, Terminal Block | |

