

# Maytag MLG24PRAWW0 02 - CONTROL PANEL AND SEPARATOR PARTS

## CONTROL PANEL AND SEPARATOR PARTS

For Model: MLG24PRAWW0  
(White)

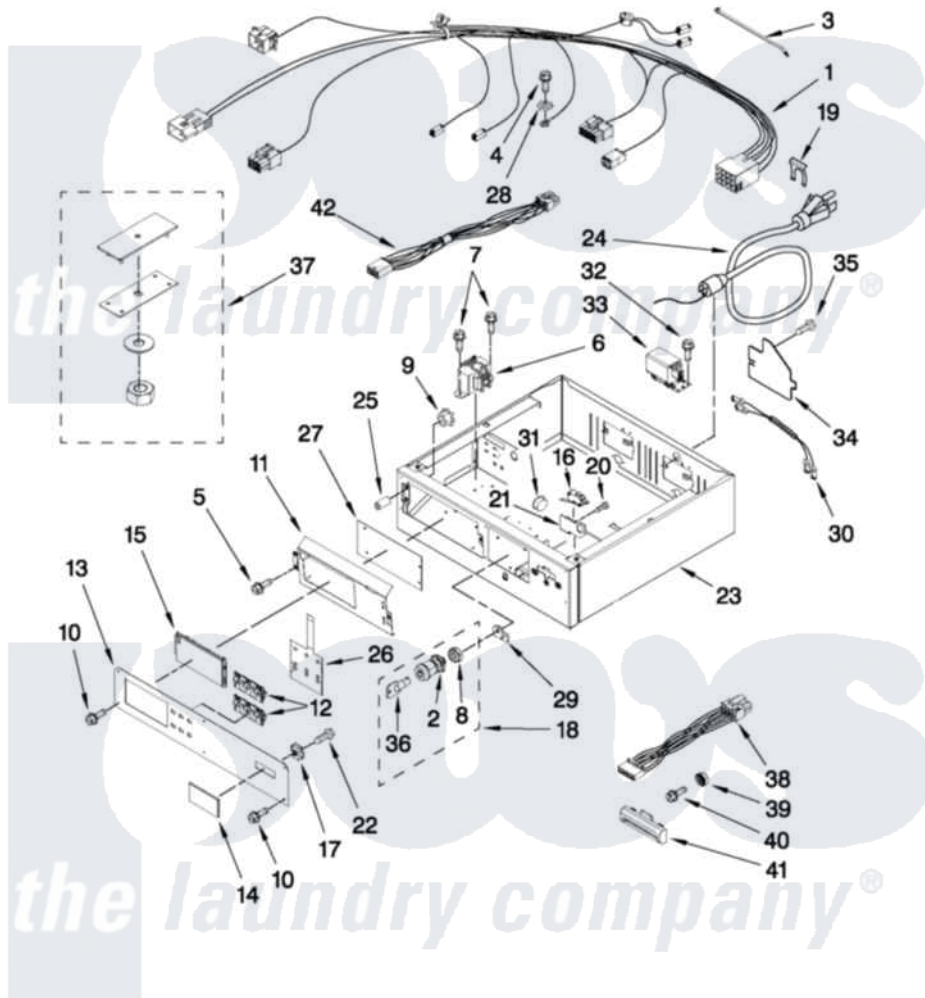

FOR ORDERING INFORMATION REFER TO PARTS PRICE LIST

W10135165

4

Maytag [Commercial Maytag MLG24PRAWW0 Dryer Parts](#) Parts Diagram 02 - CONTROL PANEL AND SEPARATOR PARTS

[Click on the part number to view part](#)

Item	Original Part Number	Replaced By	Status	Part Description
1	<a href="#">W10167620</a>			Harness, Collar
2	<a href="#">W10139762</a>			Hex Nut, 3/4-27
3	<a href="#">8529895</a>			Tie, Cable
4	697776	<a href="#">4331106</a>		Screw, No.10-32 X 7/16
5	<a href="#">W10140652</a>			Screw, 6-20 X 1/2
6	<a href="#">W10133285</a>			Transformer 120V To 22.5vac
7	8533971	<a href="#">90767</a>		Screw, 8A X 3/8 HeX Washer Head Tapping
8	<a href="#">W10177242</a>			Hex-Nut 9/32 - 28
9	<a href="#">W10139046</a>			Nut 6-32
10	<a href="#">W10131119</a>			Screw, 8-18 X 5/16
11	<a href="#">W10163677</a>			Plate, Control Mounting
12	<a href="#">W10131113</a>			Push Button
13	<a href="#">W10135186</a>			Facia Console
14	<a href="#">W10137769</a>			Cover, Card Reader
15	<a href="#">W10133268</a>			Cover, Display

16	<a href="#">W10133280</a>		Service Access, Switch
17	<a href="#">W10145157</a>		Retainer, Facia Cover
18	<a href="#">W10133264</a>		Lock Assembly, Service Door
19	<a href="#">694415</a>		Clip, Strain Relief
20	<a href="#">3400408</a>		Screw, 4-40 X 5/8
21	<a href="#">W10160652</a>		Bracket-Switch
22	<a href="#">3400618</a>		Screw, 6-19 X 3/8
23	<a href="#">W10165714</a>		Collar
24	<a href="#">694018</a>	<a href="#">W10239314</a>	Cord, Power
25	<a href="#">W10133514</a>		Spacer
26	<a href="#">W10133277</a>		Membrane Switch Assembly
27	<a href="#">W10130700</a>		Control Board
28	<a href="#">3390443</a>		Retainer, Terminal
29	<a href="#">W10133266</a>		Cam-Lock
30	<a href="#">W10188051</a>		Jumper, Line Filter
31	<a href="#">W10165297</a>		Snap Bushing
32	8533971	<a href="#">90767</a>	Screw, 8A X 3/8 HeX Washer Head Tapping
33	8540229	<a href="#">W10339736</a>	Filter, Interference
34	<a href="#">3396795</a>		Cover, Terminal Block
35	<a href="#">3400000</a>		Screw, 10-24 X 3/8
36	<a href="#">W10140858</a>		Key
37	<a href="#">W10169579</a>		Kit-Coin Box, Security
38	<a href="#">W10133305</a>		Harness, Card Reader
39	<a href="#">W10139046</a>		Nut 6-32
40	<a href="#">W10143462</a>		Screw, 6-32 X 9/16
41	<a href="#">W10163036</a>		Bezel
42	<a href="#">W10111027</a>		Jumper, Transformer

*the laundry company*<sup>®</sup>

*the laundry company*<sup>®</sup>