

# Maytag MLG31PCBWW 12 - MOTOR/IDLER ASSEMBLIES

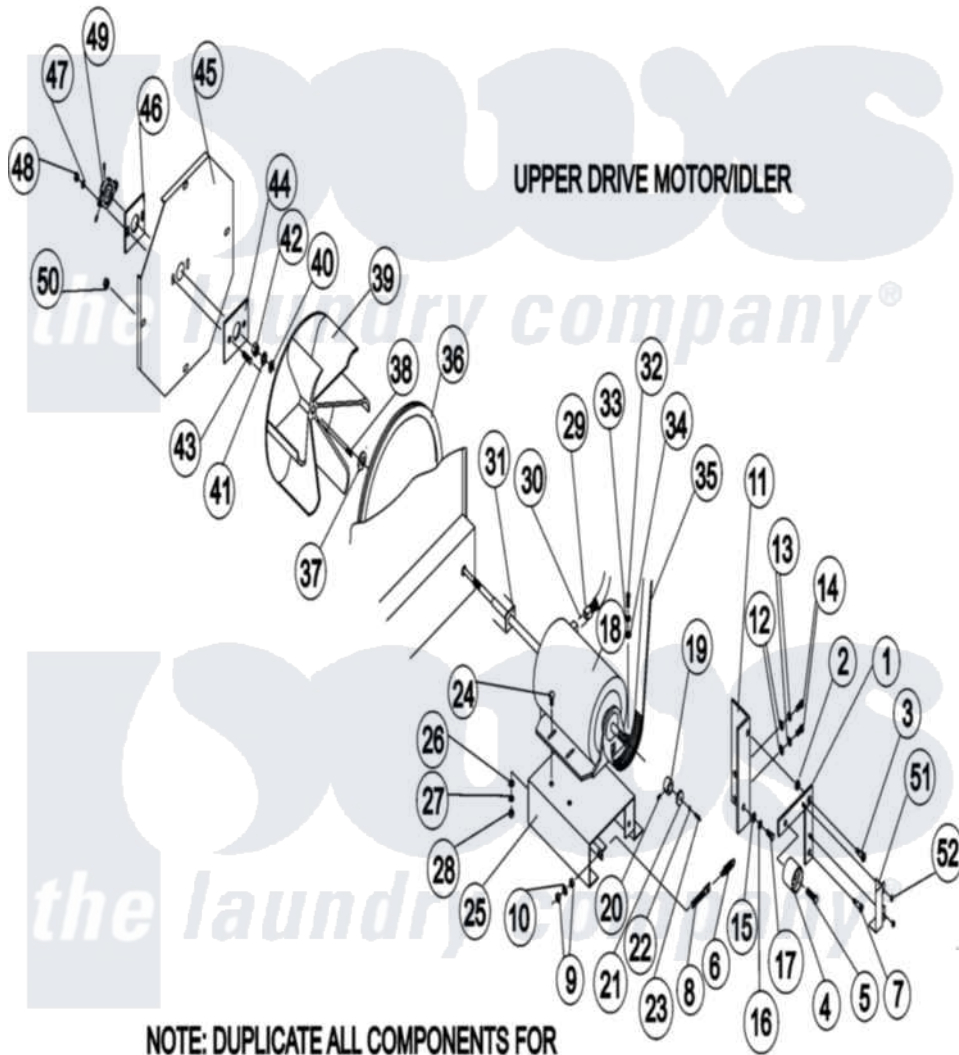

**NOTE: DUPLICATE ALL COMPONENTS FOR LOWER DRIVE MOTOR/IDLER ASSEMBLY**

Maytag [Commercial Maytag MLG31PCBWW Dryer Parts](#) Parts Diagram 12 - MOTOR/IDLER ASSEMBLIES  
 Click on the part number to view part

Item	Original Part Number	Replaced By	Status	Part Description
001	A801019	<a href="#">801019</a>		320 330 ID
"	A882910	<a href="#">882910</a>		320 330 To
002	A121350	<a href="#">121350</a>		13 32 X 3
003	<a href="#">A154277</a>			5/16 X 3/8" Shoulder Bolt
004	A100250	<a href="#">W10146618</a>		Back Side
005	A150600	<a href="#">150600</a>		3 8-16 X 1
006	A157010	<a href="#">157010</a>		1 7 8 Ext
007	A154276	<a href="#">154276</a>		5 16 x 5 8 1
008	A154275	<a href="#">154275</a>		3 8-16 X 3
009	A152005	<a href="#">152005</a>		3 8-16 Hex
010	A153005	<a href="#">153005</a>		3 8 Split
011	A850135	<a href="#">W10147660</a>		330 Idler
012	A153001	<a href="#">153001</a>		5 16 Flat
013	A153002	<a href="#">8182939</a>		Washer, Lock
014	A150501	<a href="#">150501</a>		5 16-18 X
015	A153001	<a href="#">153001</a>		5 16 Flat

016	A153002	<a href="#">8182939</a>	Washer, Lock
017	A150501	<a href="#">150501</a>	5 16-18 X
018	A100064	<a href="#">100064</a>	1 3 115 23
019	A101097	<a href="#">101097</a>	320 330 Re
020	A154327	<a href="#">154327</a>	1 4-20 X 3
021	A101096	<a href="#">101096</a>	320 330 FR
022	A153024	<a href="#">153024</a>	10 Split
023	A150216	<a href="#">W10146759</a>	10-32 X 3
024	A154279	<a href="#">154279</a>	5 16-18 X
025	A800917	<a href="#">800917</a>	320 330 MO
"	A803918	<a href="#">803918</a>	320 330 1
026	A153001	<a href="#">153001</a>	5 16 Flat
027	A153002	<a href="#">8182939</a>	Washer, Lock
028	A152004	<a href="#">8182933</a>	Nut, Hex
029	A137030	<a href="#">137030</a>	8 Pin Cmnl
030	A122701	<a href="#">122701</a>	MNL Socket
"	A122801	<a href="#">W10146716</a>	Mate-N-Loc
031	A116010	<a href="#">W10146668</a>	3 X 3 Fe
032	A150501	<a href="#">150501</a>	5 16-18 X
033	A153002	<a href="#">8182939</a>	Washer, Lock
034	A153001	<a href="#">153001</a>	5 16 Flat
035	A100173	<a href="#">W10146593</a>	12 Rib 95
036	A117604	<a href="#">117604</a>	1 8 Thk X
037	A153054	<a href="#">153054</a>	Ad320 330
038	A100705	<a href="#">100705</a>	3 16 X 3
039	A802831	<a href="#">802831</a>	12 1 2 Ri
040	A153051	<a href="#">W10146768</a>	3 4 Flat
041	A153040	<a href="#">153040</a>	3 4 Stand
042	A152025	<a href="#">152025</a>	3 4-16 Rig
043	A153525	<a href="#">153525</a>	1 4-20 X 1
044	A850132	<a href="#">850132</a>	320 330 be
"	A852104	<a href="#">852104</a>	320 330 be
045	A880885	<a href="#">W10148076</a>	320 330 63
046	A116011	<a href="#">W10146669</a>	3 1 2 X 2
047	A153007	<a href="#">153007</a>	1 4 Split
048	A152002	<a href="#">152002</a>	1 4-20 Hex
049	A880225	<a href="#">W10147982</a>	1 2 2 Bolt
050	A152014	<a href="#">152014</a>	1 4-20 Ser
051	A314423	<a href="#">314423</a>	Ad-320 330
052	<a href="#">A154277</a>		5/16 X 3/8" Shoulder Bolt

*the laundry company*<sup>®</sup>