

Maytag MLG32PDAWW 13 - GAS VALVE ASSEMBLY (PRIOR TO YW SERIALNo.)

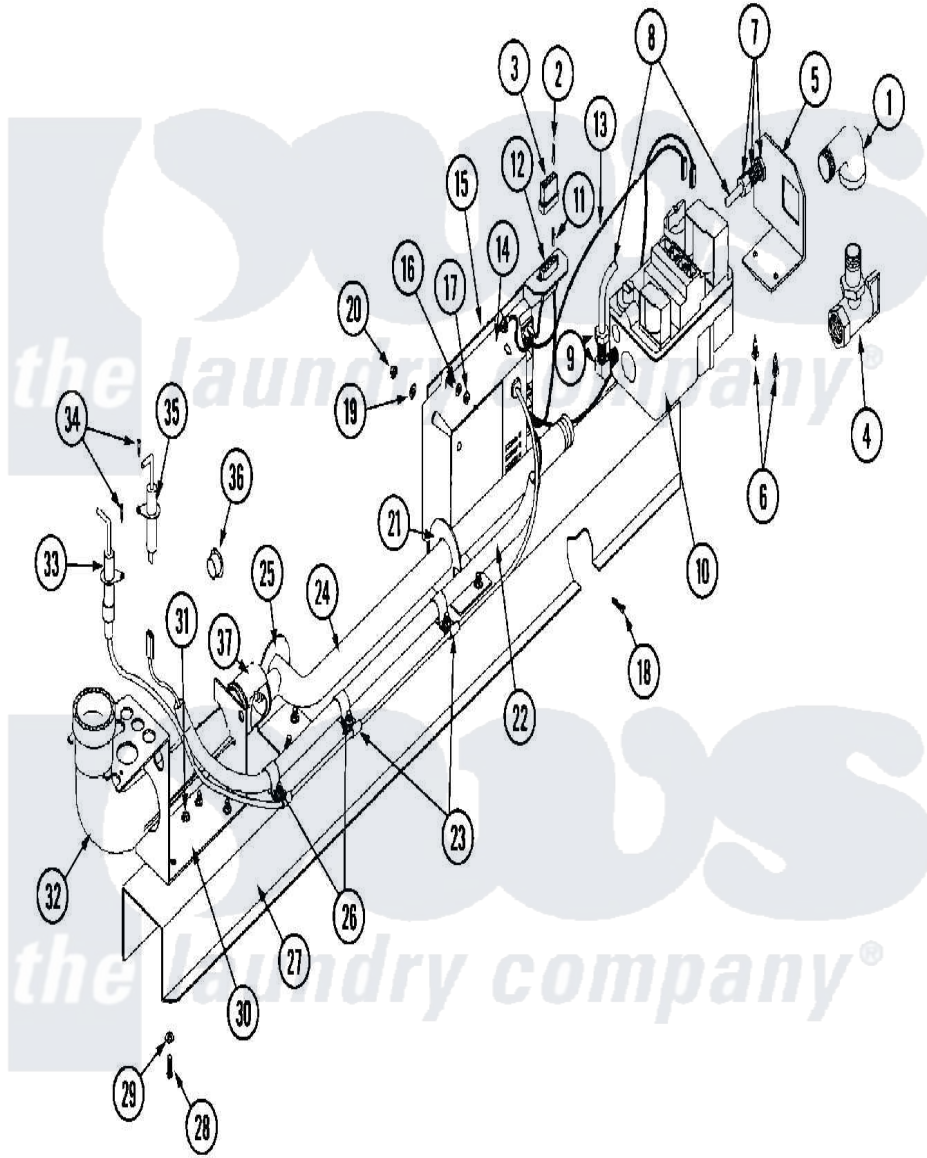

Maytag [Commercial Maytag MLG32PDAWW Dryer Parts](#) Parts Diagram 13 - GAS VALVE ASSEMBLY (PRIOR TO YW SERIALNo.)

[Click on the part number to view part](#)

| Item | Original Part Number | Replaced By | Status | Part Description |
|------|----------------------|---------------------------|---------------|--|
| 000 | W10124350 | | Not Available | ORDER PARTS FROM AMERICAN DRYER CORP AT 508-678-9000 |
| 001 | A142506 | 142506 | | 1 2 X 1 2 |
| 002 | A122700 | 122700 | | MNL Pin S |
| 003 | A122604 | W10146714 | | 4 Pin Cmnl |
| 004 | A881367 | W10148314 | | 1 2 Un |
| 005 | A318712 | 318712 | | 320 330 43 |
| 006 | A150301 | 150301 | | 8-18 X 7 |
| 007 | A143259 | 143259 | | Bulkhd Fit |
| 008 | A143100 | | Not Available | TUBING, ALUMINUM (1/4") |
| 009 | A143203 | 143203 | | Pnp Pilot |
| 010 | A128927 | | Not Available | VALVE, GAS (REDUNDANT) (1/2" 24 VAC, NATURAL GAS) |
| " | A140411 | | Not Available | CONVERSION KIT (1/2" 24 VAC GAS VALVE (L.P.) W/O |

| | | | ORIFICES |
|-----|-------------------------|---------------------------|------------------------------|
| 011 | A122701 | 122701 | MNL Socket |
| 012 | A122605 | 122605 | 4 Pin CmnI |
| 013 | A842716 | 842716 | 330 Gas TR |
| " | A842724 | 842724 | 330 Gas TR |
| 014 | A880815 | | MODULE, DSI (50HZ/60HZ) |
| 015 | A850808 | W10147723 | 330 430 Ds |
| 016 | A153017 | 153017 | 6 Sae Was |
| 017 | A151000 | WH12X195 | Switch Assembly |
| 018 | A153528 | 153528 | 8-32 X 1 2 |
| 019 | A153012 | 153012 | 8 Internal |
| 020 | A152001 | 152001 | 8-32 X 3 8 |
| 021 | A318711 | 318711 | 320 330 43 |
| 022 | A121060 | 121060 | 5 8 Clear |
| 023 | A121492 | 121492 | 3 16 Plas |
| 024 | A141225 | 141225 | 19 7 16 S |
| 025 | A318700 | W10146865 | SM Burner |
| 026 | A121491 | | Not Available CLAMP (5/8") |
| 027 | A319522 | 319522 | 330 430 GA |
| 028 | A153528 | 153528 | 8-32 X 1 2 |
| 029 | A153012 | 153012 | 8 Internal |
| 030 | A318009 | W10146863 | 215 220 23 |
| 031 | A151001 | W10146764 | 8-32 Pal N |
| 032 | A141130 | 141130 | Up-Shot GA |
| " | A307122 | | V-Bracket |
| 033 | A128917 | | Not Available IGNITER W/LEAD |
| 034 | A150315 | 150315 | 6 X 3 8 P |
| 035 | A128918 | | Not Available SENSOR, FLAME |
| 036 | A121300 | W10149174 | Open Close |
| 037 | A140810 | 140810 | Burner Ori |
| " | A140856 | 140856 | Burner Ori |
| " | A881936 | W10148530 | Ad-435 L.p |

