

Admiral ADE26K3A 02 - CYLINDER & DRIVE (REV. A-C)

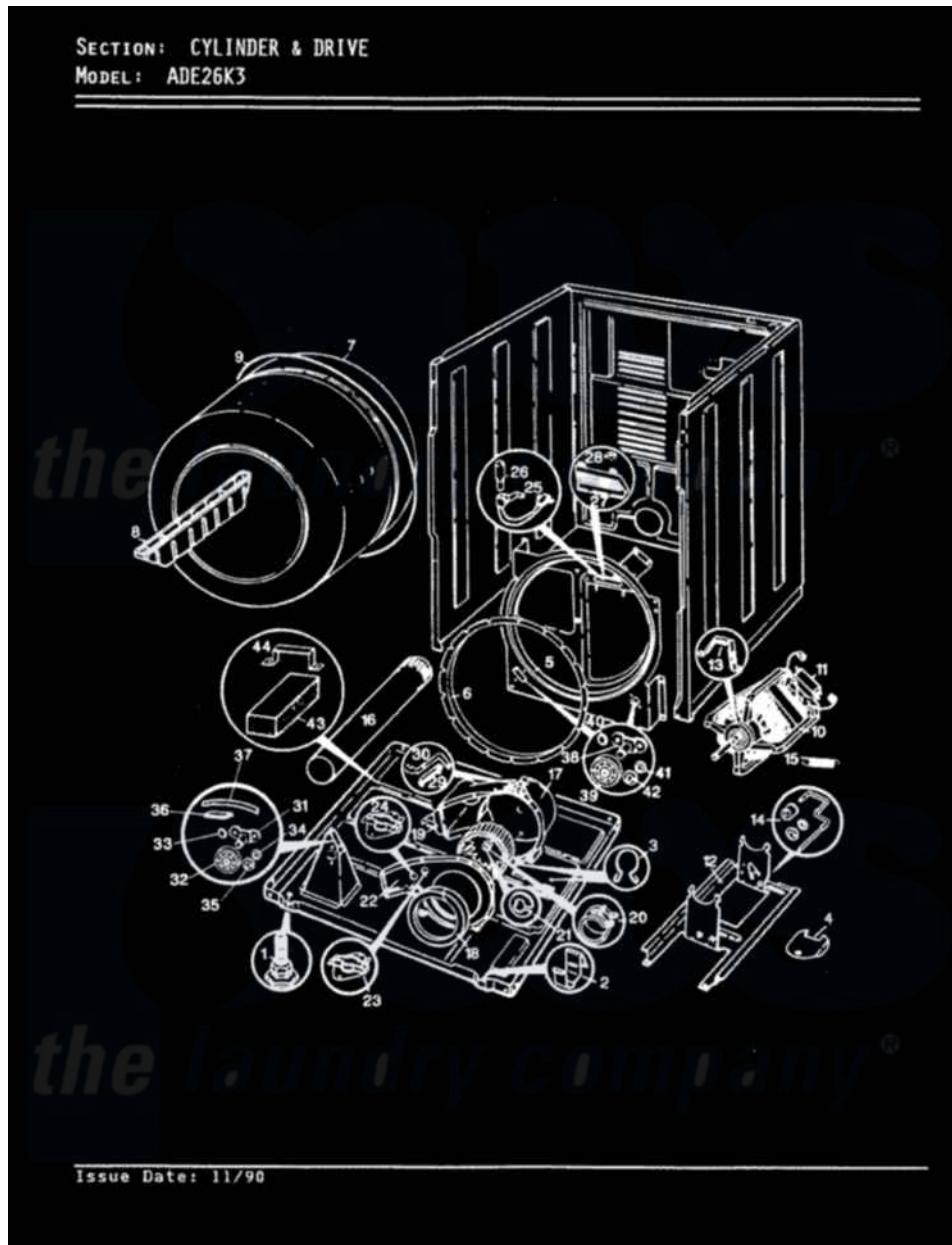

Admiral Residential Admiral ADE26K3A Dryer Parts Parts Diagram 02 - CYLINDER & DRIVE (REV. A-C)
 Click on the part number to view part

Item	Original Part Number	Replaced By	Status	Part Description
1	63-5519		Not Available	LEG, LEVELING
2	53-0120			Clip, Front Panel
3	25-7027	16515		Clip
4	25-7741	W10116760		Screw
"	53-0153		Not Available	SHIELD, WIRING
5	25-7733	681414		Screw, 10AB X 1/2
"	53-1708	LA-1054		Dryer Bulkhead Kit
6	53-0282	31001637		Seal Assembly, Cylinder Front
7	53-1250			Cylinder
8	25-7759	3196164		Screw
"	Y02100002		Not Available	BAFFLE (WHT)
9	53-1080	341241		Belt
10	53-2276		Not Available	MOTOR & PULLEY ASSY (230V,60HZ)
"	53-1042			Motor Assembly 230V/60Hz
11	53-0693	53-0332		Motor Switch
12	53-0105		Not Available	BRACKET

"	53-1932	31001570	Bracket, Motor
"	25-7811		Not Available SCREW
13	53-0214	660658	Clamp, Motor Mounting 343481 685441
"	25-7674		Screw
14	53-0199	53-2366	Idler Arm
"	25-7957		Pushnut
"	25-7815		Washer
"	53-2250	53-2287	Idler Assembly
"	53-2287		Idler Assembly
"	53-1628	31001344	Pulley, Idler
15	53-2209	31001465	Spring, Idler
"	53-0207		Not Available IDLER SPRING
16	53-0134		Duct, Exhaust
"	25-2134	W10116760	Screw
17	53-1801		Housing, Blower
"	53-0774		Not Available BLOWER HOUSING
18	53-0203	12001324	Duct Kit, Collector
19	53-0106		Blower Wheel
20	25-7823	312967	Clamp, Blower Housing
21	25-7812	25-7855	Ring, Retaining
22	53-1024		Not Available BLOWER COVER
"	25-3457		Screw, Sems
"	53-1933		Not Available COVER, BLOWER HOUSING
"	25-7807	33002917	Screw, No.10-16
"	53-1026		Guide, Vane Inlet
23	53-1107		Thermostat, Control
24	53-0170		Not Available THERMOSTAT, LO-LIMIT (120/110)
"	25-2134	W10116760	Screw
25	W10124350		Not Available NOT REQUIRED PART OR SEE NOTE NOT REQUIRED
26	W10124350		Not Available NOT REQUIRED PART OR SEE NOTE NOT REQUIRED
27	W10124350		Not Available NOT REQUIRED PART OR SEE NOTE NOT REQUIRED
28	25-3562	3195558	Nut
29	53-0182	31001356	Pad, Glide
30	53-0183	31001469	Glide, Tumbler
"	LA-1007	12002126	Reinforcement Brace/Glide Kit
"	LA-1006		Glide Kit, Tumbler
31	53-0198		Support Assembly
"	25-7101	3351614	Screw, Gearcase Cover Mounting
32	53-0665	12002126	Reinforcement Brace/Glide Kit
33	25-7813		Spacer
34	25-7814		Washer
35	25-7574	25-7854	Ring, Retaining
36	53-0184	31001356	Pad, Glide
37	LA-1008		Rr Roller Kit
"	53-0185	31001470	Glide, Tumbler
38	53-0197		Support Assembly-Cylinder Rear
"	25-7101	3351614	Screw, Gearcase Cover Mounting

39 53-0163

[31001096](#)

Roller

40 [25-7813](#)

Spacer

41 [25-7814](#)

Washer

42 25-7574

[25-7854](#)

Ring, Retaining

