

# Admiral ADE26K3W 02 - CYLINDER & DRIVE (REV. A-C)

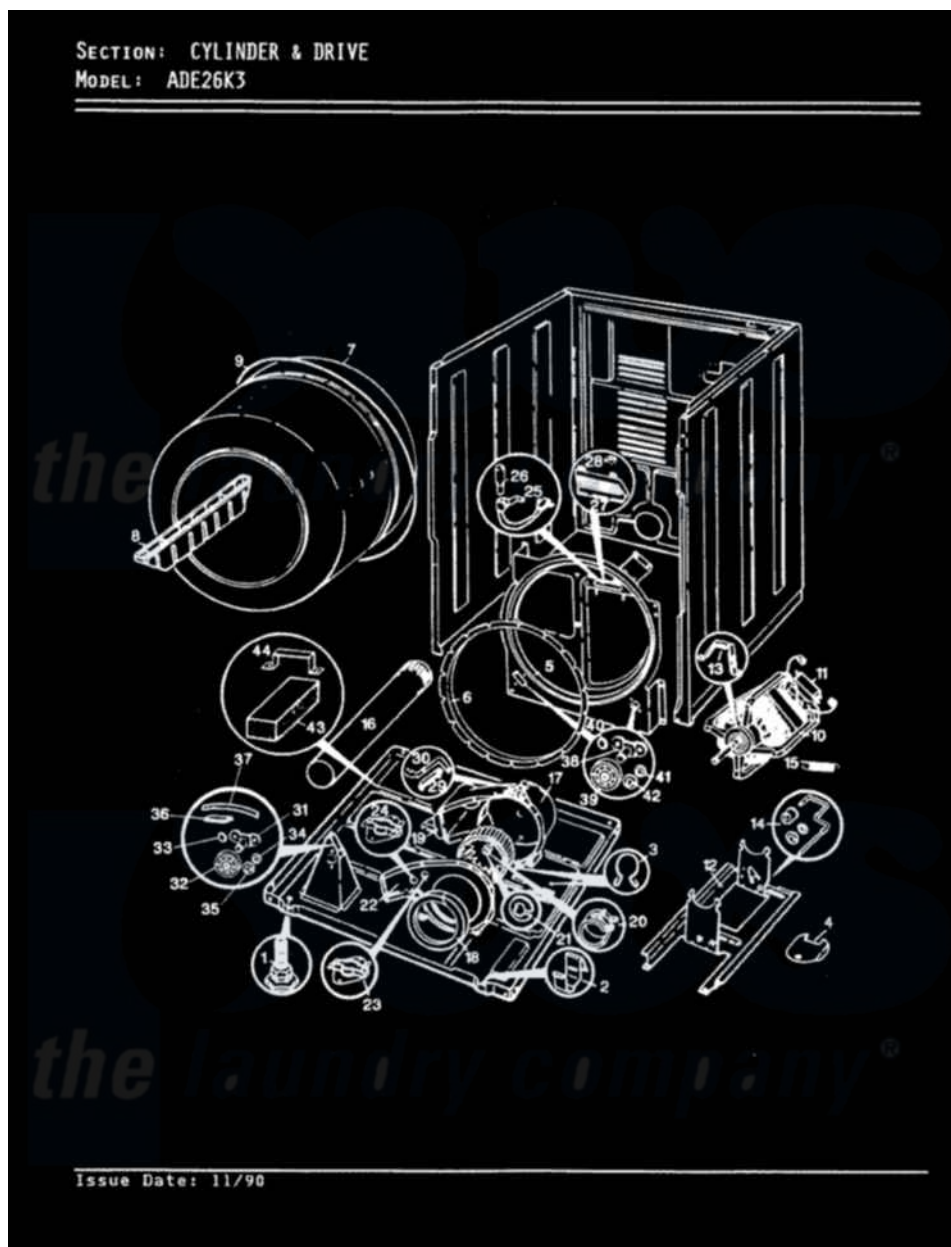

Admiral Residential Admiral ADE26K3W Dryer Parts Parts Diagram 02 - CYLINDER & DRIVE (REV. A-C)  
 Click on the part number to view part

Item	Original Part Number	Replaced By	Status	Part Description
1	63-5519		Not Available	LEG, LEVELING
2	<a href="#">53-0120</a>			Clip, Front Panel
3	25-7027	<a href="#">16515</a>		Clip
4	25-7741	<a href="#">W10116760</a>		Screw
"	53-0153		Not Available	SHIELD, WIRING
5	25-7733	<a href="#">681414</a>		Screw, 10AB X 1/2
"	53-1708	<a href="#">LA-1054</a>		Dryer Bulkhead Kit
6	53-0282	<a href="#">31001637</a>		Seal Assembly, Cylinder Front
7	<a href="#">53-1250</a>			Cylinder
8	25-7759	<a href="#">3196164</a>		Screw
"	Y02100002		Not Available	BAFFLE (WHT)
9	53-1080	<a href="#">341241</a>		Belt
10	53-2276		Not Available	MOTOR & PULLEY ASSY (230V,60HZ)
"	<a href="#">53-1042</a>			Motor Assembly 230V/60Hz
11	53-0693	<a href="#">53-0332</a>		Motor Switch
12	53-0105		Not Available	BRACKET

"	53-1932	<a href="#">31001570</a>	Bracket, Motor
"	25-7811		Not Available SCREW
13	53-0214	<a href="#">660658</a>	Clamp, Motor Mounting 343481 685441
"	<a href="#">25-7674</a>		Screw
14	53-0199	<a href="#">53-2366</a>	Idler Arm
"	<a href="#">25-7957</a>		Pushnut
"	<a href="#">25-7815</a>		Washer
"	53-2250	<a href="#">53-2287</a>	Idler Assembly
"	<a href="#">53-2287</a>		Idler Assembly
"	53-1628	<a href="#">31001344</a>	Pulley, Idler
15	53-2209	<a href="#">31001465</a>	Spring, Idler
"	53-0207		Not Available IDLER SPRING
16	<a href="#">53-0134</a>		Duct, Exhaust
"	25-2134	<a href="#">W10116760</a>	Screw
17	<a href="#">53-1801</a>		Housing, Blower
"	53-0774		Not Available BLOWER HOUSING
18	53-0203	<a href="#">12001324</a>	Duct Kit, Collector
19	<a href="#">53-0106</a>		Blower Wheel
20	25-7823	<a href="#">312967</a>	Clamp, Blower Housing
21	25-7812	<a href="#">25-7855</a>	Ring, Retaining
22	53-1024		Not Available BLOWER COVER
"	<a href="#">25-3457</a>		Screw, Sems
"	53-1933		Not Available COVER, BLOWER HOUSING
"	25-7807	<a href="#">33002917</a>	Screw, No.10-16
"	<a href="#">53-1026</a>		Guide, Vane Inlet
23	<a href="#">53-1107</a>		Thermostat, Control
24	53-0170		Not Available THERMOSTAT, LO-LIMIT (120/110)
"	25-2134	<a href="#">W10116760</a>	Screw
25	W10124350		Not Available NOT REQUIRED PART OR SEE NOTE NOT REQUIRED
26	W10124350		Not Available NOT REQUIRED PART OR SEE NOTE NOT REQUIRED
27	W10124350		Not Available NOT REQUIRED PART OR SEE NOTE NOT REQUIRED
28	25-3562	<a href="#">3195558</a>	Nut
29	53-0182	<a href="#">31001356</a>	Pad, Glide
30	53-0183	<a href="#">31001469</a>	Glide, Tumbler
"	LA-1007	<a href="#">12002126</a>	Reinforcement Brace/Glide Kit
"	<a href="#">LA-1006</a>		Glide Kit, Tumbler
31	<a href="#">53-0198</a>		Support Assembly
"	25-7101	<a href="#">3351614</a>	Screw, Gearcase Cover Mounting
32	53-0665	<a href="#">12002126</a>	Reinforcement Brace/Glide Kit
33	<a href="#">25-7813</a>		Spacer
34	<a href="#">25-7814</a>		Washer
35	25-7574	<a href="#">25-7854</a>	Ring, Retaining
36	53-0184	<a href="#">31001356</a>	Pad, Glide
37	<a href="#">LA-1008</a>		Rr Roller Kit
"	53-0185	<a href="#">31001470</a>	Glide, Tumbler
38	<a href="#">53-0197</a>		Support Assembly-Cylinder Rear
"	25-7101	<a href="#">3351614</a>	Screw, Gearcase Cover Mounting

39 53-0163

[31001096](#)

Roller

40 [25-7813](#)

Spacer

41 [25-7814](#)

Washer

42 25-7574

[25-7854](#)

Ring, Retaining

