

Admiral DE25D6AM 04 - ELECTRICAL

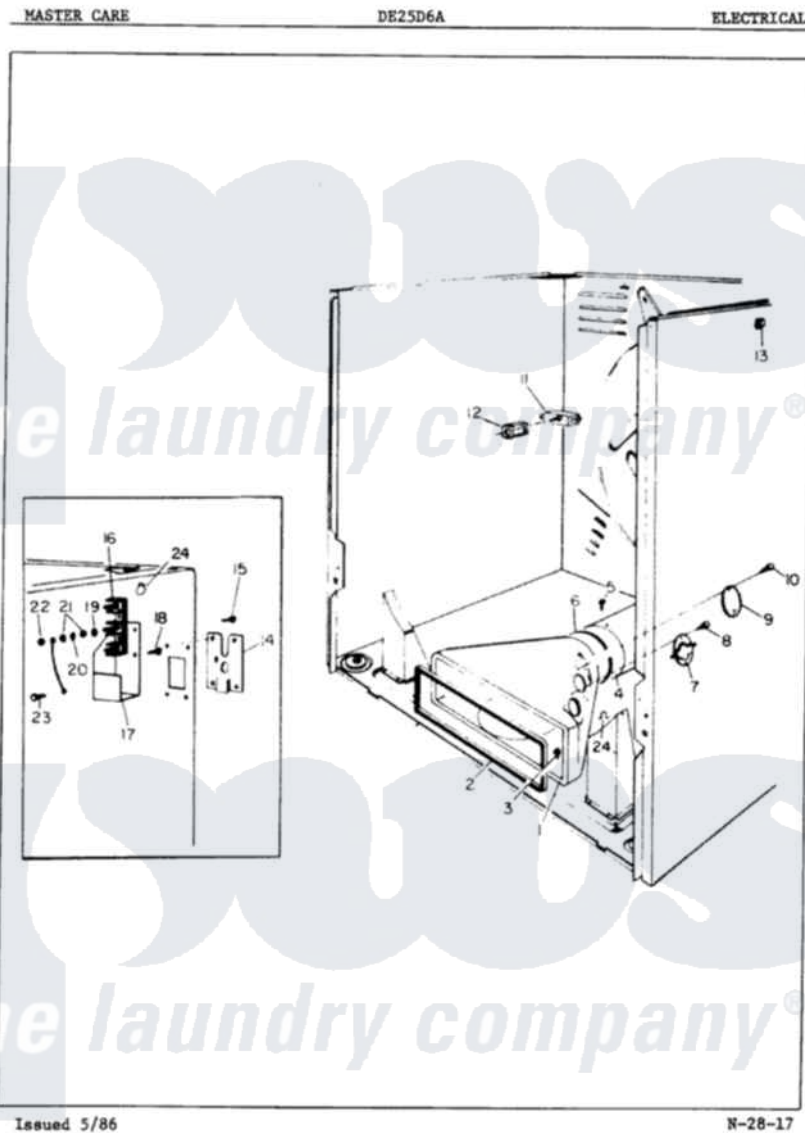

Admiral Residential Admiral DE25D6AM Dryer Parts Parts Diagram 04 - ELECTRICAL
 Click on the part number to view part

| Item | Original Part Number | Replaced By | Status | Part Description |
|------|----------------------|-------------------------|---------------|--|
| 1 | 63-5114 | | Not Available | TRANSITION DUCT |
| 2 | 63-2599 | | Not Available | DUCT GASKET |
| 3 | W10124350 | | Not Available | NOT REQUIRED PART OR SEE NOTE SCREW-PURCHASED LOCALLY |
| 4 | 63-5848 | | Not Available | VENT DUCT |
| 5 | W10124350 | | Not Available | NOT REQUIRED PART OR SEE NOTE SCREW-PURCHASED LOCALLY |
| 6 | W10124350 | | Not Available | NOT REQUIRED PART OR SEE NOTE SEALING TAPE (PURCHASED LOCALLY) |
| 7 | 63-6142 | | Not Available | THERMOSTAT |
| 8 | W10124350 | | Not Available | NOT REQUIRED PART OR SEE NOTE SCREW-PURCHASED LOCALLY |
| 9 | 63-1216N | | Not Available | COVER PLATE |
| 10 | 63-2837N | LA-1005 | | Switch Kit |
| " | W10124350 | | Not Available | NOT REQUIRED PART OR SEE NOTE SCREW- |

PURCHASED LOCALLY

| | | | |
|----|--------------------------|--------------------------|---|
| 11 | 63-5991 | LA-1005 | Switch Kit |
| 12 | 63-5990 | 31001319 | Clip, Switch |
| 13 | 25-3034 | | Clip, Wiring |
| 14 | 63-1195 | Not Available | SUPPORT |
| 15 | 63-2836N | | Trmnl Block Kit |
| " | 25-3092 | 90767 | Screw, 8A X 3/8 HeX Washer Head Tapping |
| 16 | 63-1244 | 53-1518 | Block, Terminal |
| 17 | 63-5805 | Not Available | SHIELD |
| 18 | 25-9103 | Not Available | SCREW |
| 19 | 25-3122 | | Washer, Flat |
| 20 | 25-3123 | Not Available | WASHER, CUP |
| 21 | 25-0027 | 112432 | Nut |
| 22 | 25-6124 | Not Available | NUT |
| 23 | 25-3461 | 3400094 | Screw, 10-32 X 3/8 |
| 24 | 25-7027 | 16515 | Clip |

